

Application for a Permit Amendment in the Name of City of Amity Proposed Additional Point of Diversion Map

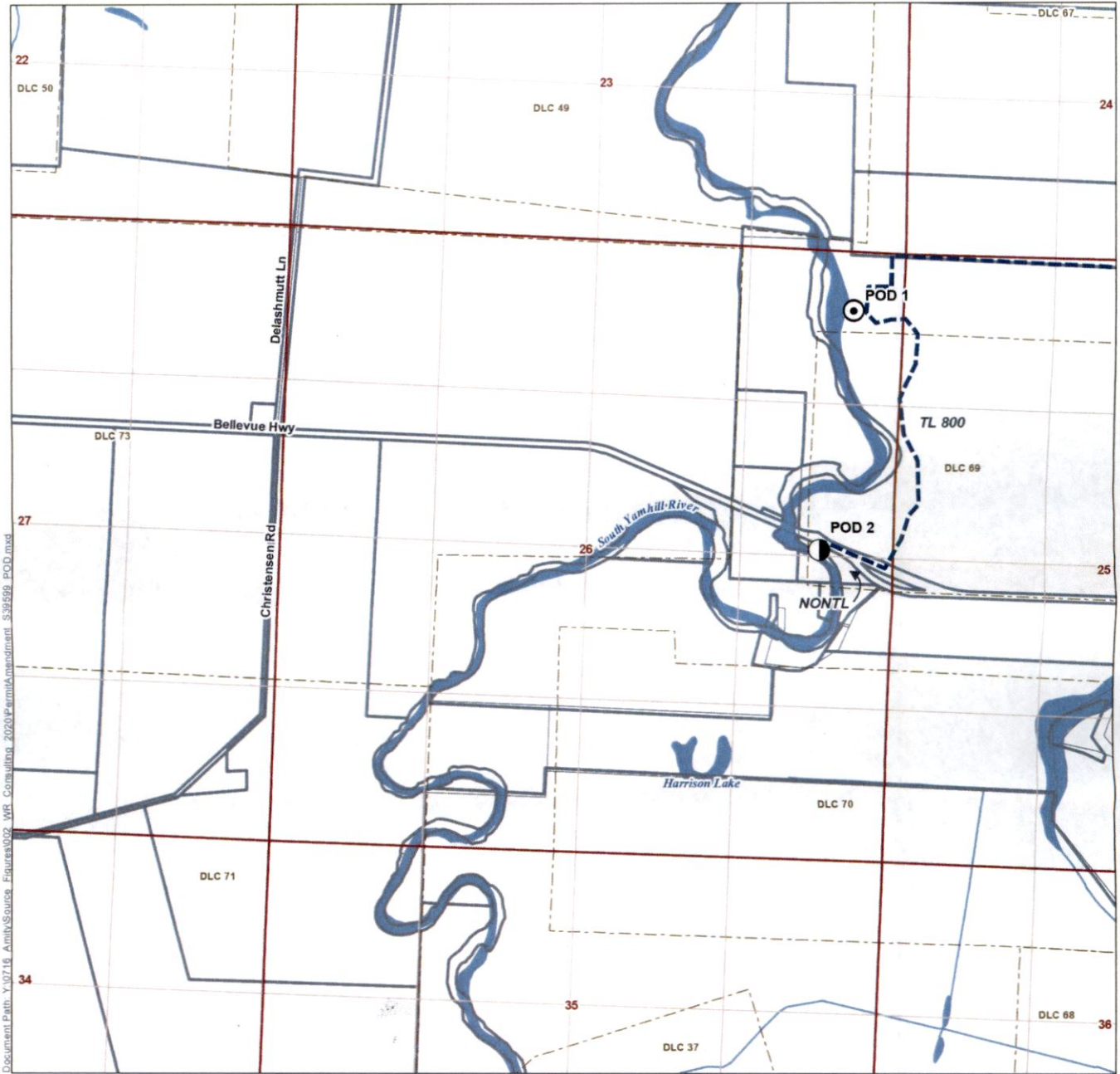



Permit S-39599
Yamhill County

Township 5 South, Range 5 West (W.M.)



Document Path: Y:\0716_Amity\Source_E\Figures\002_MR_Consulting_2020\PermitAmendment_S39599_POD.mxd

LEGEND

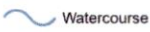
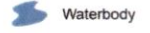
-  Authorized POD
-  Proposed APOD
-  Pipeline
-  Tax Lot
-  Donation Land Claim (DLC)
-  Watercourse
-  Waterbody

DISCLAIMER

This map was prepared for the purpose of identifying the location of a water right only and it is not intended to provide legal dimensions or location of property ownership lines.

MAP NOTES

Date: February 10, 2021
Data Sources: BLM, OWRD, ESRI, Yamhill CO., USGS

POD LOCATION DESCRIPTION

- POD 1**
Located 515 feet South and 425 feet West from the NE corner of Section 26, Township 5 South, Range 5 West (W.M.)
- POD 2**
Located 2,560 feet South and 650 feet West from the NE corner of Section 26, Township 5 South, Range 5 West (W.M.)

RECEIVED

APR 26 2021

OWRD

13685 -

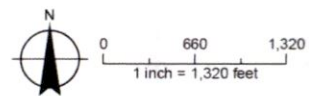

**Application for a Permit Amendment
in the Name of City of Amity
Existing Place of Use Map**

Permit S-39599
Yamhill County

Township 5 South, Range 4 & 5 West (W.M.)

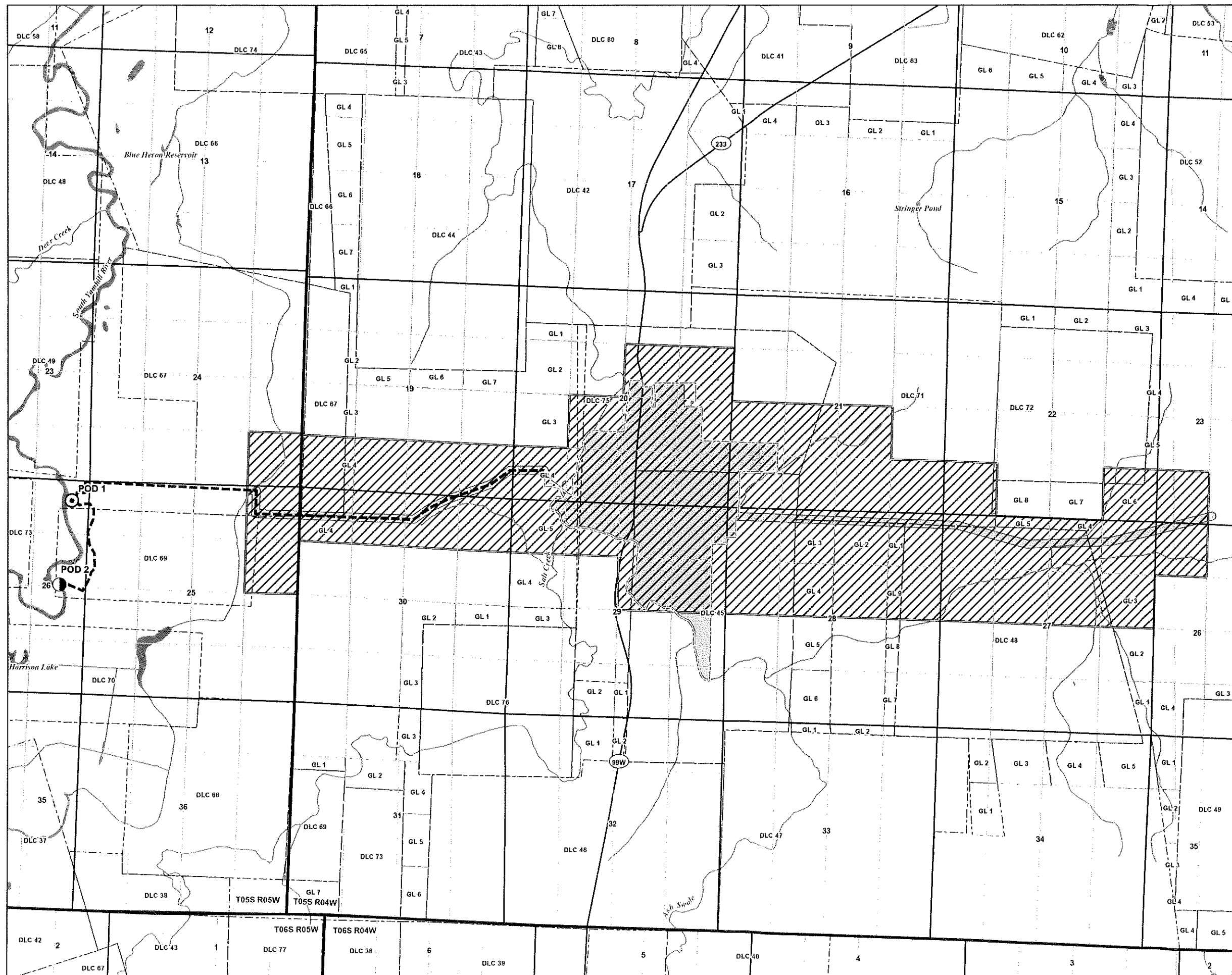

LEGEND

- ⊙ Authorized POD
- Proposed APOD
- Pipeline
- ▨ Place of Use (POU)
- - - Donation Land Claim (DLC)
- Government Lot (GL)
- ⊕ City of Amity
- City of Amity Service Area
- Major Road
- ~ Watercourse
- ◐ Waterbody

RECEIVED

APR 26 2021

OWRD

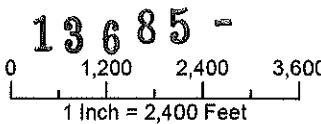

Date: April 1, 2021
Data Sources: Data Sources: BLM, OWRD, ESRI,
Yamhill CO., USGS

