

LEGEND

- H.L. HAND LINE
- W.L.(NO.) WHEEL LINE AND REFERENCE NUMBER
- U.G. UNDER GROUND
- A.G. ABOVE GROUND
- P(NO.) PIVOT AND REFERENCE NUMBER
- EXISTING CROP LINE
- EXISTING FENCE
- IN PLACE TRANSMISSION LINE UNLESS SHOWN OTHERWISE
- LAND SURVEY MONUMENT
- POINT OF DIVERSION AS SHOWN
- TAX LOT ID NUMBER
- TAX LOT BOUNDARY LINE

I NO. T-6854 AND PERMIT G-13362
 Located in Sections 4, 8, 9, 17, 18, 19, and 20,
 Township 14 South, Range 12 East, Willamette Meridian
 Deschutes County, Oregon

- NOTES**
- This map was prepared for the purpose of identifying the location of water rights only and is not intended to provide legal dimensions or locations of property ownership lines.
 - This map is based on the Final Proof map originally submitted by Anderson Engineering, Sept. 14, 2001.
 - Tax lot lines are based on Deschutes County Assessor Maps dated Feb. 2, 2010.

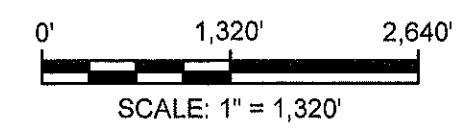

McKenzie Canyon Point of Diversion (POD)
 With Pump and Meter (not installed)
 1,610.6 Feet West and 1,592.5 Feet North
 From the SE Corner of Section 4.

WELL 7 WITH PUMP AND METER (not installed)
 LOCATED: 2862.6 FT WEST AND
 1571.4 FT SOUTH FROM THE NE CORNER OF
 SECTION 9.

WELL 4 WITH PUMP AND METER
 LOCATED: 32.2 FT EAST AND
 240.7 FT SOUTH FROM THE NW
 CORNER OF SECTION 17.

WELL 1 WITH PUMP AND METER
 LOCATED: 1680.6 FT WEST AND
 1154.2 FT NORTH FROM THE SE
 CORNER OF SECTION 18.

WELL 3 WITH PUMP AND METER
 LOCATED: 1706.6 FT WEST AND
 1772.1 FT SOUTH FROM THE NE
 CORNER OF SECTION 17.

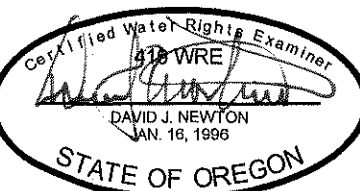

EXPIRES:
 RENEWS:

RECEIVED
 JUN 23 2021
 OWRD

Deep Canyon Point of Diversion (POD)
 4,440 Feet South and 3,020 Feet East from
 the NW Corner of Section 9.

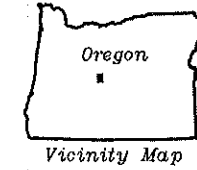

Surface Water POD to Groundwater POA Transfer Water
 C-76372- Delivery System Map
 Certificate 76372 - Deschutes Valley Farm, Inc.
 Deschutes County, Oregon

DESIGNED BY:	D. Newton
DRAWN BY:	S. Schenck
DATE:	MAY 2021
PROJECT NO.:	556-103
FIGURE	2

H.A.M. COY
 ENGINEERING & SURVEYING, LLC
 1180 SW Lake Road, Suite 201 Redmond, OR 97756
 PE, PLS, CWRE
 Hayes, McCoy
 541-923-7554
 hayes@ham-engr.com

G:\0500\556\103\Cad\Water_W556103_F1_C03U IrrSys 08.44 11/15/2016 SS

WATER RIGHT TRANSFER MAP

CHANGE IN POD TO POA

Located in Sections 3, 4, 8, 9, 17, 18, and 20,
Township 14 South, Range 12 East, Willamette Meridian
Deschutes County, Oregon

NOTES

1. This map was prepared for the purpose of identifying the location of water rights only and is not intended to provide legal dimensions or locations of property ownership lines.
2. This map is based on Claim of Beneficial Use Map submitted with the COBU prepared by Newton Consultants, Inc., May 2012.
3. Tax lot lines are based on Deschutes County Assessor Maps dated Feb. 2, 2010.
4. Acres irrigated are identified in each 1/4-1/4 by total acres and by Tax Lot.
5. Place of Use and Character of Use will not Change.

McKenzie Canyon Point of Diversion (POD)
With Pump 1,870 Feet North and 3,700 Feet
East from the SW Corner of Section 4.

**Locations Of Proposed
Point of Appropriation**

- POA 1 - Well #1
1680.6 Ft West and 1154.2 Ft
North from the SE Corner of
Section 18.
- POA 2 - Well #3
1706.6 Ft West and 1772.1 Ft
South from the NE Corner of
Section 17.
- POA 3 - Well #4
32.2 Ft East and 240.7 Ft
South from the NW Corner of
Section 17.
- POA 4 - Well #7
2862.6 Ft West and 1571.4 Ft
South from the NE Corner of
Section 9.

LEGEND

- Supplemental Certificate 76372,
Permit 37392 (149.8 Ac Total)
Irrigation: Oct 23, 1973
- Tax Lot Boundary Line
- Tax Lot ID Number
- Total Number of Acres Irrigated
in 1/4-1/4

RECEIVED

JUN 23 2021

OWRD

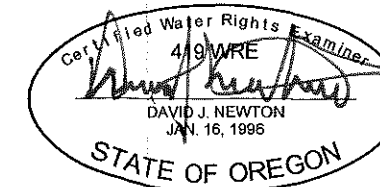
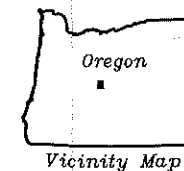

EXPIRES:
RENEWS:

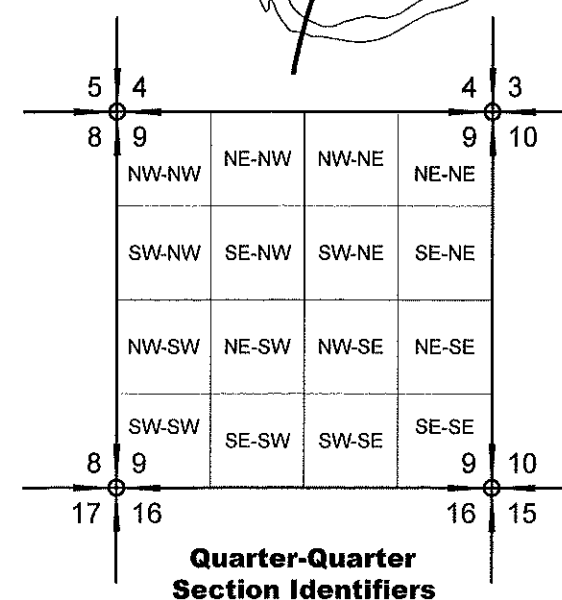
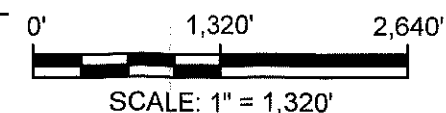

L:\data (newtonsr2)\0500\556\103\HMcCoy\556103_F2_COBU_TB8027_14:18_08/03/2018_SS

Surface Water POD to Groundwater POA Transfer Map
Certificate 76372 - Deschutes Valley Farm, Inc.
Deschutes County, Oregon

DESIGNED BY: **D. Newton** DRAWN BY: **S. Schenck** DATE: **MAY 2021** PROJECT NO: **556-103** FIGURE: **1**

**CLAIM OF BENEFICIAL USE
MAP G-13362**

Located in Sections 3, 4, 8, 9, 17, 18, and 20,
Township 14 South, Range 12 East, Willamette Meridian
Deschutes County, Oregon

NOTES

1. This map was prepared for the purpose of identifying the location of water rights only and is not intended to provide legal dimensions or locations of property ownership lines.
2. This map is based on Final Proof Map submitted with the COBU prepared by Anderson Engineering, Sept. 14, 2001.
3. Tax lot lines are based on Deschutes County Assessor Maps dated Feb. 2, 2010.
4. Authorized Points of Appropriation under Permit G-13362 are Wells #1, #3, #4, and #7.
5. Acres Irrigated are identified in each 1/4-1/4 by total acres and by Tax Lot.

COBU MAP # 680

13749

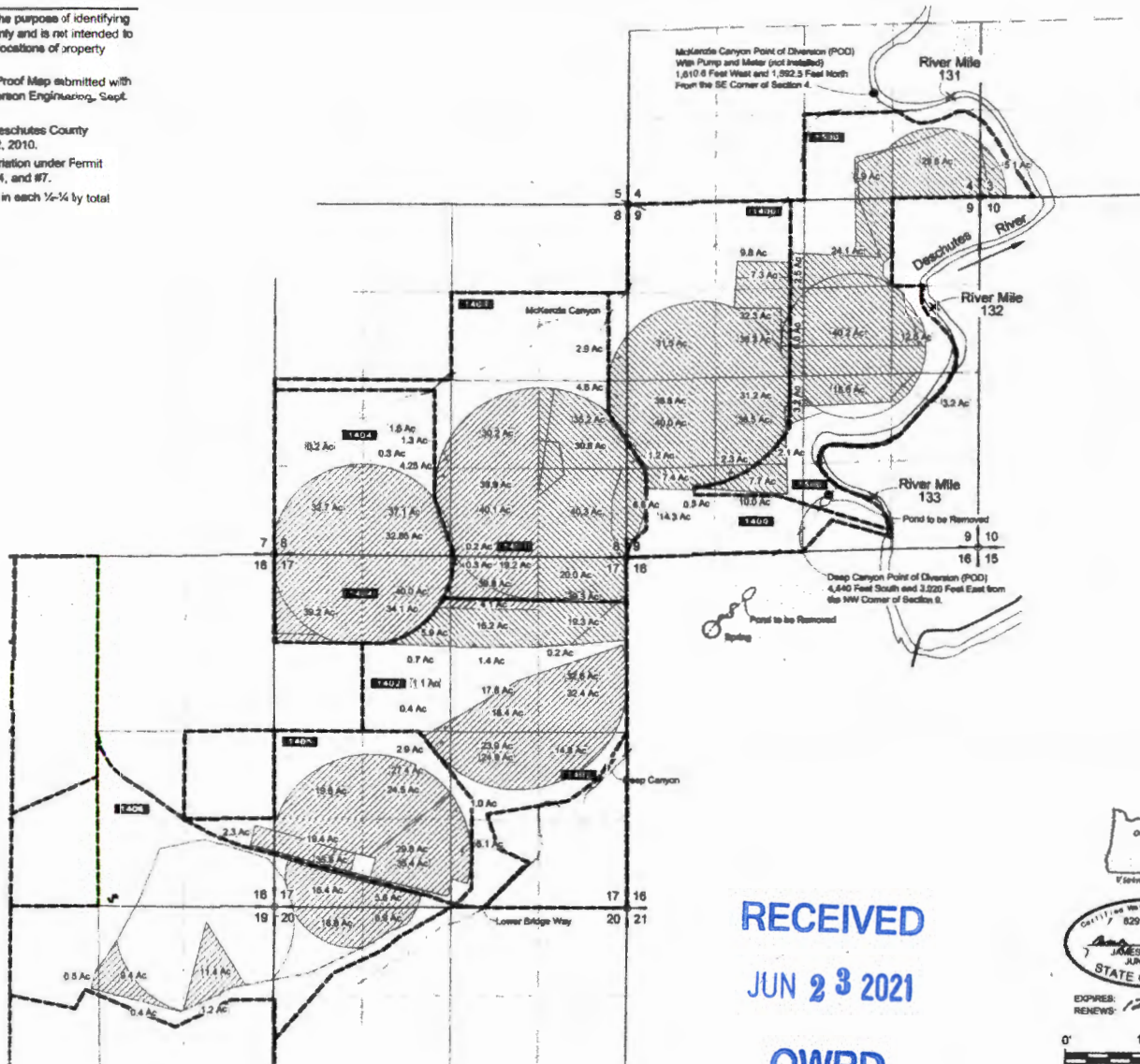

LEGEND

- Primary Certificate G-13362 (501.1 Ac Total)
- Supplemental Certificate G-13362 (484.8 Ac Total)
- Tax Lot Boundary Line
- Tax Lot ID Number
- Total Number of Acres Irrigated in N-X

RECEIVED

JUN 23 2021

OWRD

Oregon
Vicinity Map

02917
JAMES S. MARITON
JUNE 8, 2020
STATE OF OREGON

EXPIRES: 12-31-2022
RENEWS:

0' 1,320' 2,640'
SCALE: 1" = 1,320'

000671

5	4		4	3
8	9	NE-NW	NW-NE	NE-NE
		SW-NW	SE-NW	SW-NE
		NW-SW	NE-SW	NW-SE
		SW-SW	SE-SW	SW-SE
8	9		9	10
17	18		18	15

**Quarter-Quarter
Section Identifiers**

T.14S.R.12E.W.M.

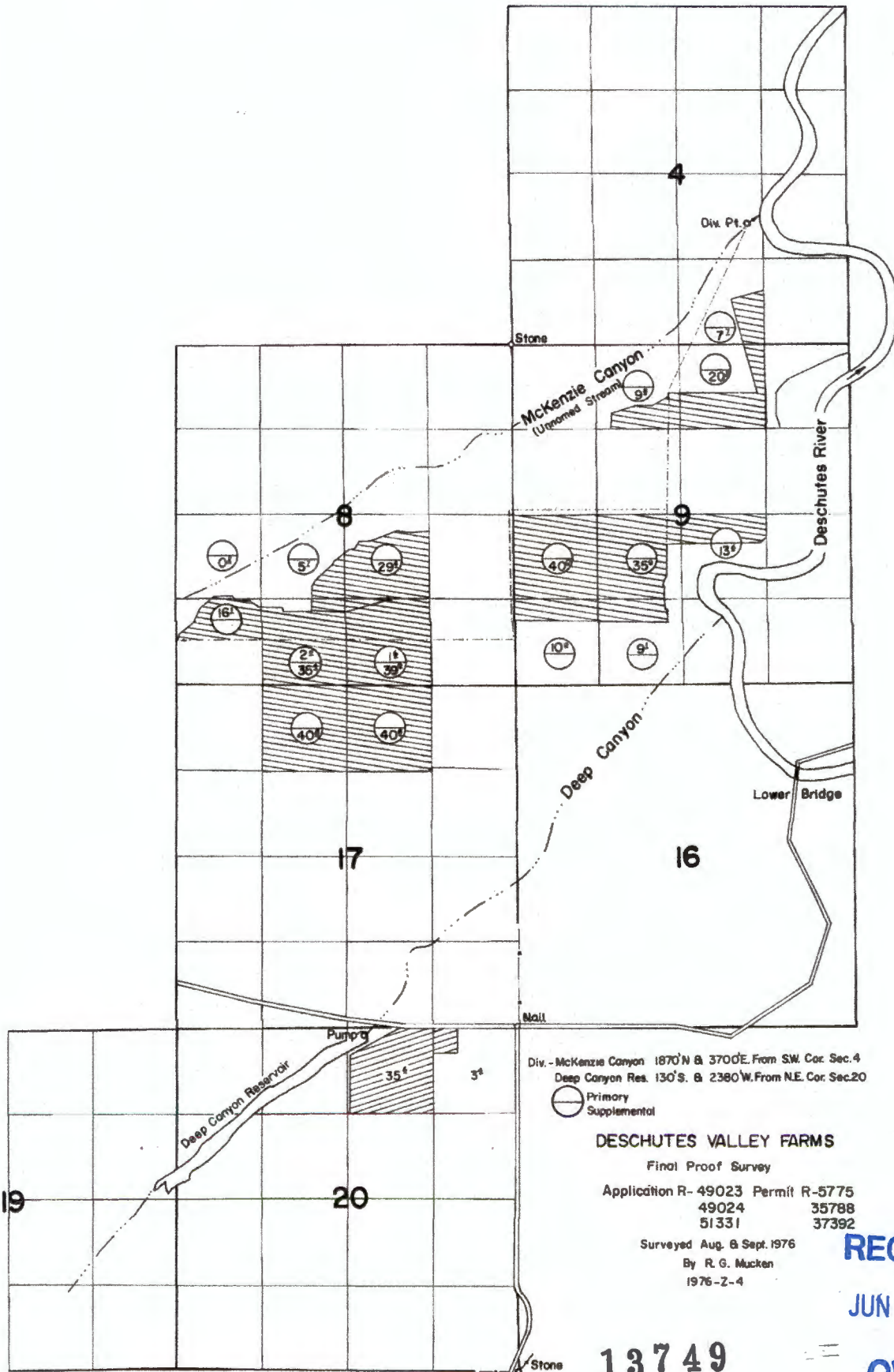

Div. - McKenzie Canyon 1870' N & 3700' E. From SW. Cor. Sec. 4
Deep Canyon Res. 130' S. & 2380' W. From N.E. Cor. Sec. 20

○ Primary
○ Supplemental

DESCHUTES VALLEY FARMS

Final Proof Survey

Application R- 49023 Permit R-5775
49024 35788
51331 37392

Surveyed Aug. & Sept. 1976
By R. G. Mucken
1976-2-4

RECEIVED

JUN 23 2021

OWRD

13749