







DESCHUTES COUNTY, OR  
RECEIVED T22S R10E, WM

JUL 06 2021

OWRD



0 400 Feet  
1" = 400'

RENEWAL DATE 12/31/2022

TL 01401 TL 01600 TL 01500 TL 00101 TL 00107 TL 00200  
TL 01400 TL 01600 TL 01500 TL 00101 TL 00107 TL 00200

TL 02803

RECEIVED

JUL 06 2021

OWRD

TL 02805

	20.0 ac. "OFF" Cert. 90239
	Cert. 90239 in SENW QQ
	Section
	Tax Lot
	Quarter Quarter

HWY 31

NWNE

TL 01900

TL 02803

TL 00104

TL 00104

TL 00100

20.0 AC. OFF

SENW

SWNE

TL 00100

36.7 AC. Total in QQ

34

### INSTREAM TRANSFER OFF MAP James & Jean Verheyden

This map is not intended to provide legal dimensions or locations of property ownership lines.

### WATER RIGHT SERVICES, LLC

PO BOX 1830, BEND, OR 97709

WWW.OREGONWATER.US 541-389-2837

johnshort@usa.com CCB # 197121

Date: 4/25/2021

C-90239



RENEWAL DATE 12/31/2022

4-26-21

- POD
- Canal
- River
- Place of Use
- Township
- Section

RECEIVED  
JUL 06 2021  
OWRD

T22S R10E, WM,  
DESCHUTES COUNTY, OR &  
T23S R10E & T23S R9E, WM  
KLAMATH COUNTY, OR



0 6,000 Feet W E

1" = 6000'

RECEIVED  
JUL 06 2021  
OWRD

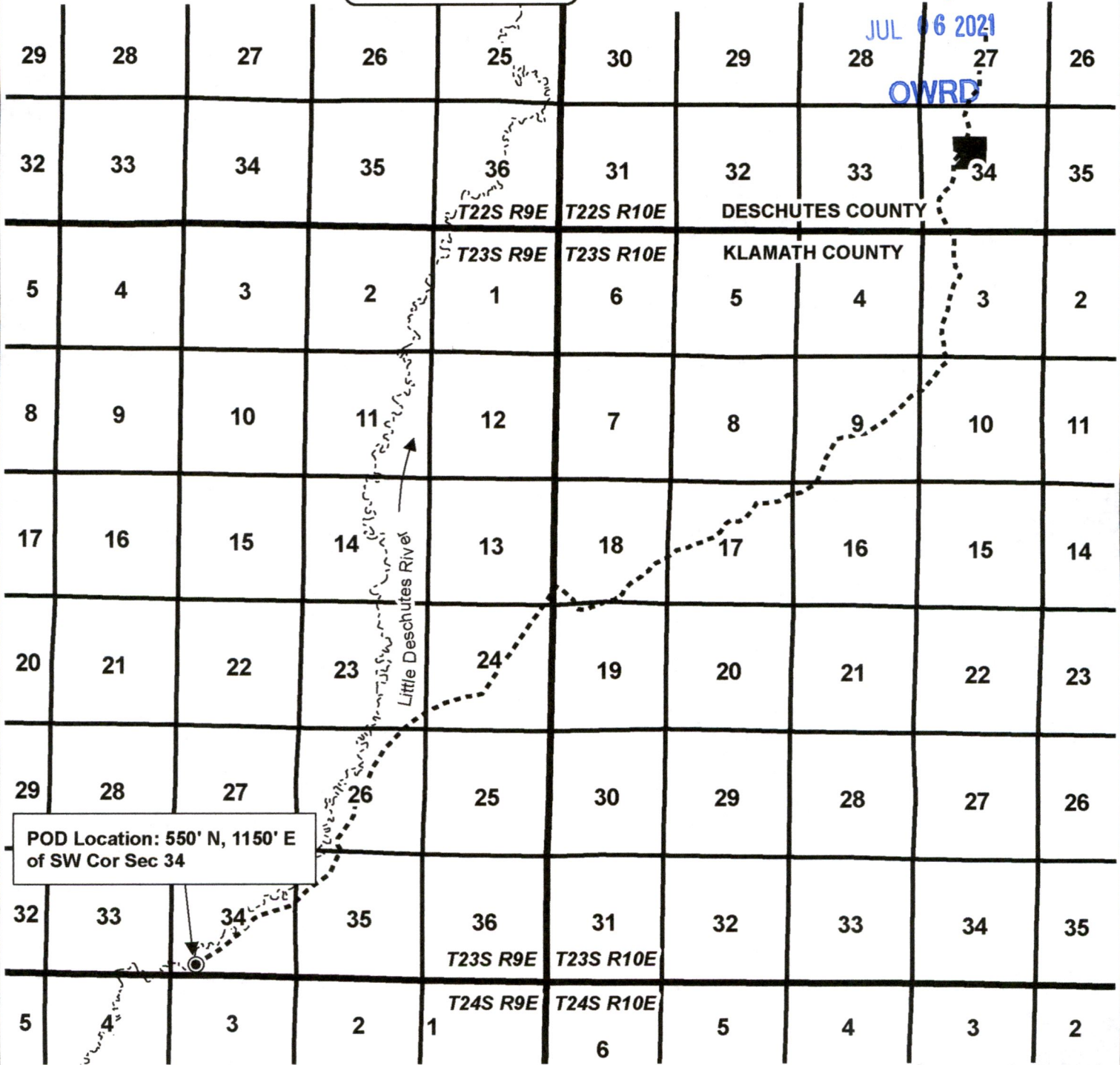

**INSTREAM TRANSFER OFF MAP**  
**James & Jean Verheyden**

This map is not intended to provide legal dimensions or locations of property ownership lines.

**WATER RIGHT SERVICES, LLC**  
PO BOX 1830, BEND, OR 97709  
[WWW.OREGONWATER.US](http://WWW.OREGONWATER.US) 541-389-2837  
johnshort@usa.com CCB # 197121

Date: 4/25/2021

C-90239