

LEGEND

- Authorized Point of Appropriation (POA)
- Proposed Point of Appropriation (POA)
- Place of Use (POU)**
- ▨ Remaining Lands
- ▧ From Lands
- ▩ To Lands
- Government Lot (GL)
- City Boundary
- Tax Lot
- Railroad
- Major Road
- ~ Watercourse
- Waterbody

CERTIFIED WATER RIGHTS EXAMINER STAMP

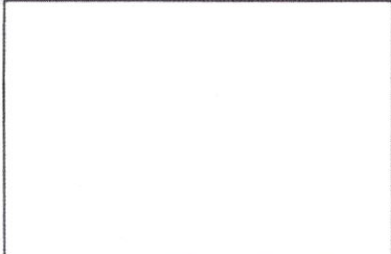

**Application for Permanent Water Right Transfer
in the Name of Amazon Data Services, Inc.
Certificate 53193
Umatilla County
Township 5 North, Range 28 East (W.M.)**

RECEIVED

JUL 08 2021

OWRD

LOCATION DESCRIPTION

Authorized POA
270 feet North and 60 feet West from the South 1/4 corner of Section 16, Township 5 North, Range 28 East (W.M.)
Proposed POA
2450 feet South and 845 feet East from the North 1/4 corner of Section 21, Township 5 North, Range 28 East (W.M.)

DISCLAIMER
This map was prepared for the purpose of identifying the location of a water right only and it is not intended to provide legal dimensions or location of property ownership lines.

Date: May 7, 2021
Data Sources: BLM, ESRI, OWRD, USGS

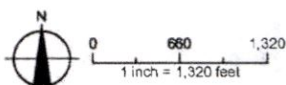

13777

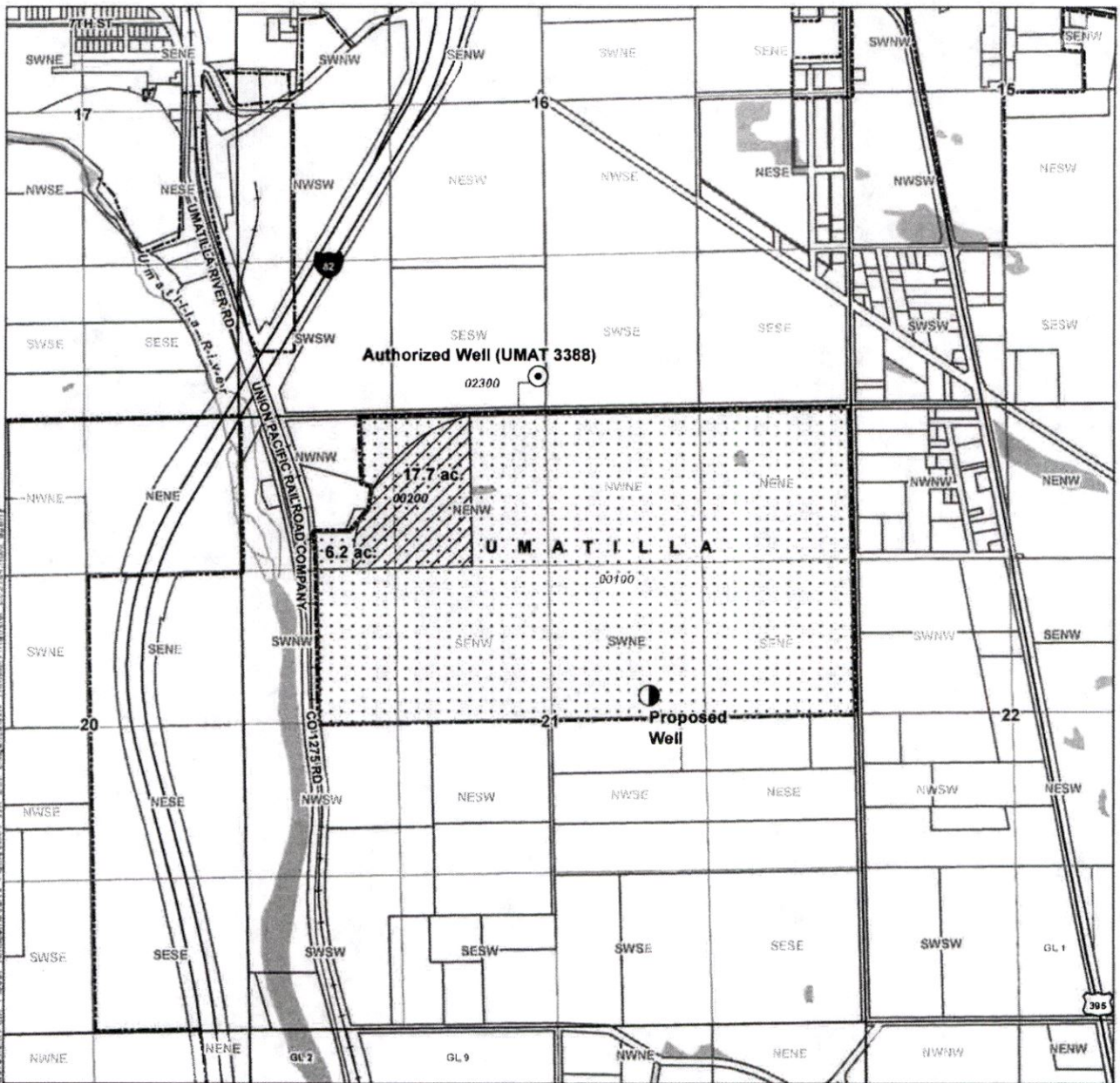

LEGEND

- ⊙ Authorized Point of Appropriation (POA)
- Proposed Point of Appropriation (POA)
- Place of Use (POU)**
- ▨ From lands
- ▤ To Lands
- Government Lot (GL)
- City Boundary
- Tax Lot
- Railroad
- Major Road
- ~ Watercourse
- ~ Waterbody

CERTIFIED WATER RIGHTS EXAMINER STAMP

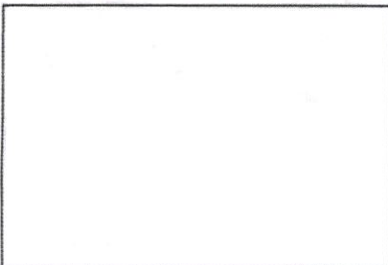

**Application for Permanent Water Right Transfer
in the Name of Amazon Data Services, Inc.**

Certificate 53194

Umatilla County

Township 5 North, Range 28 East (W.M.)

RECEIVED

JUL 08 2021

OWRD

LOCATION DESCRIPTION

Authorized POA
270 feet North and 80 feet West from the South 1/4 corner of Section 16, Township 5 North, Range 28 East (W.M.)

Proposed POA
2450 feet South and 845 feet East from the North 1/4 corner of Section 21, Township 5 North, Range 28 East (W.M.)

DISCLAIMER
This map was prepared for the purpose of identifying the location of a water right only and it is not intended to provide legal dimensions or location of property ownership lines.

Date: May 7, 2021
Data Sources: BLM, ESRI, OWRD, USGS

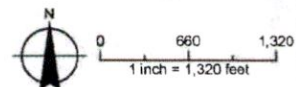

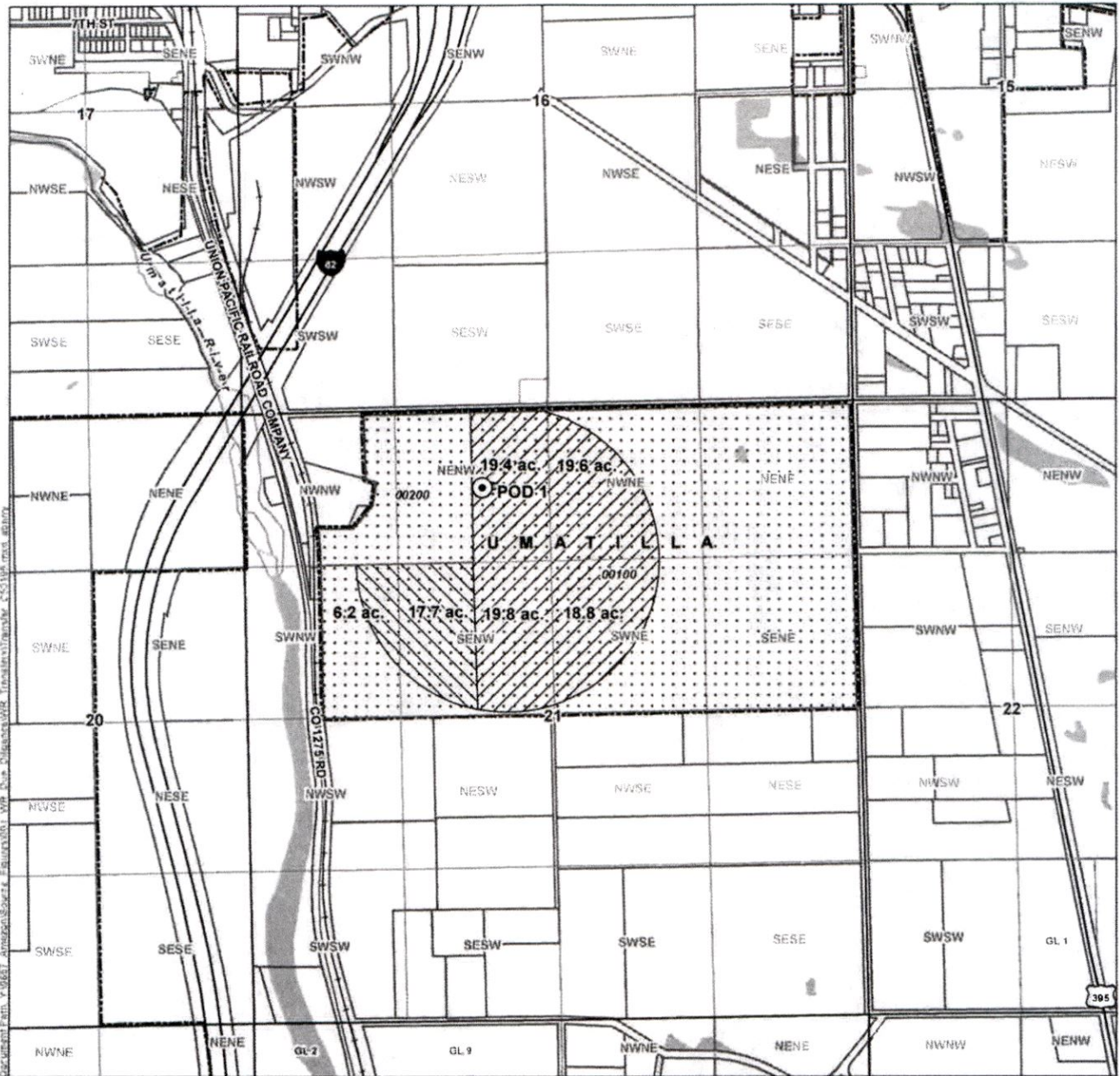

LEGEND

- Authorized Point of Diversion (POD)
- Place of Use (POU)
 - ▨ Remaining Lands
 - ▧ From Lands
 - ▩ To Lands
- Government Lot (GL)
- ▭ City Boundary
- ▭ Tax Lot
- Railroad
- Major Road
- ~ Watercourse
- Waterbody

CERTIFIED WATER RIGHTS EXAMINER STAMP

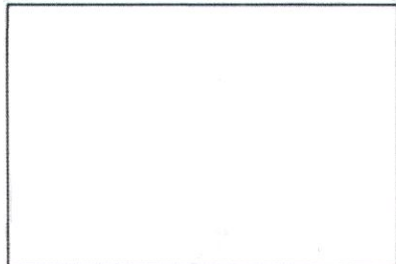

LOCATION DESCRIPTION

POD 1
720 feet South and 600 feet West from the North 1/4 corner of Section 21, Township 5 North, Range 28 East (W.M.)

**Application for Permanent Water Right Transfer
in the Name of Amazon Data Services, Inc.
Certificate 53195
Umatilla County
Township 5 North, Range 28 East (W.M.)**

RECEIVED

JUL 08 2021

OWRD

DISCLAIMER
This map was prepared for the purpose of identifying the location of a water right only and it is not intended to provide legal dimensions or location of property ownership lines.

Date: May 6, 2021
Data Sources: BLM, ESRI, OWRD USGS

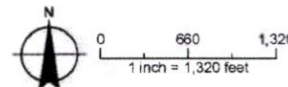

13777

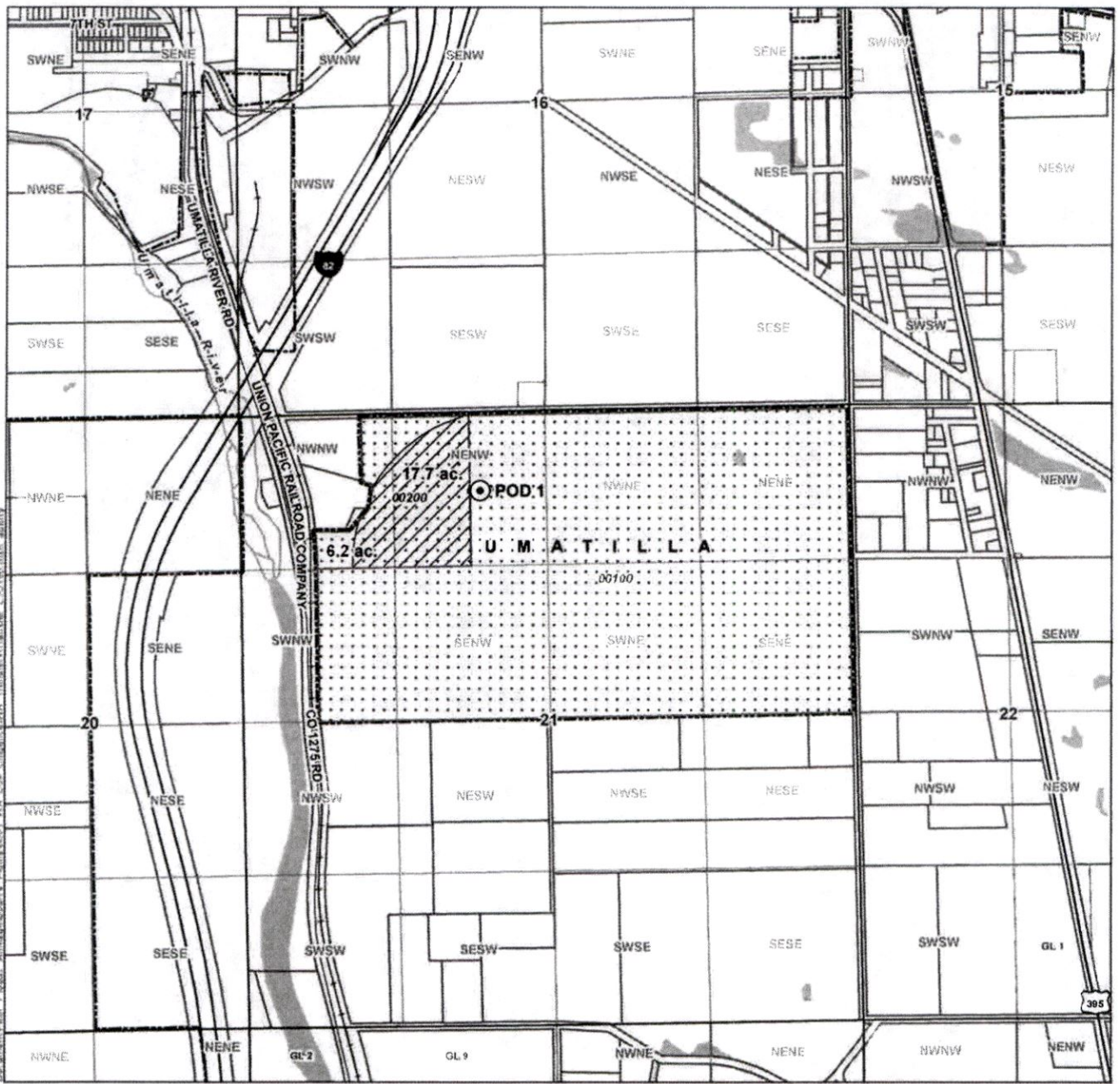

LEGEND

- Authorized Point of Diversion (POD)
- Place of Use (POU)
 - ▨ From Lands
 - ▤ To Lands
- Government Lot (GL)
- City Boundary
- Tax Lot
- Railroad
- Major Road
- ~ Watercourse
- ~ Waterbody

**Application for Permanent Water Right Transfer
in the Name of Amazon Data Services, Inc.**
Certificate 53196
 Umatilla County
 Township 5 North, Range 28 East (W.M.)

CERTIFIED WATER RIGHTS EXAMINER STAMP

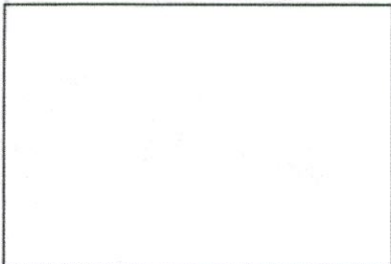

RECEIVED
JUL 08 2021
OWRD

LOCATION DESCRIPTION
POD 1
 720 feet South and 600 feet West from the North 1/4 corner
 of Section 21, Township 5 North, Range 28 East (W.M.)

DISCLAIMER
 This map was prepared for the purpose of identifying the location of a water right only and it is not intended to provide legal dimensions or location of property ownership lines.

Date: May 6, 2021
 Data Sources: BLM, ESRI, OWRD, USGS

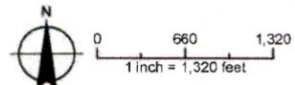

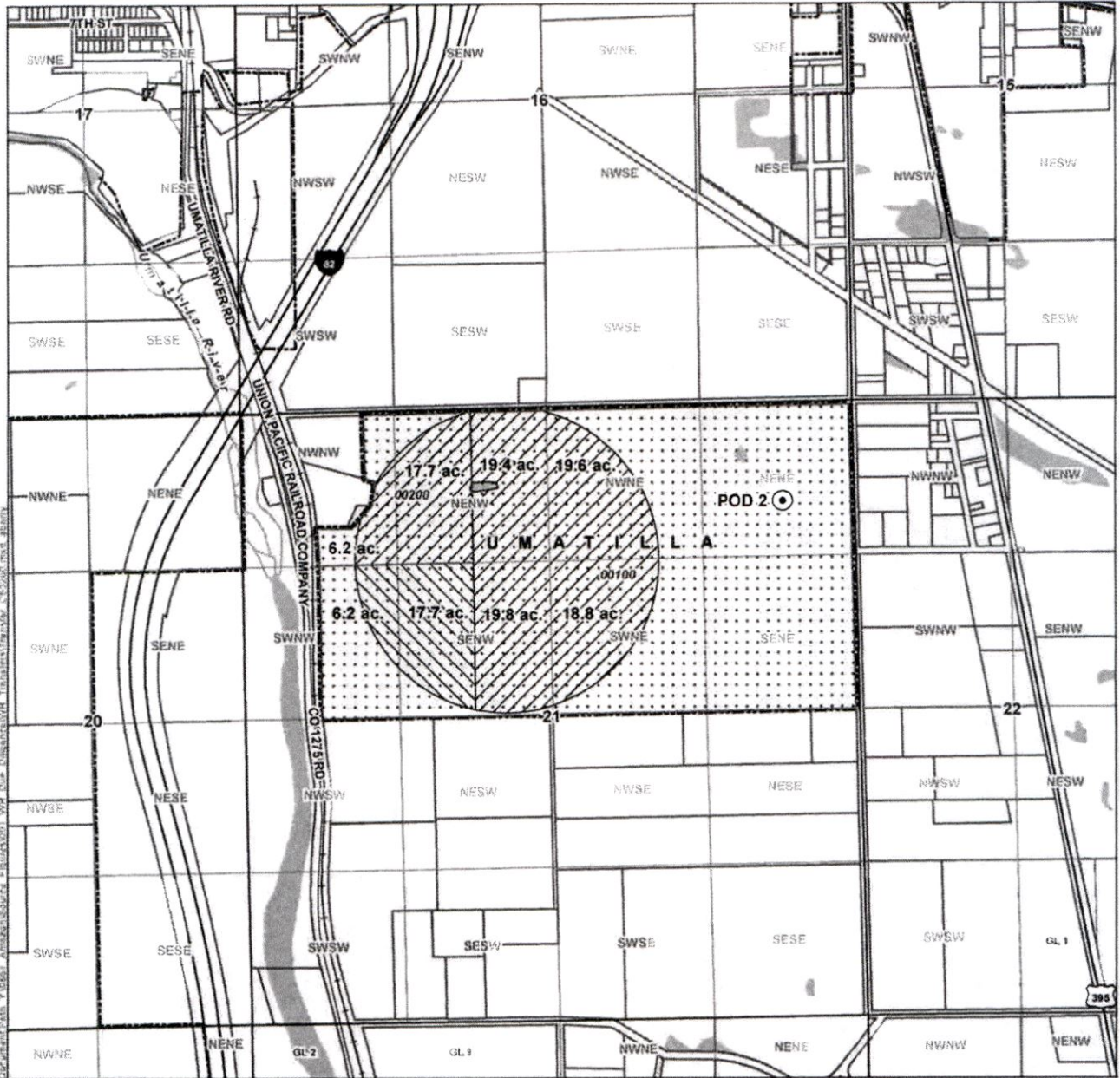

- LEGEND**
- Authorized Point of Diversion (POD)
 - Place of Use (POU)**
 - Remaining Lands
 - From Lands
 - To Lands
 - Government Lot (GL)
 - City Boundary
 - Tax Lot
 - Railroad
 - Major Road
 - Watercourse
 - Waterbody

CERTIFIED WATER RIGHTS EXAMINER STAMP

**Application for Permanent Water Right Transfer
in the Name of Amazon Data Services, Inc.
Certificate 53260
Umatilla County
Township 5 North, Range 28 East (W.M.)**

RECEIVED
JUL 08 2021
OWRD

DISCLAIMER
This map was prepared for the purpose of identifying the location of a water right only and it is not intended to provide legal dimensions or location of property ownership lines.

Date: May 6, 2021
Data Sources: BLM, ESRI, OWRD, USGS

LOCATION DESCRIPTION
POD 2
840 feet South and 620 feet West from NE Corner,
Section 21, Township 5 North, Range 28 East (W.M.)

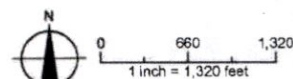

13777

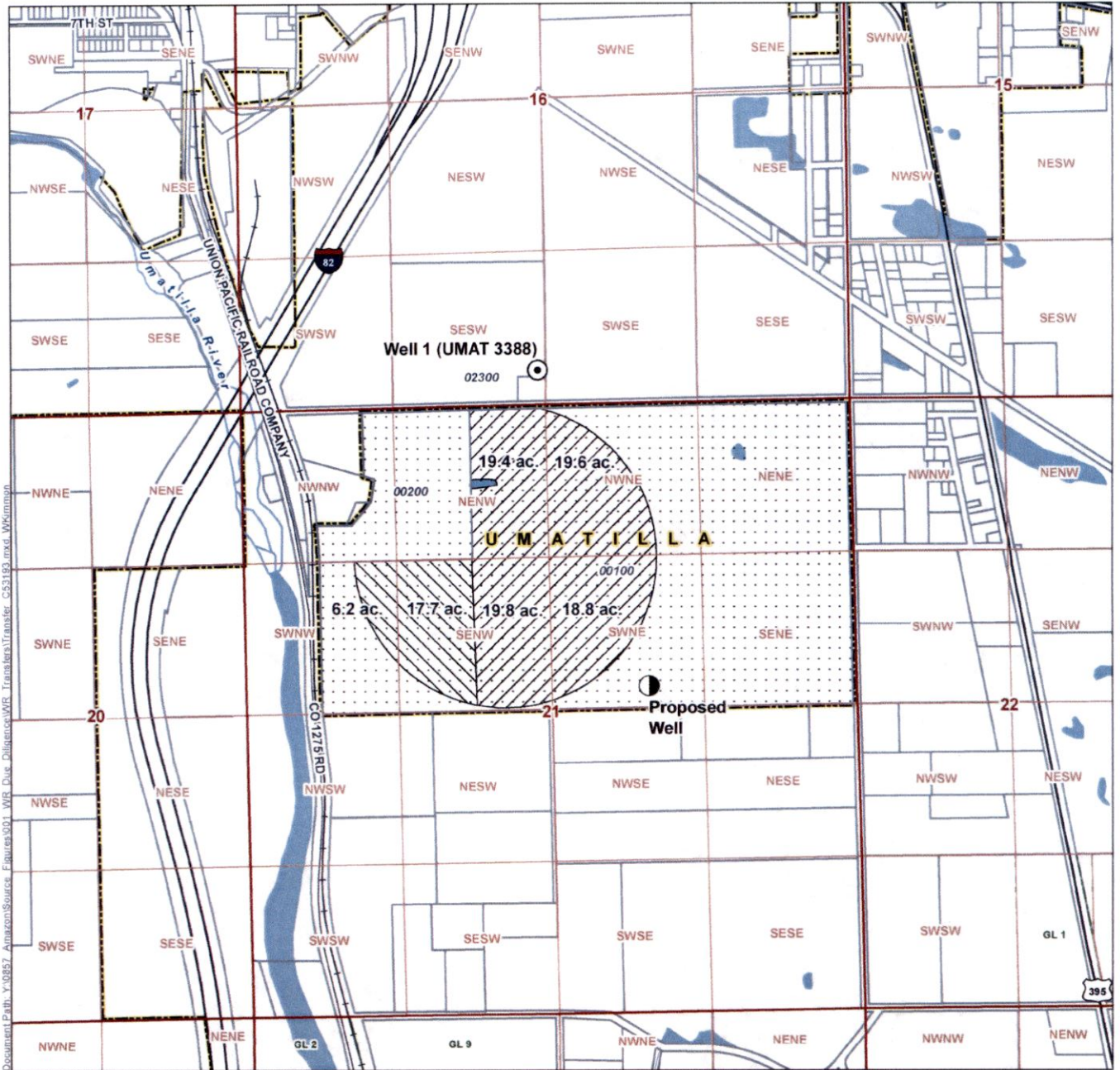

LEGEND

- ⊙ Authorized Point of Appropriation (POA)
- Proposed Point of Appropriation (POA)
- Place of Use (POU)**
- ▨ Remaining Lands
- ▩ From Lands
- ⋯ To Lands
- ▭ Government Lot (GL)
- ▭ City Boundary
- ▭ Tax Lot
- Railroad
- Major Road
- Watercourse
- Waterbody

CERTIFIED WATER RIGHTS EXAMINER STAMP

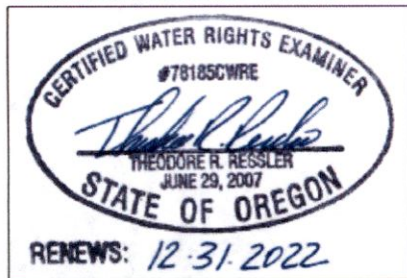

LOCATION DESCRIPTION

Well 1 (UMAT 3388)
 270 feet North and 60 feet West from the South 1/4 corner of Section 16, Township 5 North, Range 28 East (W.M.)
Proposed Well
 2450 feet South and 845 feet East from the North 1/4 corner of Section 21, Township 5 North, Range 28 East (W.M.)

**Application for Permanent Water Right Transfer
 in the Name of Amazon Web Services, Inc.**

Certificate 53193

Umatilla County

Township 5 North, Range 28 East (W.M.)

RECEIVED

JUL 08 2021

OWRD

DISCLAIMER

This map was prepared for the purpose of identifying the location of a water right only and it is not intended to provide legal dimensions or location of property ownership lines.

Date: June 30, 2021

Data Sources: BLM, ESRI, OWRD, USGS

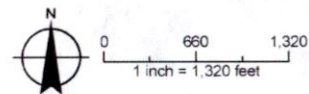

13777

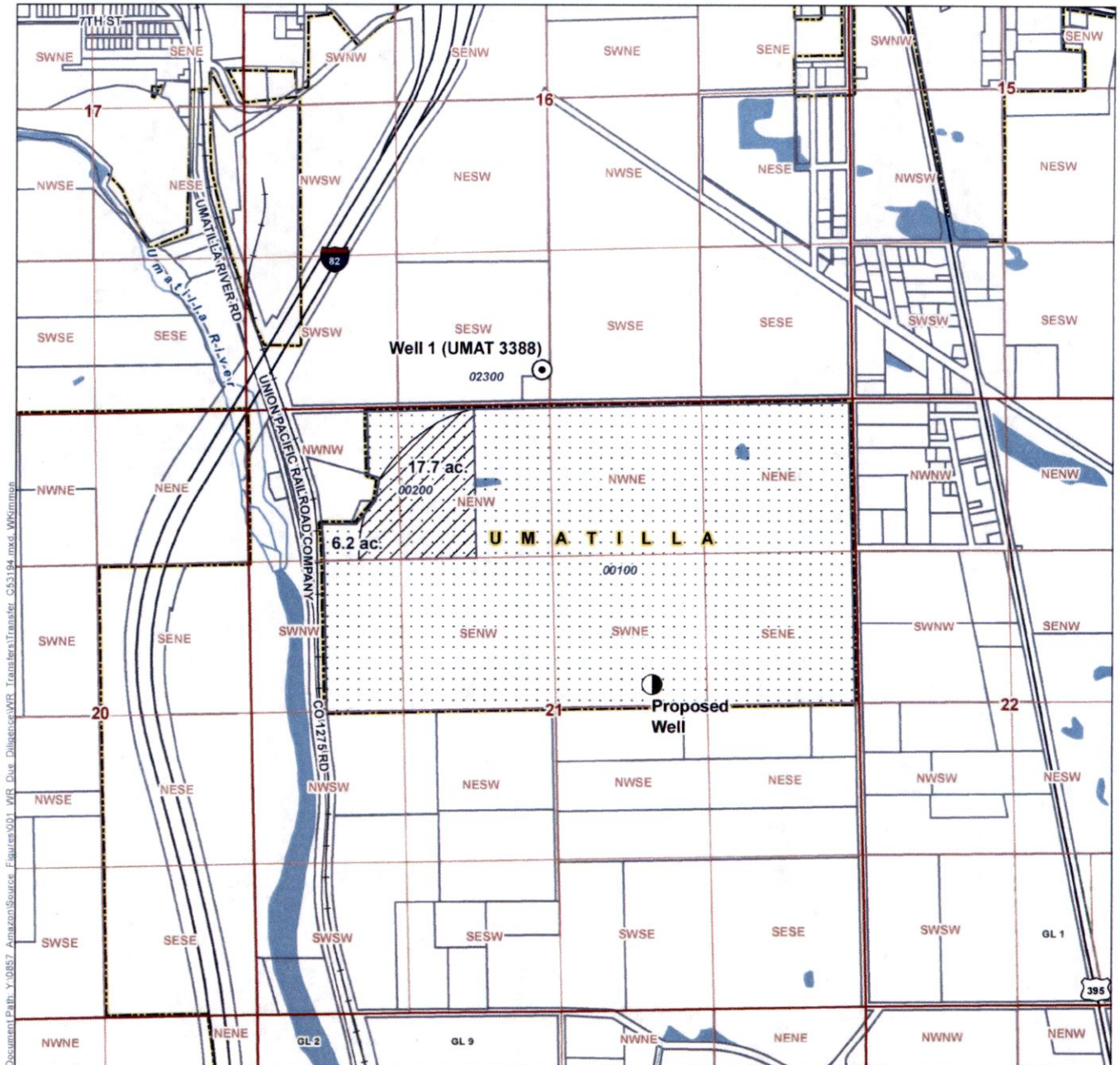

Document Path: Y:\0867 - Amazon\Source: Figures\001 - WR Due Diligence\WR Transfer\Transfer_C53194.mxd, WK\map

LEGEND

- Authorized Point of Appropriation (POA)
- Proposed Point of Appropriation (POA)
- Place of Use (POU)**
- From lands
- To Lands
- Government Lot (GL)
- City Boundary
- Tax Lot
- Railroad
- Major Road
- Watercourse
- Waterbody

CERTIFIED WATER RIGHTS EXAMINER STAMP

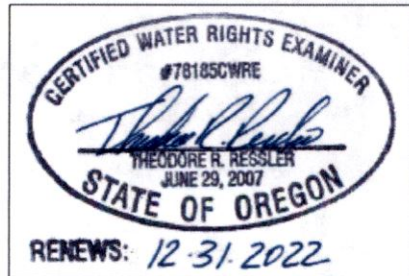

Application for Permanent Water Right Transfer in the Name of Amazon Web Services, Inc.

Certificate 53194

Umatilla County

Township 5 North, Range 28 East (W.M.)

RECEIVED
JUL 08 2021
OWRD

LOCATION DESCRIPTION
Well 1 (UMAT 3388)
 270 feet North and 60 feet West from the South 1/4 corner of Section 16, Township 5 North, Range 28 East (W.M.)
Proposed Well
 2450 feet South and 845 feet East from the North 1/4 corner of Section 21, Township 5 North, Range 28 East (W.M.)

DISCLAIMER
 This map was prepared for the purpose of identifying the location of a water right only and it is not intended to provide legal dimensions or location of property ownership lines.

Date: June 30, 2021
 Data Sources: BLM, ESRI, OWRD, USGS

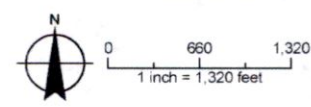

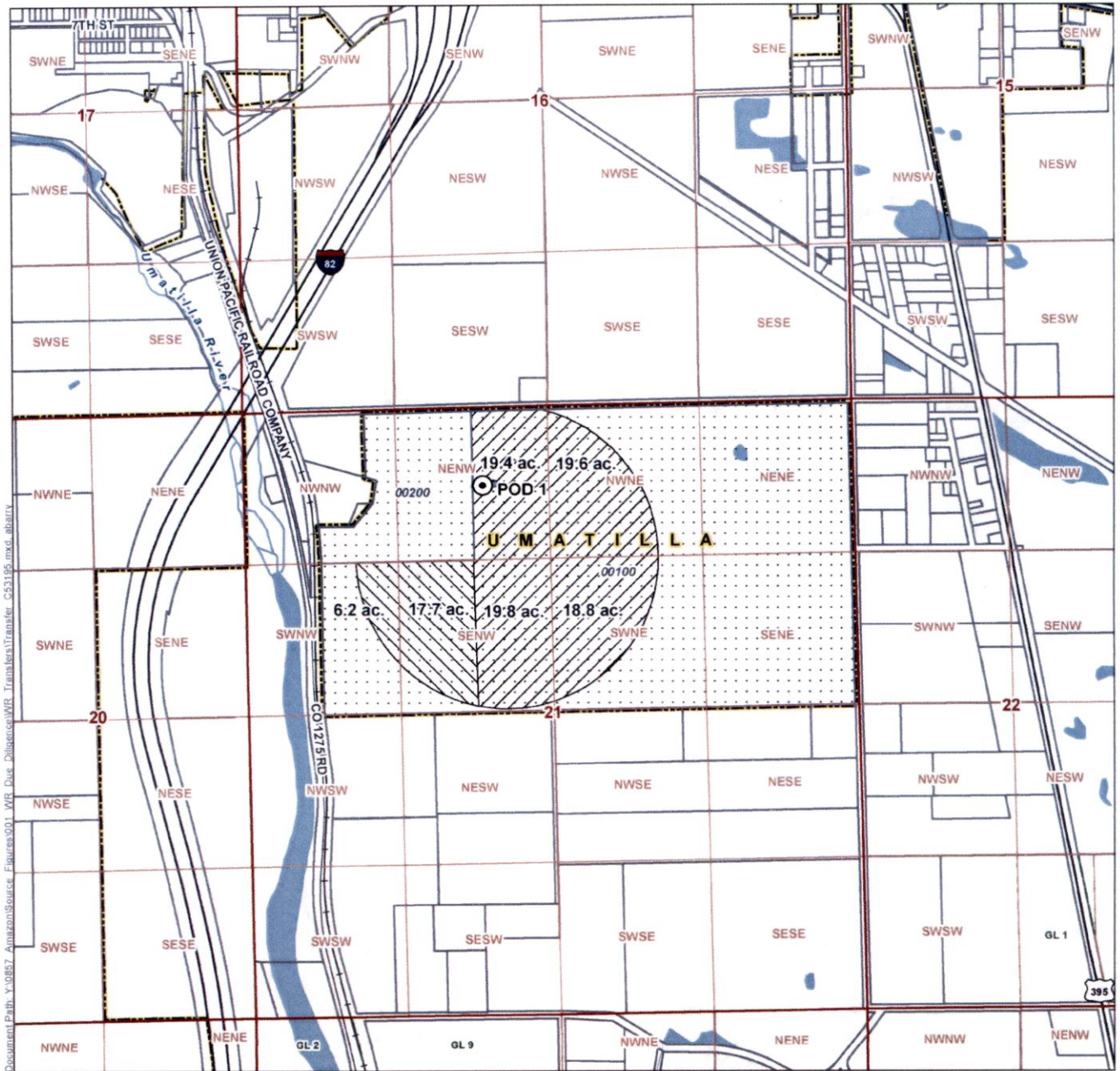

Document Path: Y:\0857_Amazon\Source_Figures\01_VR_Due_Diligence\WR_Transfers\Transfer_C53195.mxd; authority

LEGEND

- ⊙ Authorized Point of Diversion (POD)
- Place of Use (POU)
 - Remaining Lands
 - From Lands
 - To Lands
- Government Lot (GL)
- City Boundary
- Tax Lot
- Railroad
- Major Road
- Watercourse
- Waterbody

CERTIFIED WATER RIGHTS EXAMINER STAMP

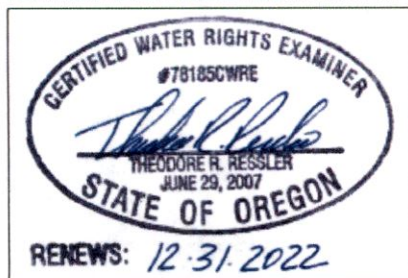

**Application for Permanent Water Right Transfer
in the Name of Amazon Data Services, Inc.
Certificate 53195
Umatilla County
Township 5 North, Range 28 East (W.M.)**

RECEIVED
JUL 08 2021
OWRD

LOCATION DESCRIPTION

POD 1
720 feet South and 600 feet West from the North 1/4 corner
of Section 21, Township 5 North, Range 28 East (W.M.)

DISCLAIMER
This map was prepared for the purpose of
identifying the location of a water right only and
it is not intended to provide legal dimensions
or location of property ownership lines.

Date: May 6, 2021
Data Sources: BLM, ESRI, OWRD, USGS

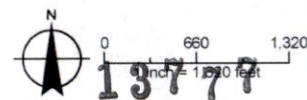

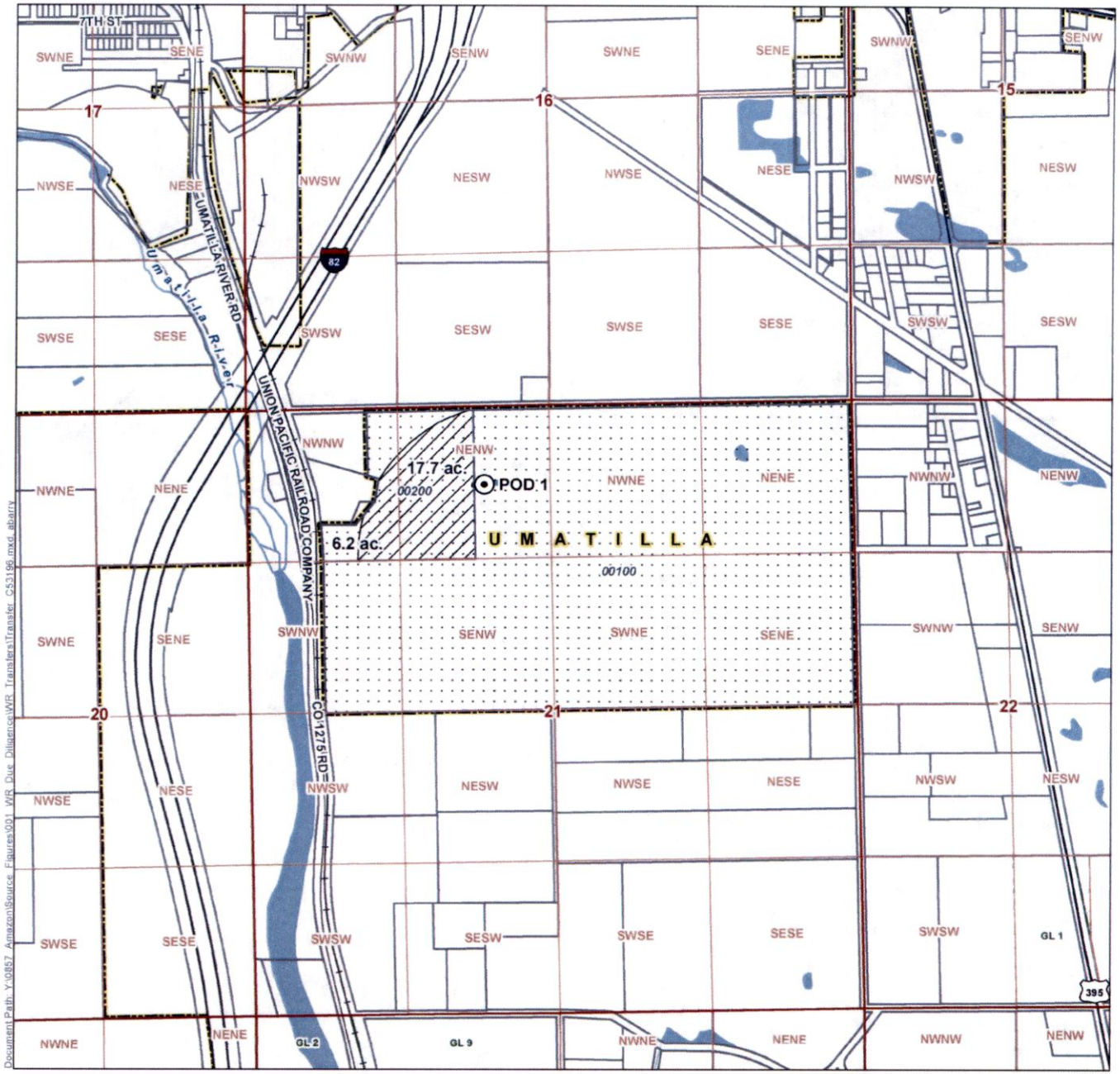

Document Path: Y:\0867 - AmazonSource\Figures\001_WR Due Diligence\WR Transfer\Transfer_C53196_rmd_abarr

LEGEND

- Authorized Point of Diversion (POD)
- Government Lot (GL)
- City Boundary
- Tax Lot
- Railroad
- Major Road
- Watercourse
- Waterbody
- From Lands
- To Lands

CERTIFIED WATER RIGHTS EXAMINER STAMP



LOCATION DESCRIPTION
 POD 1
 720 feet South and 600 feet West from the North 1/4 corner
 of Section 21, Township 5 North, Range 28 East (W.M.)

**Application for Permanent Water Right Transfer
 in the Name of Amazon Data Services, Inc.**
 Certificate 53196
 Umatilla County
 Township 5 North, Range 28 East (W.M.)

RECEIVED

JUL 08 2021

OWRD

DISCLAIMER
 This map was prepared for the purpose of
 identifying the location of a water right only and
 it is not intended to provide legal dimensions
 or location of property ownership lines.

Date: May 6, 2021
 Data Sources: BLM, ESRI, OWRD, USGS

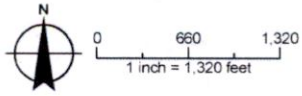

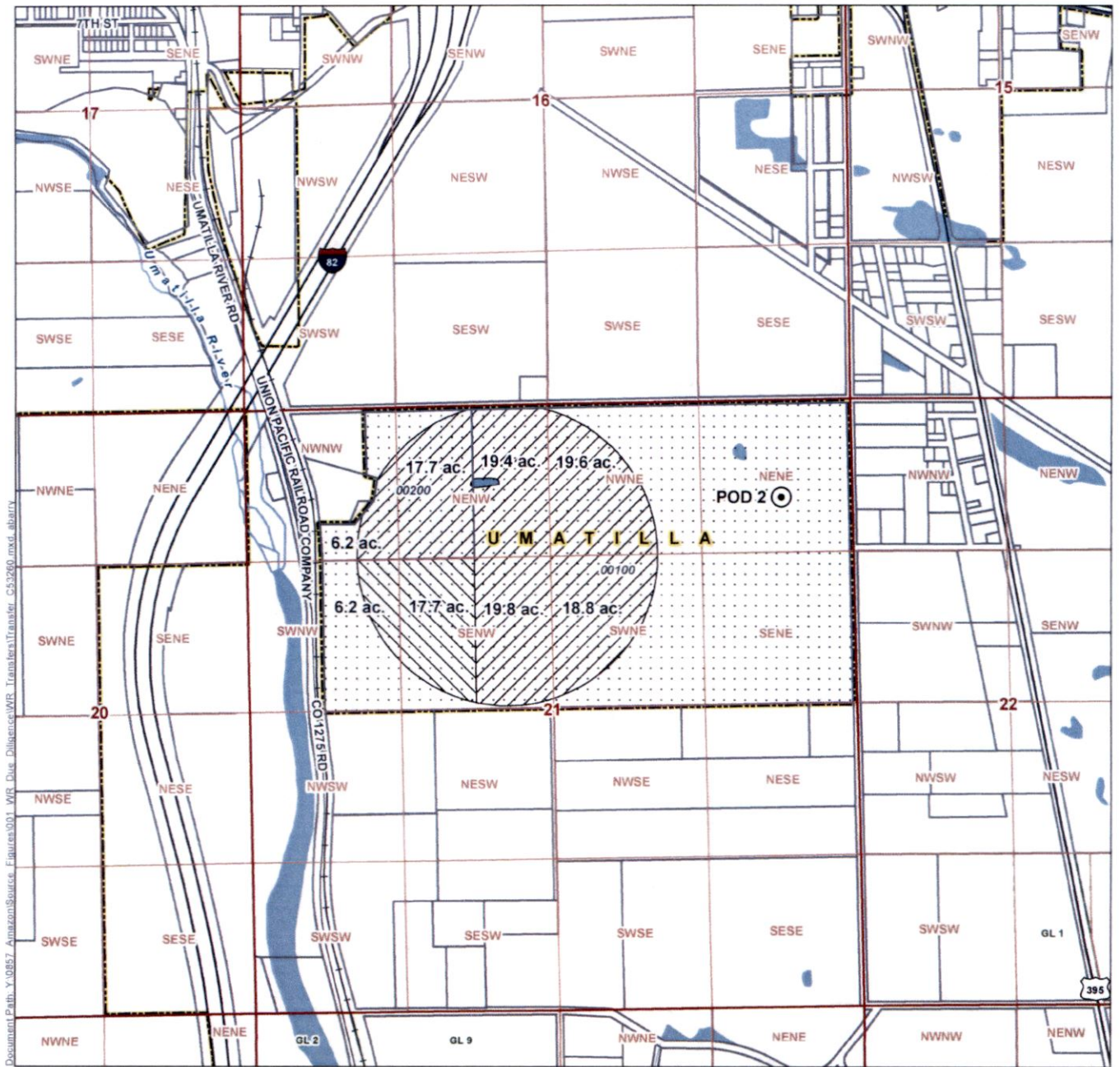

Document Path: Y:\0857_Amazon\Source_Figures\011_WR Due Diligence\WR_Transfer\Transfer_C53260.mxd_albany

LEGEND

- ⊙ Authorized Point of Diversion (POD)
- Place of Use (POU)
 - Remaining Lands
 - From Lands
 - To Lands
- Government Lot (GL)
- City Boundary
- Tax Lot
- Railroad
- Major Road
- Watercourse
- Waterbody

**Application for Permanent Water Right Transfer
in the Name of Amazon Data Services, Inc.
Certificate 53260
Umatilla County
Township 5 North, Range 28 East (W.M.)**

CERTIFIED WATER RIGHTS EXAMINER STAMP

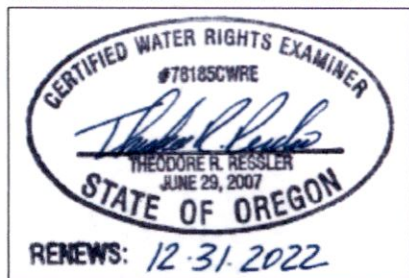

RECEIVED
JUL 08 2021
OWRD

LOCATION DESCRIPTION
POD 2
840 feet South and 620 feet West from NE Corner,
Section 21, Township 5 North, Range 28 East (W.M.)

DISCLAIMER
This map was prepared for the purpose of identifying the location of a water right only and it is not intended to provide legal dimensions or location of property ownership lines.

Date: May 6, 2021
Data Sources: BLM, ESRI, OWRD, USGS

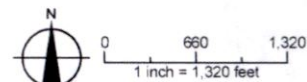

13777

RECEIVED

JUL 08 2021

OWRD

Attachment B
Application Maps

Application for a Permanent Water Right Transfer – Amazon Data Services, Inc.

13777