

LEGEND

- Proposed Point of Diversion (POD)
 (Certificate 53093 and Certificate 66607)
- Conveyance Line
- Place of Use (POU)**
 - To Lands, 43.1 acres
 - Certificate 53093
 - To Lands, 32.9 acres
 - Certificate 66607
- All Other Features**
 - Tax Lot
 - Donation Land Claim (DLC)
 - Watercourse
 - Waterbody

Application for a Permanent Water Right Transfer
in the Name of Sarbanand Enterprises;
To Lands and Proposed Points of Diversion Map
 Township 4 South, Range 4 West (W.M.)

RECEIVED
 OCT 25 2021
 OWRD

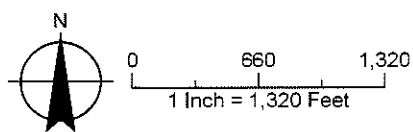

13854

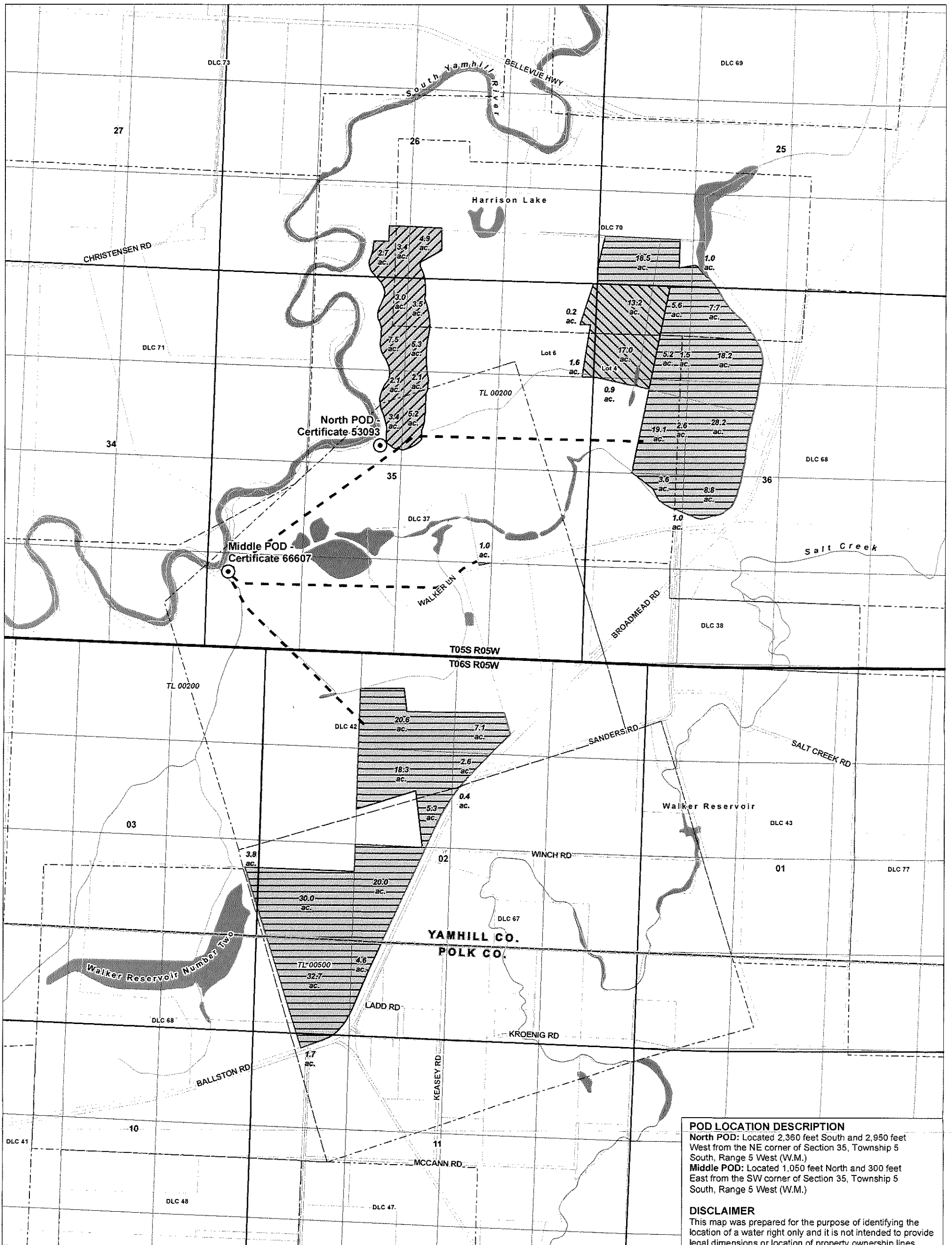

POD LOCATION DESCRIPTION
North POD: Located 2,360 feet South and 2,950 feet West from the NE corner of Section 35, Township 5 South, Range 5 West (W.M.)
Middle POD: Located 1,050 feet North and 300 feet East from the SW corner of Section 35, Township 5 South, Range 5 West (W.M.)

DISCLAIMER
 This map was prepared for the purpose of identifying the location of a water right only and it is not intended to provide legal dimensions or location of property ownership lines.

LEGEND

- ⊙ Authorized Point of Diversion (POD)
- - - Conveyance Line
- Place of Use (POU)**
- ▨ From Lands, 43.1 acres - Certificate 53093
- ▨ From Lands, 32.9 acres - Certificate 66607
- ▨ Remaining Lands, 269.1 acres - Certificate 66607
- All Other Features**
- Tax Lot
- Donation Land Claim (DLC)
- Government Lot (GL)
- County Line
- ~ Watercourse
- ☾ Waterbody

RECEIVED
 OCT 25 2021

CERTIFIED WATER RIGHTS EXAMINER STAMP

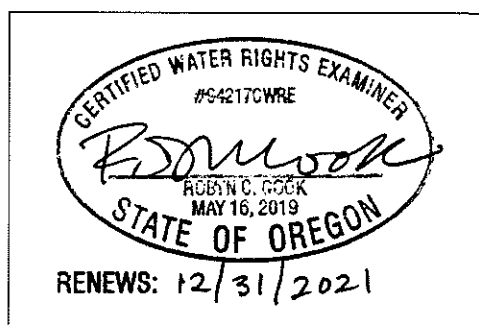

Application for a Permanent Water Right Transfer in the Name of Sarbanand Enterprises; From Lands, Remaining Lands, and Authorized Points of Diversion Map Township 5 & 6 South, Range 5 West (W.M.)

MAP NOTES

Date: July 28, 2021
 Data Sources: BLM, ESRI, Yamhill Co., Polk Co., USGS

