

WATER RIGHT EXAMINER
 83503
 JAMIE HAMILTON
 MAY 10, 2012
 EXPIRES: 2022

- Donation Land Claim boundary
- Tax lot boundary
- Irrigation mainlines

T.4S. R.1W.
Sec. 26, 27, 34, & 35 W.M.

Proposed Well 1 (MARI 765) is located 25 feet south and 1,960 feet east from the NW corner, DLC 63.
 Proposed Well 2 (MARI 63689) is located 40 feet south and 1,860 feet east from the NW corner, DLC 63.
 Proposed Well 3 (MARI 767) is located 1,470 feet south and 860 feet east from the NW corner, DLC 63.
 Proposed Well 4 (MARI 764) is located 220 feet north and 70 feet east from the SW corner, Section 26.
 Authorized Well 5 (MARI 69905) is located 1,030 feet south and 555 feet east from the NW corner, Section 35.
 Proposed Well 6 (MARI 1013) is located 30 feet north and 1,360 feet west from the NW corner, DLC 53.
 Area (124.5 Acres) irrigated under Application G-18923, Permit G-18537 affected by this permit amendment.

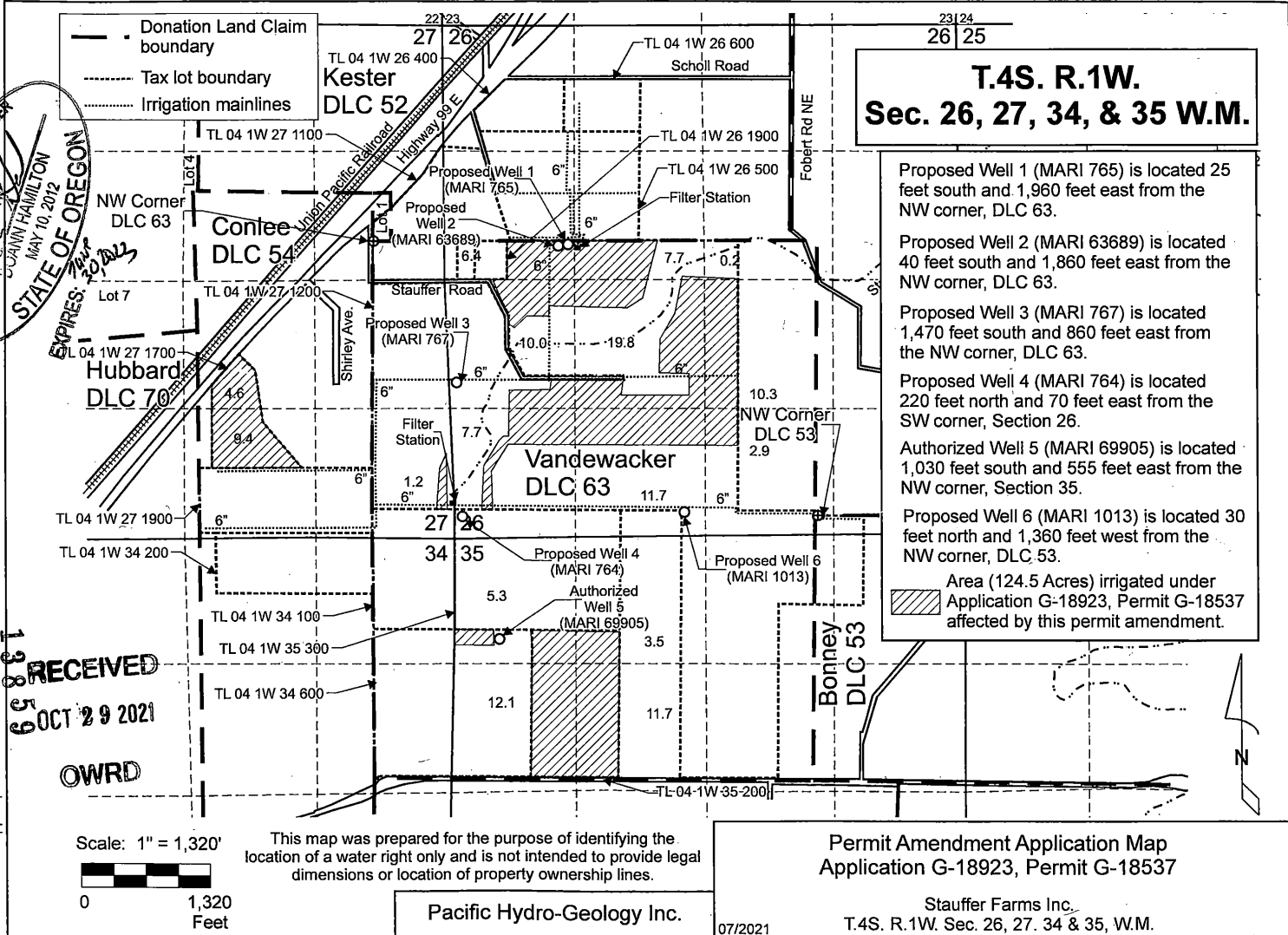

RECEIVED
 OCT 29 2021

OWRD

Scale: 1" = 1,320'
 0 1,320 Feet

This map was prepared for the purpose of identifying the location of a water right only and is not intended to provide legal dimensions or location of property ownership lines.

Pacific Hydro-Geology Inc.

Permit Amendment Application Map
 Application G-18923, Permit G-18537

Stauffer Farms Inc.
 T.4S. R.1W. Sec. 26, 27, 34 & 35, W.M.

07/2021