

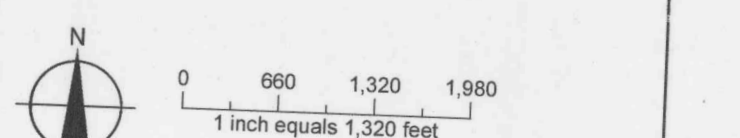

**Groundwater Permit G-18689**  
**Place of Use**  
 Umatilla and Morrow Counties, Oregon

- LEGEND**
- Place of Use (POU)
    - Primary - 1,128.9 ac.
    - Supplemental - 8,013.5 ac.
  - All Other Features
    - Tax Lot
    - County Boundary
    - Watercourse
    - Waterbody

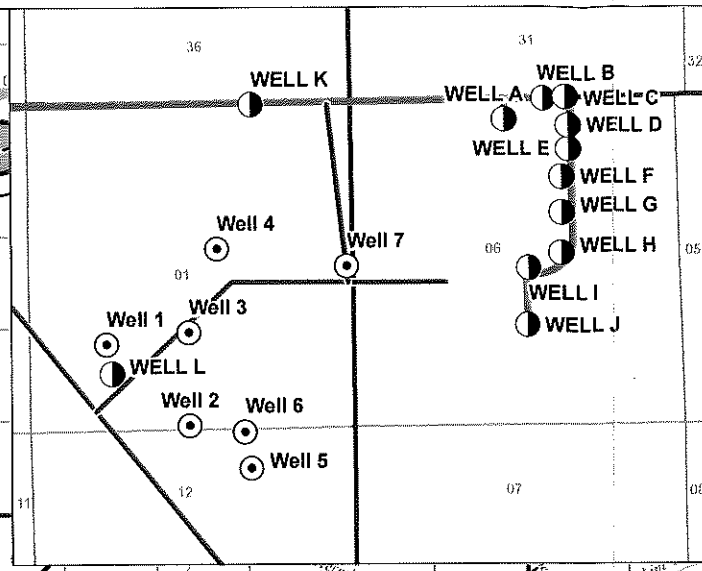

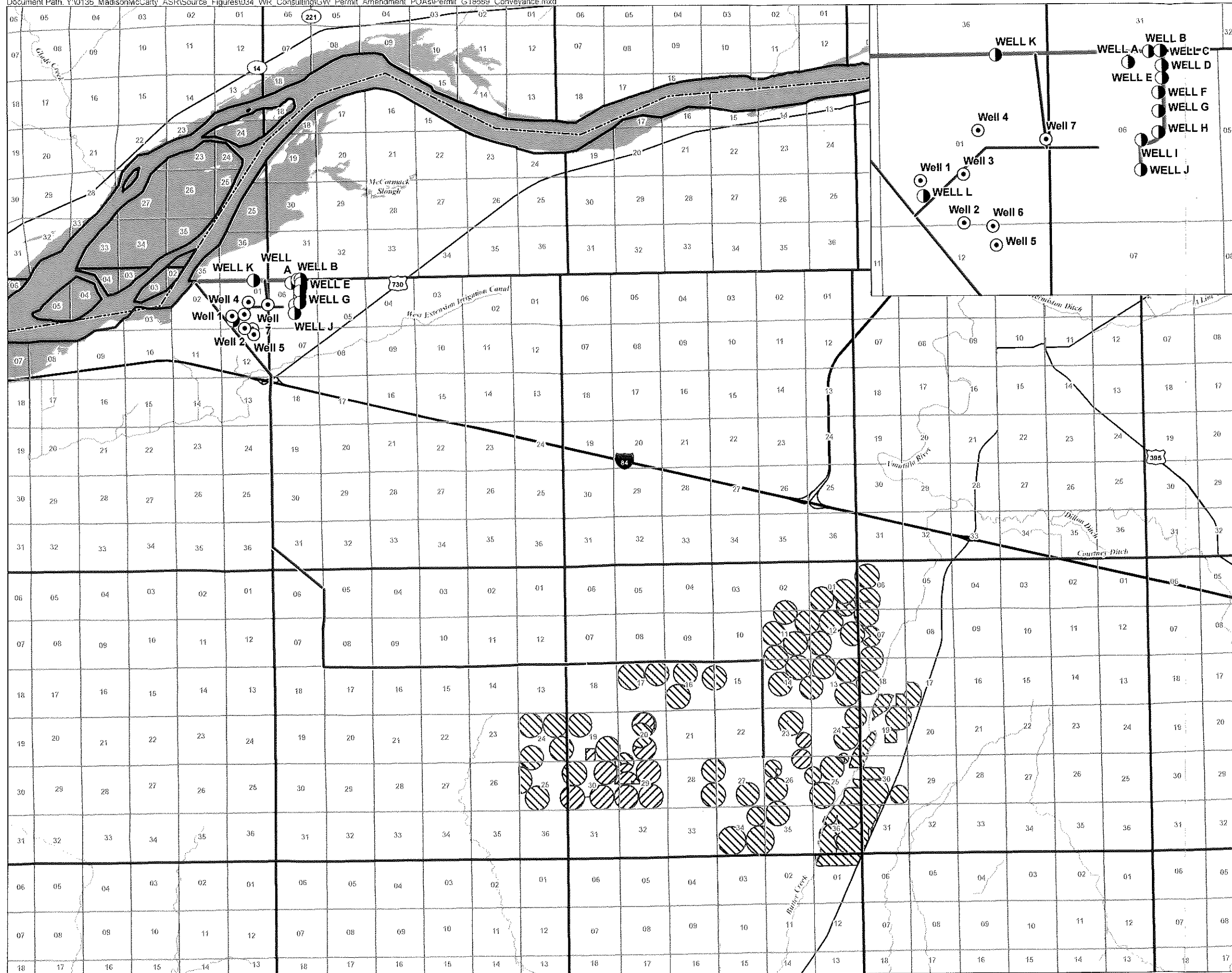

### Conveyance Map For Permit G-18689 Umatilla and Morrow Counties, Oregon

Townships 2, 3, 4, & 5 North,  
Ranges 25, 26, 27, & 28 East (W.M.)

#### LEGEND

- Conveyance Pipeline
- Proposed Mainline
- Point of Appropriation (POA)**
  - Authorized POA
  - Proposed POA
- Place of Use (POU)**
  - Primary - 1,128.9 ac.
  - Supplemental - 8,013.5 ac.
- All Other Features**
  - County Boundary
  - Major Road
  - Watercourse
  - Waterbody

RECEIVED  
JAN 14 2022

OWRD  
13893

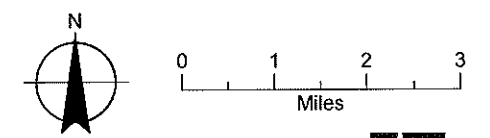

Date: September 17, 2021  
Data Sources: BLM, ESRI, USGS



13893  
~~19683~~

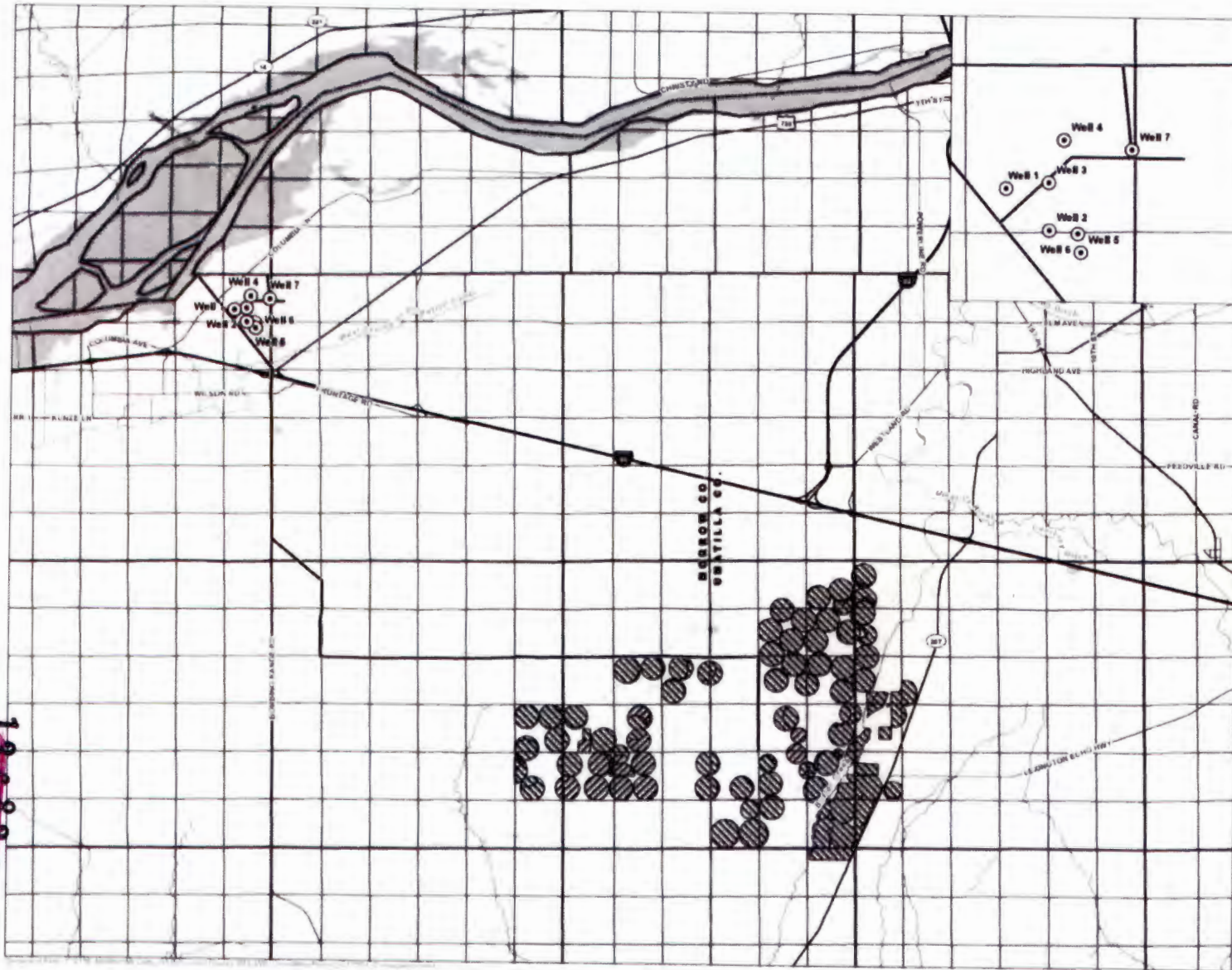

**Conveyance Map For  
Permit G-17354  
Umatilla and Morrow Counties,  
Oregon**  
Townships 2, 3, 4, & 5 North,  
Ranges 25, 26, 27, & 28 East (W.M.)

- LEGEND**
- Authorized PDA
  - ~ Conveyance Pipeline
  - Place of Use (POU)**
  - ▨ Primary - 1,128.9 ac
  - ▩ Supplemental - 8,013.5 ac
  - All Other Features**
  - County Boundary
  - Major Road
  - ~ Watercourse
  - Waterbody

RECEIVED  
APR 21 2021  
OWRD

N  
0 1 2 3  
Miles

**GSI**  
Geospatial Solutions, Inc.

Date: March 26 2021  
Data Sources: BLM, ESRI, USGS

RECEIVED  
JAN 14 2022

OWRD

**Permit Amendment Application  
For Permit G-18689  
Point of Appropriation Map  
Morrow County, OR  
Townships 4 North,  
Ranges 25 & 26 East (W.M.)**

- LEGEND**
- ⊕ Monitoring Well Location - Approved by OWRD
  - ⊙ Authorized POA
  - ⊖ Proposed POA
  - Railroad
  - ▭ Tax Lot
  - ▭ Watercourse
  - ▭ Waterbody

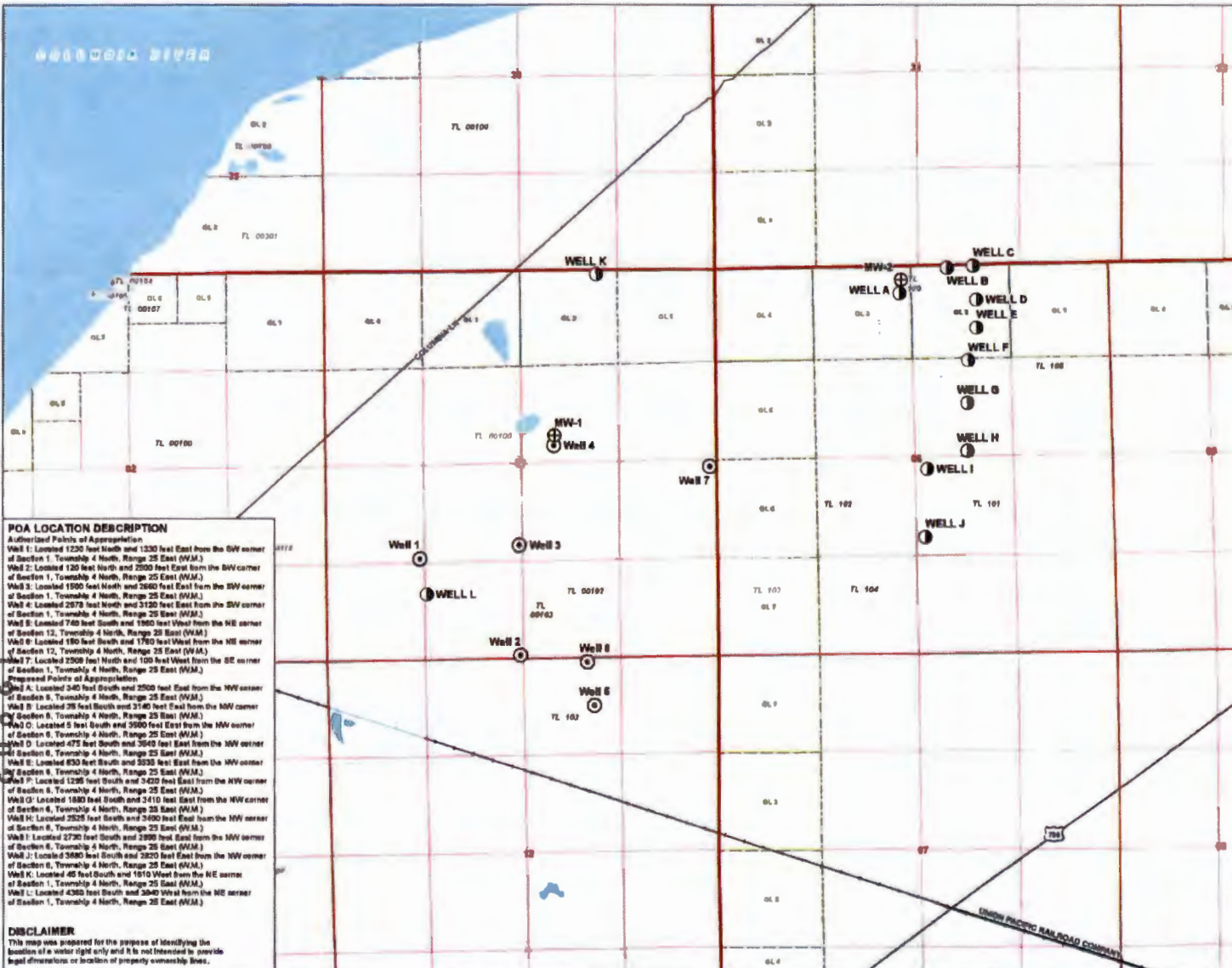

**POA LOCATION DESCRIPTION**  
A list of authorized points of appropriation for various wells, including their locations relative to section corners and bearings.

**Proposed Points of Appropriation**  
A list of proposed points of appropriation for wells A through L, including their locations relative to monitoring wells and section corners.

**DISCLAIMER**  
This map was prepared for the purpose of identifying the location of a water right only and is not intended to provide legal dimensions or location of property ownership lines.

**RECEIVED**  
**JAN 14 2022**  
**OWRD**

Date: September 17, 2021  
Data Source: EBRL, Umatilla Co., Morrow Co., USGS, BLM, OWRD

**GSI**  
Water Solutions, Inc.

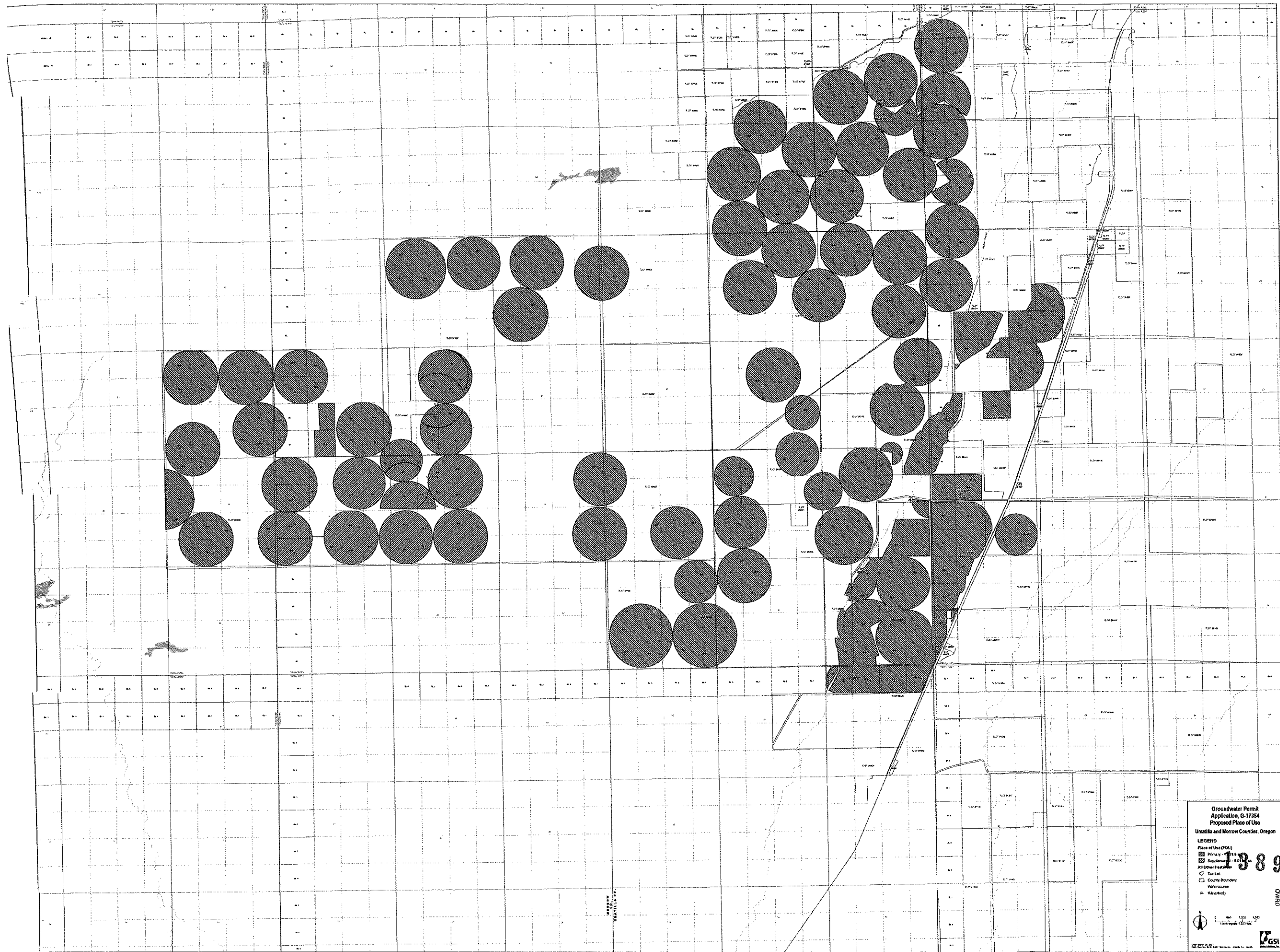

RECEIVED  
 JAN 14 2022  
 OWRD

Groundwater Permit  
 Application, G-17354  
 Proposed Place of Use  
 Umatilla and Morrow Counties, Oregon

LEGEND  
 Place of Use (POU)  
 Primary POU  
 Supplemental POU  
 All Other POU  
 Watercourse  
 County Boundary  
 Watercourse  
 Waterbody

13893

OWRD  
 2022.01.14

GSI



**FIGURE 1**  
**Test Hole Location Map**  
 Madison Ranches

**LEGEND**

- Authorized POA
- Proposed POA
- Test Hole
- Main line
- - - Proposed Mainline
- ▬ Potable Pipeline
- One Mile Buffer from Columbia River
- ▭ City Boundary
- ≡ Major Road
- Railroad
- ~ Watercourse

RECEIVED  
 JAN 14 2022  
 OWRD

Note:  
 TH-1 = MORR 52512  
 TH-2 (Destroyed)  
 TH-3 = MORR 52575  
 TH-4 = MORR 52578  
 TH-5 = MORR 52579  
 TH-6 = MORR 52580

13893

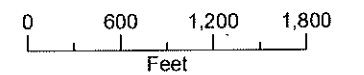

Date: April 20, 2021  
 Data Sources: BLM, ESRI, ODOT, USGS,  
 Aerial Photo 2019



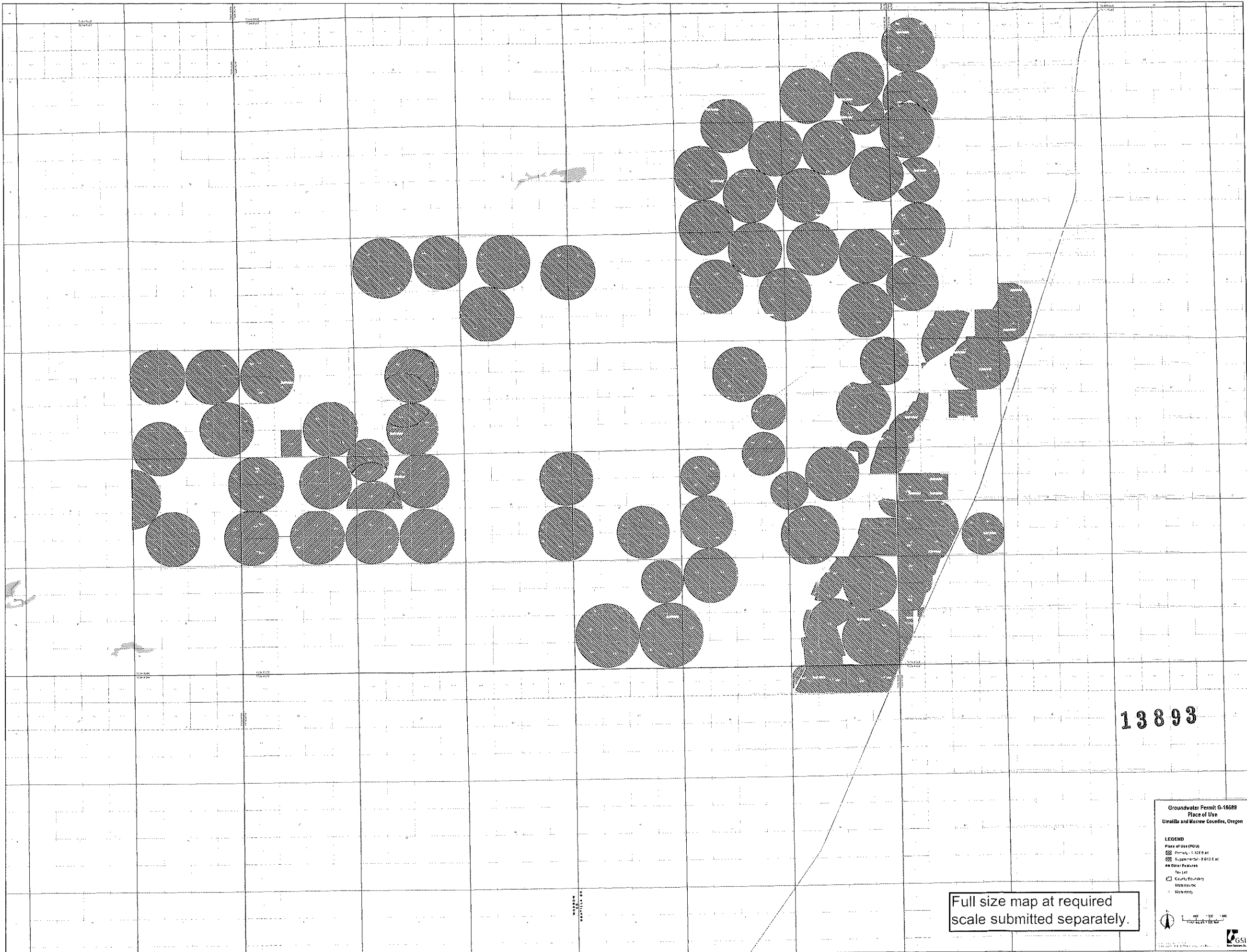

13893

RECEIVED  
 JAN 14 2022  
 OWRD

Full size map at required  
 scale submitted separately.

Groundwater Permit D-16589  
 Place of Use  
 Unalla and Morrow Counties, Oregon

**LEGEND**  
 Place of Use (POU)  
 Primary - 1,000 ft²  
 Supplemental - 2,610 ft²  
 All Other Features  
 Twp. L. 10  
 County Boundary  
 Waterway  
 Wellhead

Scale: 1" = 1000'

GS&I  
 Geospatial Solutions, Inc.

**Permit Amendment Application  
For Permit G-18689  
Point of Appropriation Map  
Morrow County, OR  
Townships 4 North,  
Ranges 25 & 26 East (W.M.)**

**LEGEND**

- ⊕ Monitoring Well Location –  
Approved by OWRD
- ⊙ Authorized POA
- Proposed POA
- Railroad
- - - Tax Lot
- ~ Watercourse
- Waterbody

13893

RECEIVED

JAN 14 2022

OWRD

Note:  
MW-1 = MORR 52512  
MW-2 = MORR 52575

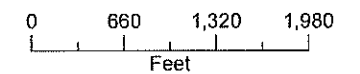

Date: September 17, 2021  
Data Sources: ESRI, Umatilla Co., Morrow Co.,  
USGS, BLM, OWRD

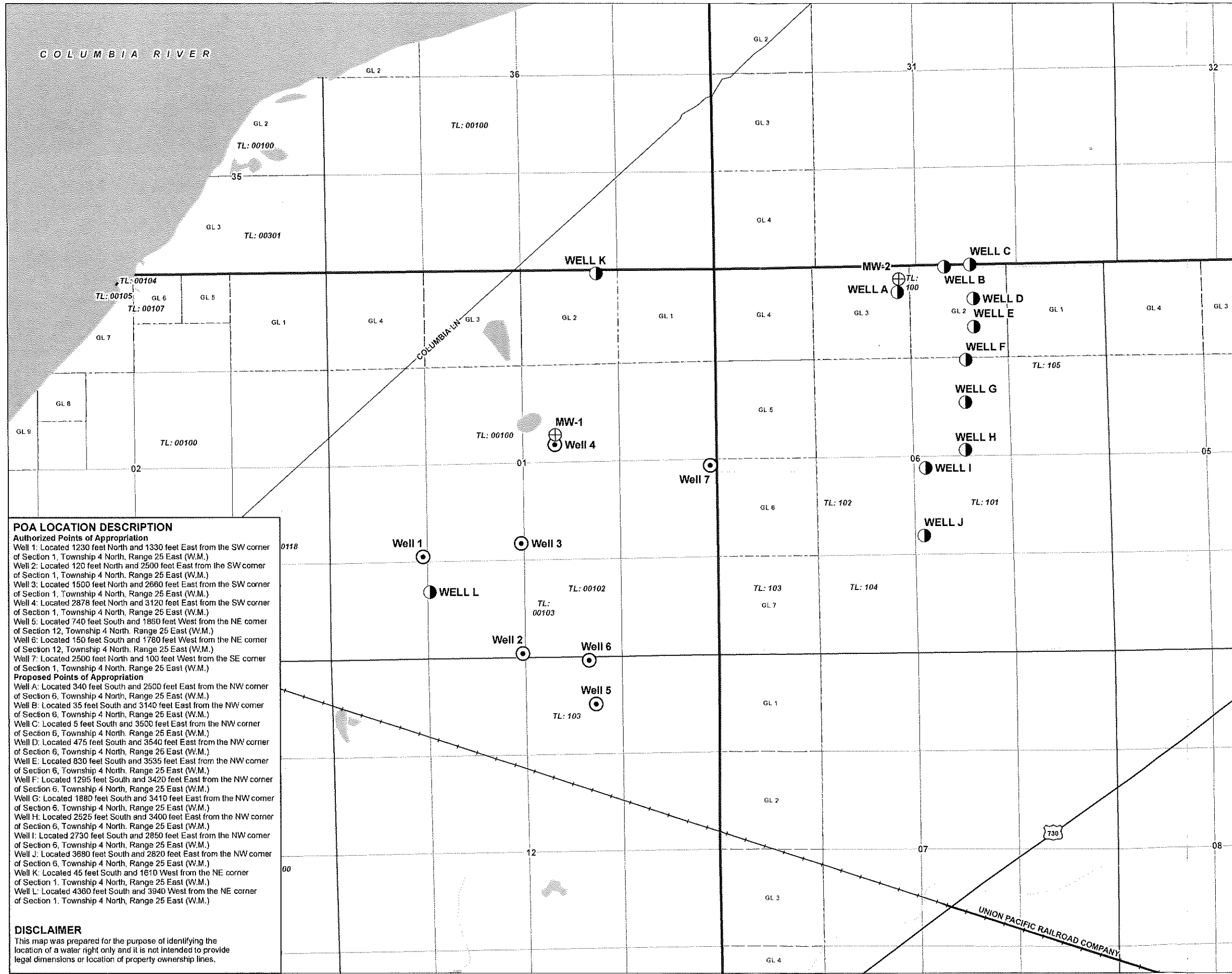

**POA LOCATION DESCRIPTION**  
**Authorized Points of Appropriation**  
 Well 1: Located 1230 feet North and 1330 feet East from the SW corner of Section 1, Township 4 North, Range 25 East (W.M.)  
 Well 2: Located 120 feet North and 2500 feet East from the SW corner of Section 1, Township 4 North, Range 25 East (W.M.)  
 Well 3: Located 1500 feet North and 2660 feet East from the SW corner of Section 1, Township 4 North, Range 25 East (W.M.)  
 Well 4: Located 2878 feet North and 3120 feet East from the SW corner of Section 1, Township 4 North, Range 25 East (W.M.)  
 Well 5: Located 740 feet South and 1860 feet West from the NE corner of Section 12, Township 4 North, Range 25 East (W.M.)  
 Well 6: Located 150 feet South and 1780 feet West from the NE corner of Section 12, Township 4 North, Range 25 East (W.M.)  
 Well 7: Located 2500 feet North and 100 feet West from the SE corner of Section 1, Township 4 North, Range 25 East (W.M.)  
**Proposed Points of Appropriation**  
 Well A: Located 340 feet South and 2500 feet East from the NW corner of Section 6, Township 4 North, Range 25 East (W.M.)  
 Well B: Located 35 feet South and 3140 feet East from the NW corner of Section 6, Township 4 North, Range 25 East (W.M.)  
 Well C: Located 5 feet South and 3500 feet East from the NW corner of Section 6, Township 4 North, Range 25 East (W.M.)  
 Well D: Located 475 feet South and 3540 feet East from the NW corner of Section 6, Township 4 North, Range 25 East (W.M.)  
 Well E: Located 830 feet South and 3535 feet East from the NW corner of Section 6, Township 4 North, Range 25 East (W.M.)  
 Well F: Located 1295 feet South and 3420 feet East from the NW corner of Section 6, Township 4 North, Range 25 East (W.M.)  
 Well G: Located 1880 feet South and 3410 feet East from the NW corner of Section 6, Township 4 North, Range 25 East (W.M.)  
 Well H: Located 2525 feet South and 3400 feet East from the NW corner of Section 6, Township 4 North, Range 25 East (W.M.)  
 Well I: Located 2730 feet South and 2850 feet East from the NW corner of Section 6, Township 4 North, Range 25 East (W.M.)  
 Well J: Located 3680 feet South and 2820 feet East from the NW corner of Section 6, Township 4 North, Range 25 East (W.M.)  
 Well K: Located 45 feet South and 1610 West from the NE corner of Section 1, Township 4 North, Range 25 East (W.M.)  
 Well L: Located 4360 feet South and 3940 West from the NE corner of Section 1, Township 4 North, Range 25 East (W.M.)

**DISCLAIMER**  
 This map was prepared for the purpose of identifying the location of a water right only and it is not intended to provide legal dimensions or location of property ownership lines.