

**Transfer Application Map**  
**Authorized Point of**  
**Appropriation**  
**Certificate 68545**  
Morrow County, Oregon  
Township 4 North and Range 25 East  
(W.M.)

**LEGEND**

- Authorized Point of Appropriation
- Tax Lot
- Government Lot (GL)
- Railroad
- Watercourse
- Waterbody

**POA LOCATION DESCRIPTION**

**Port Well 1 (MORR 752)**  
Located 130 feet North and 2,650 feet East from the West 1/4 corner of Section 10, Township 4 North, Range 25 East (W.M.)

**DISCLAIMER**

This map was prepared for the purpose of identifying the location of a water right only and it is not intended to provide legal dimensions or location of property ownership lines.

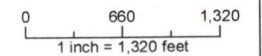







Date: February 14, 2022  
Data Sources: BLM, ESRI, OWRD, USGS, Morrow Co.





**Transfer Application Map  
Proposed Additional Points  
of Appropriation  
Certificate 68545**  
Morrow County, Oregon  
Township 4 North and Range 25 East  
(W.M.)

**LEGEND**

-  Proposed Additional Points of Appropriation
-  Tax Lot
-  Government Lot (GL)
-  Railroad
-  Watercourse
-  Waterbody

**POA LOCATION DESCRIPTION**

- Well A1** Located 390 feet South and 2,550 feet West from the NE Corner of Section 12, Township 4 North, Range 25 East (W.M.)
- Well A2** Located 370 feet South and 2,700 feet West from the NE Corner of Section 12, Township 4 North, Range 25 East (W.M.)
- Well B1** Located 2,390 feet South and 2,100 feet West from the NE Corner of Section 1, Township 4 North, Range 25 East (W.M.)
- Well B2** Located 2,410 feet South and 2,080 feet West from the NE Corner of Section 1, Township 4 North, Range 25 East (W.M.)
- Well C1** Located 1,410 feet South and 3,450 feet West from the NE Corner of Section 2, Township 4 North, Range 25 East (W.M.)
- Well C2** Located 1,430 feet South and 3,430 feet West from the NE Corner of Section 2, Township 4 North, Range 25 East (W.M.)
- Well D1** Located 2,950 feet South and 600 feet West from the NE Corner of Section 2, Township 4 North, Range 25 East (W.M.)
- Well D2** Located 2,970 feet South and 580 feet West from the NE Corner of Section 2, Township 4 North, Range 25 East (W.M.)

**DISCLAIMER**

This map was prepared for the purpose of identifying the location of a water right only and it is not intended to provide legal dimensions or location of property ownership lines.

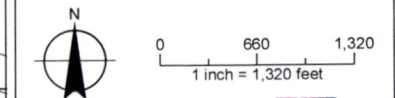

Date: February 14, 2022  
Data Sources: BLM, ESRI, OWRD,  
USGS, Morrow Co.

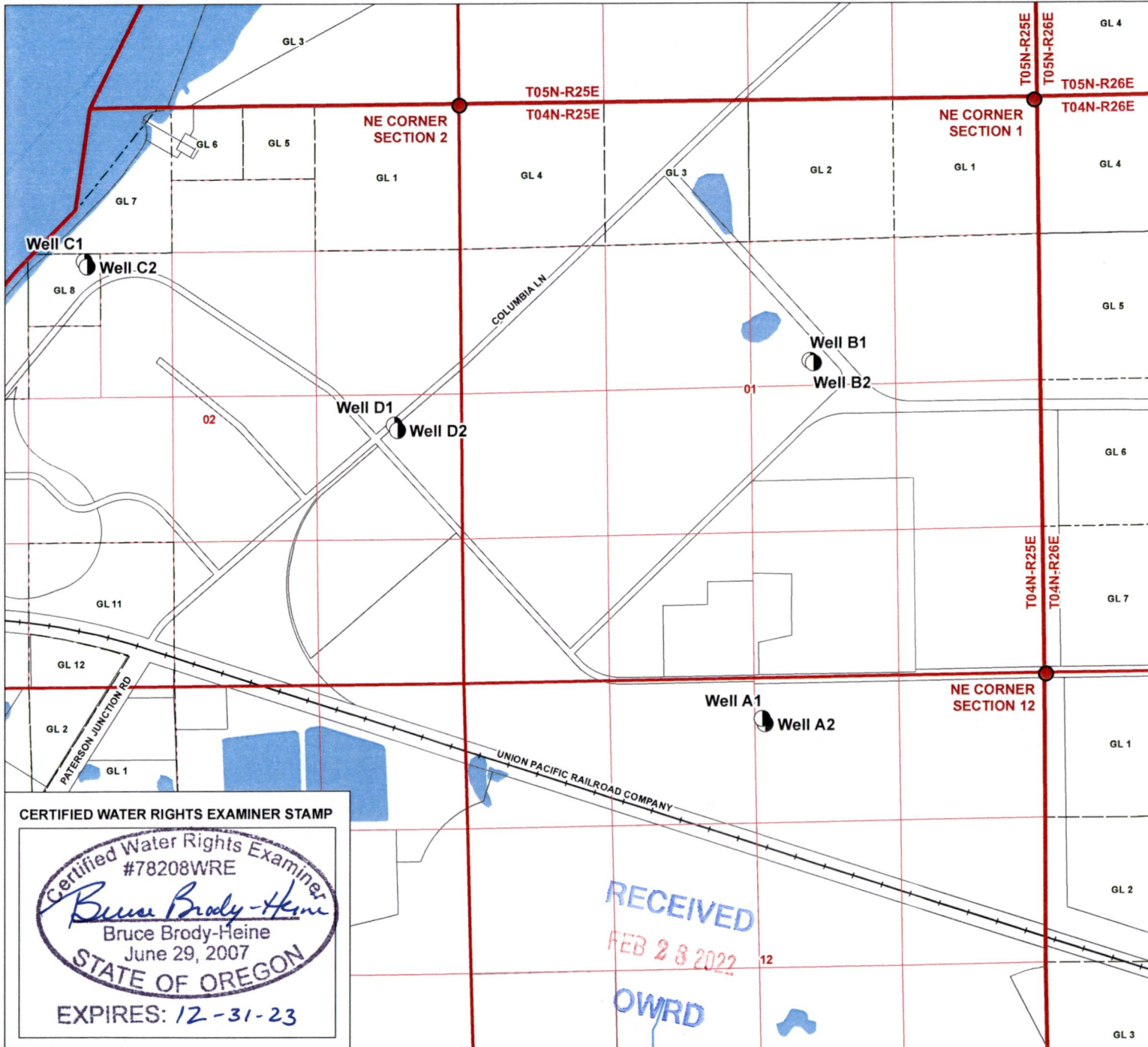

**CERTIFIED WATER RIGHTS EXAMINER STAMP**

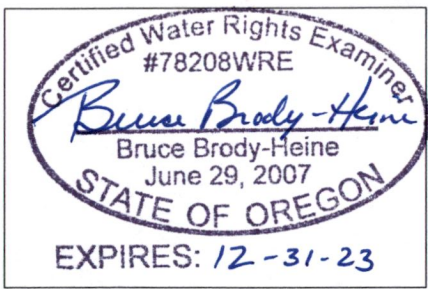



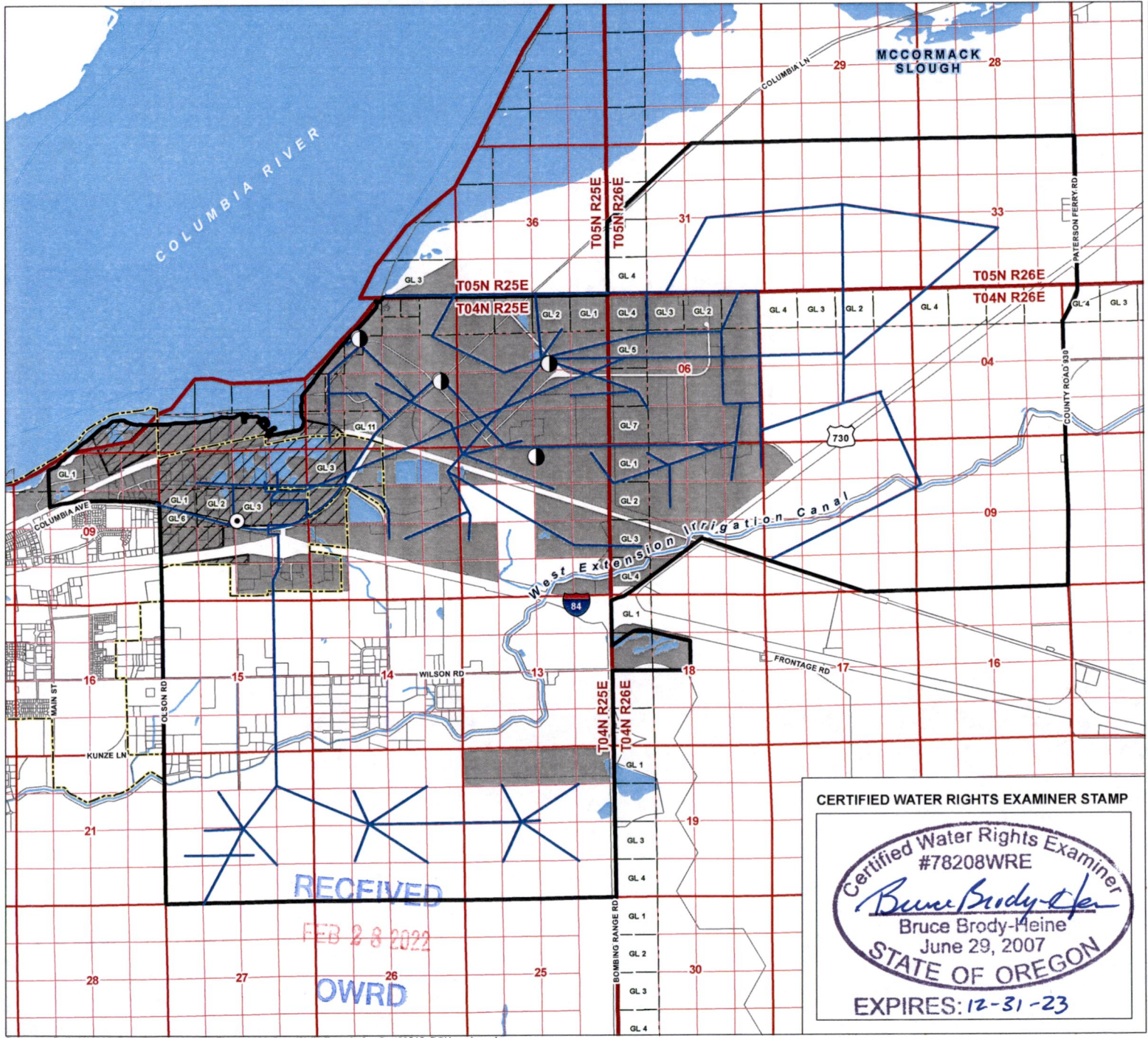

**Transfer Application Map  
Authorized and Proposed  
Industrial Place of Use  
Certificate 68545**  
Morrow County, Oregon  
Township 4 and 5 North, Range 25  
and 26 East (W.M.)

**LEGEND**

- ⊙ Authorized Point of Appropriation
- Proposed Point of Appropriation
- Pipeline
- Proposed Place of Use (POU) – Port Industrial Service Area
- ▨ Authorized Place of Use
- ▭ POM Industrial Park Boundary
- ▭ City of Boardman Boundary
- ▭ Tax Lot
- ▭ Government Lot (GL)
- ~ Watercourse
- Waterbody

**DISCLAIMER**

This map was prepared for the purpose of identifying the location of a water right only and it is not intended to provide legal dimensions or location of property ownership lines.

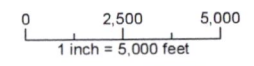

Date: February 15, 2022  
Data Sources: BLM, ESRI, OWRD,  
USGS, Morrow Co.





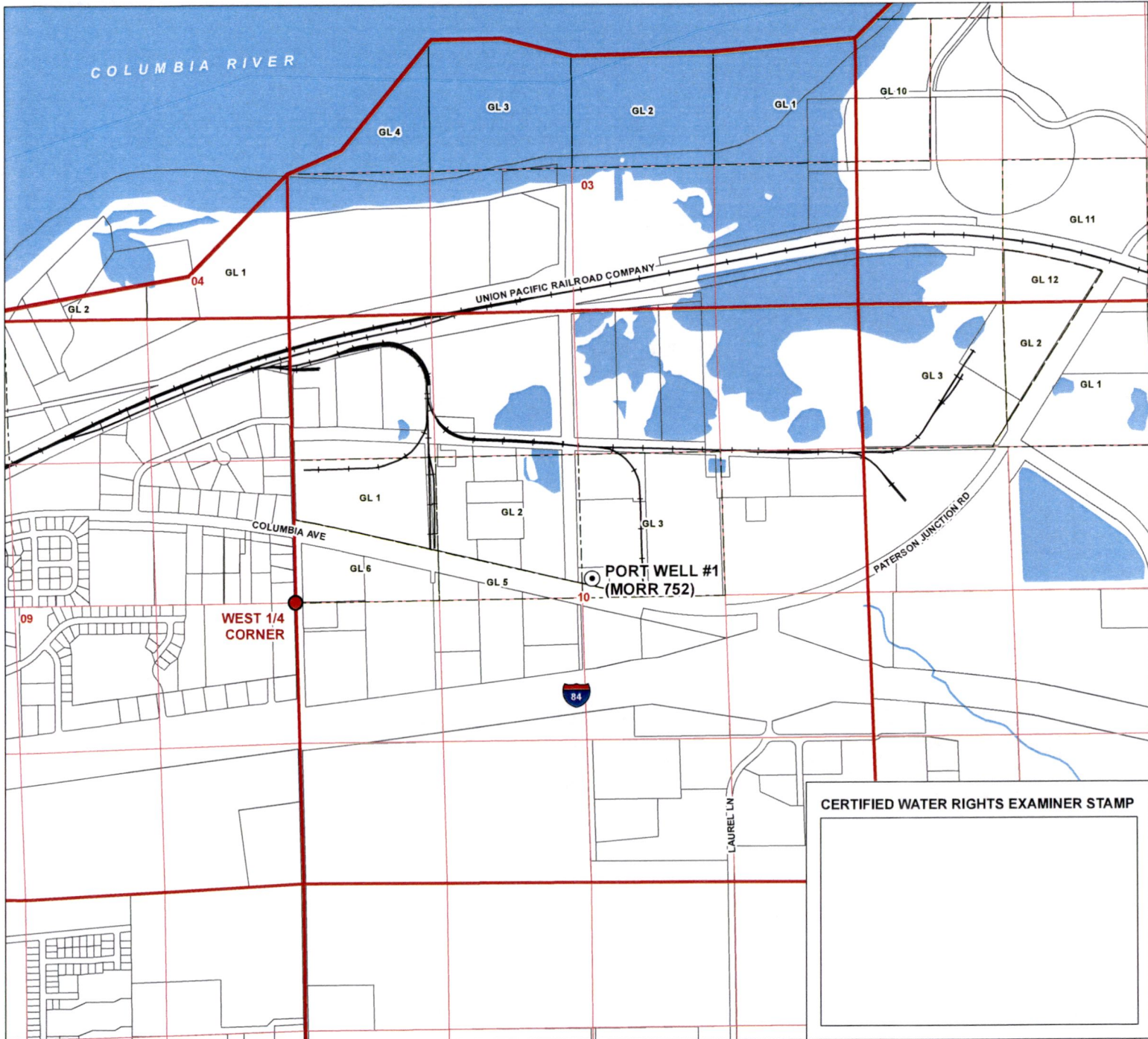

**Transfer Application Map  
Authorized Point of  
Appropriation  
Certificate 68545**  
Morrow County, Oregon  
Township 4 North and Range 25 East  
(W.M.)

- LEGEND**
- ⊙ Authorized Point of Appropriation
  - Tax Lot
  - Government Lot (GL)
  - Railroad
  - ~ Watercourse
  - Waterbody

RECEIVED  
FEB 28 2022  
OWRD

**POA LOCATION DESCRIPTION**  
**Port Well 1 (MORR 752)**  
Located 130 feet North and 2,650 feet East from  
the West 1/4 corner of Section 10, Township  
4 North, Range 25 East (W.M.)

**CERTIFIED WATER RIGHTS EXAMINER STAMP**

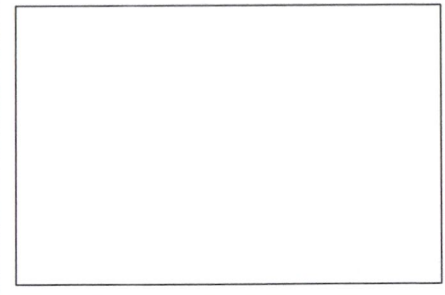

**DISCLAIMER**  
This map was prepared for the purpose of identifying the  
location of a water right only and it is not intended to provide  
legal dimensions or location of property ownership lines.

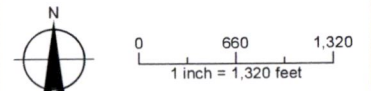

Date: February 14, 2022  
Data Sources: BLM, ESRI, OWRD,  
USGS, Morrow Co.











**Transfer Application Map  
Proposed Additional Points  
of Appropriation  
Certificate 68545**  
Morrow County, Oregon  
Township 4 North and Range 25 East  
(W.M.)

RECEIVED

FEB 28 2022

**LEGEND**

-  Proposed Additional Points of Appropriation
-  Tax Lot
-  Government Lot (GL)
-  Railroad
-  Watercourse
-  Waterbody

**POA LOCATION DESCRIPTION**

- Well A1** Located 390 feet South and 2,550 feet West from the NE Corner of Section 12, Township 4 North, Range 25 East (W.M.)
- Well A2** Located 370 feet South and 2,700 feet West from the NE Corner of Section 12, Township 4 North, Range 25 East (W.M.)
- Well B1** Located 2,390 feet South and 2,100 feet West from the NE Corner of Section 1, Township 4 North, Range 25 East (W.M.)
- Well B2** Located 2,410 feet South and 2,080 feet West from the NE Corner of Section 1, Township 4 North, Range 25 East (W.M.)
- Well C1** Located 1,410 feet South and 3,450 feet West from the NE Corner of Section 2, Township 4 North, Range 25 East (W.M.)
- Well C2** Located 1,430 feet South and 3,430 feet West from the NE Corner of Section 2, Township 4 North, Range 25 East (W.M.)
- Well D1** Located 2,950 feet South and 600 feet West from the NE Corner of Section 2, Township 4 North, Range 25 East (W.M.)
- Well D2** Located 2,970 feet South and 580 feet West from the NE Corner of Section 2, Township 4 North, Range 25 East (W.M.)

**DISCLAIMER**

This map was prepared for the purpose of identifying the location of a water right only and it is not intended to provide legal dimensions or location of property ownership lines.

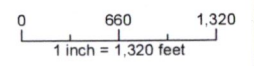
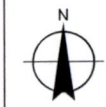

Date: February 14, 2022  
Data Sources: BLM, ESRI, OWRD,  
USGS, Morrow Co.

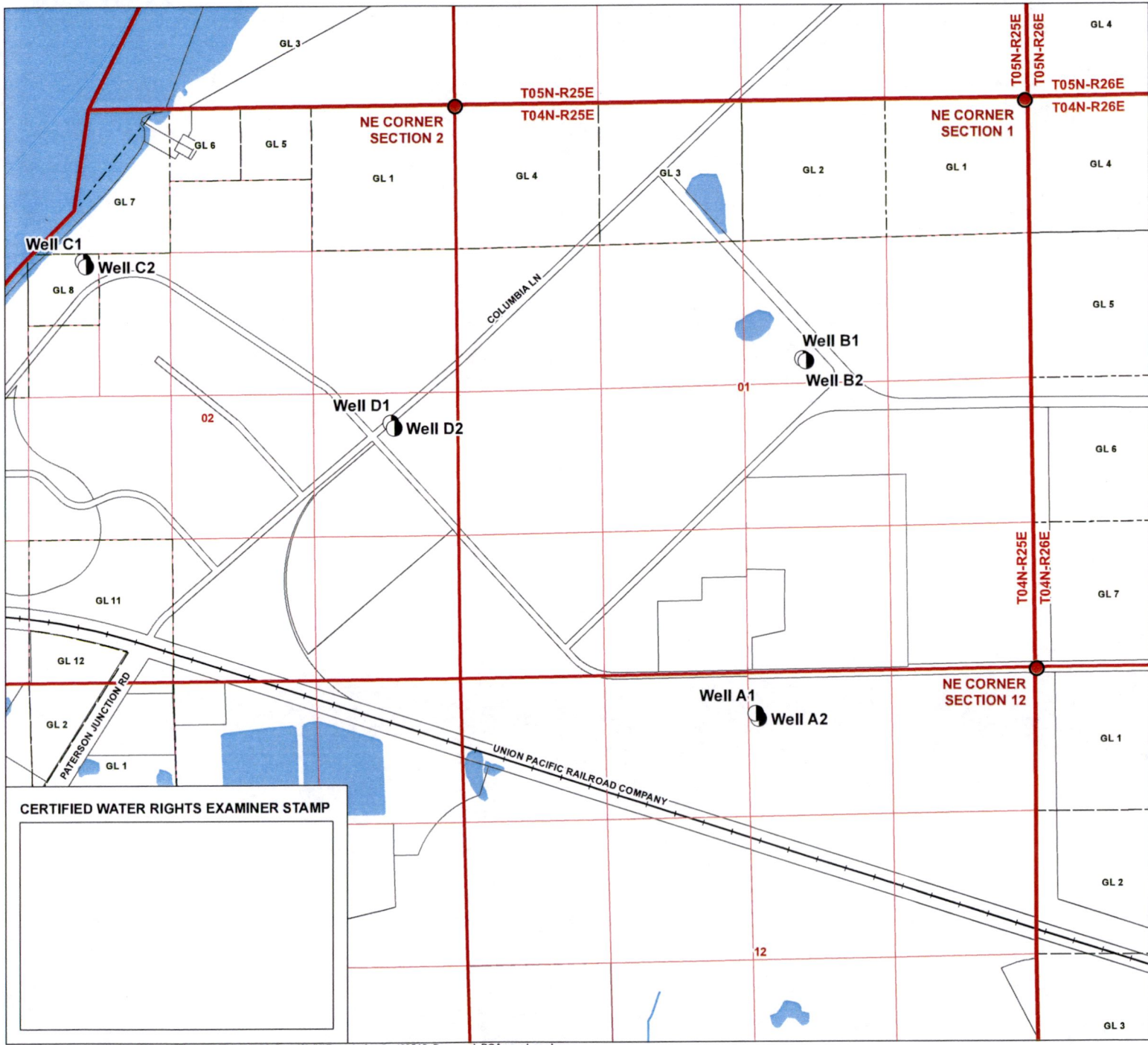

**CERTIFIED WATER RIGHTS EXAMINER STAMP**

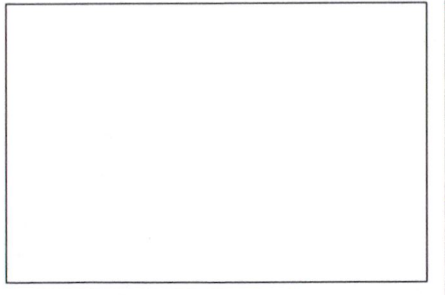



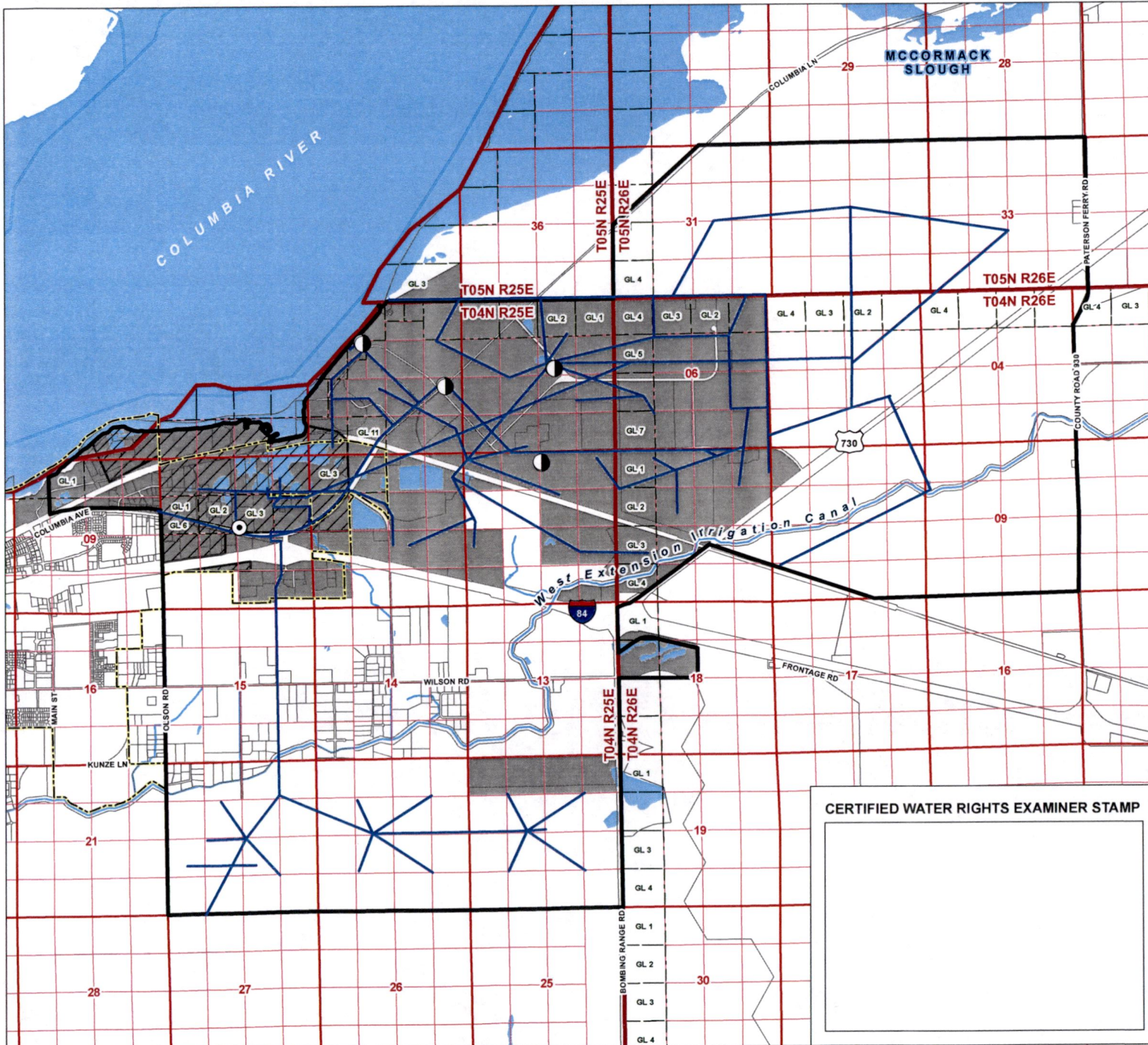

**Transfer Application Map  
Authorized and Proposed  
Industrial Place of Use  
Certificate 68545**

Morrow County, Oregon  
Township 4 and 5 North, Range 25  
and 26 East (W.M.)

**LEGEND**

- ⊙ Authorized Point of Appropriation
- Proposed Point of Appropriation
- Pipeline
- Proposed Place of Use (POU)  
- Port Industrial Service Area
- ▨ Authorized Place of Use
- ▭ POM Industrial Park Boundary
- ▭ City of Boardman Boundary
- ▭ Tax Lot
- ▭ Government Lot (GL)
- ~ Watercourse
- Waterbody

RECEIVED

FEB 28 2022

OWRD

**CERTIFIED WATER RIGHTS EXAMINER STAMP**

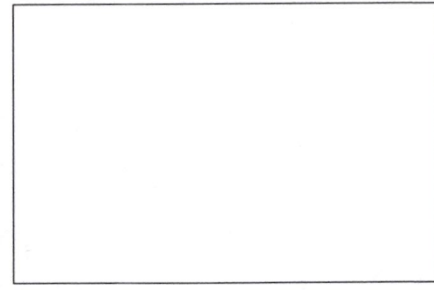

**DISCLAIMER**

This map was prepared for the purpose of identifying the location of a water right only and it is not intended to provide legal dimensions or location of property ownership lines.

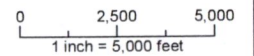

Date: February 15, 2022  
Data Sources: BLM, ESRI, OWRD,  
USGS, Morrow Co.





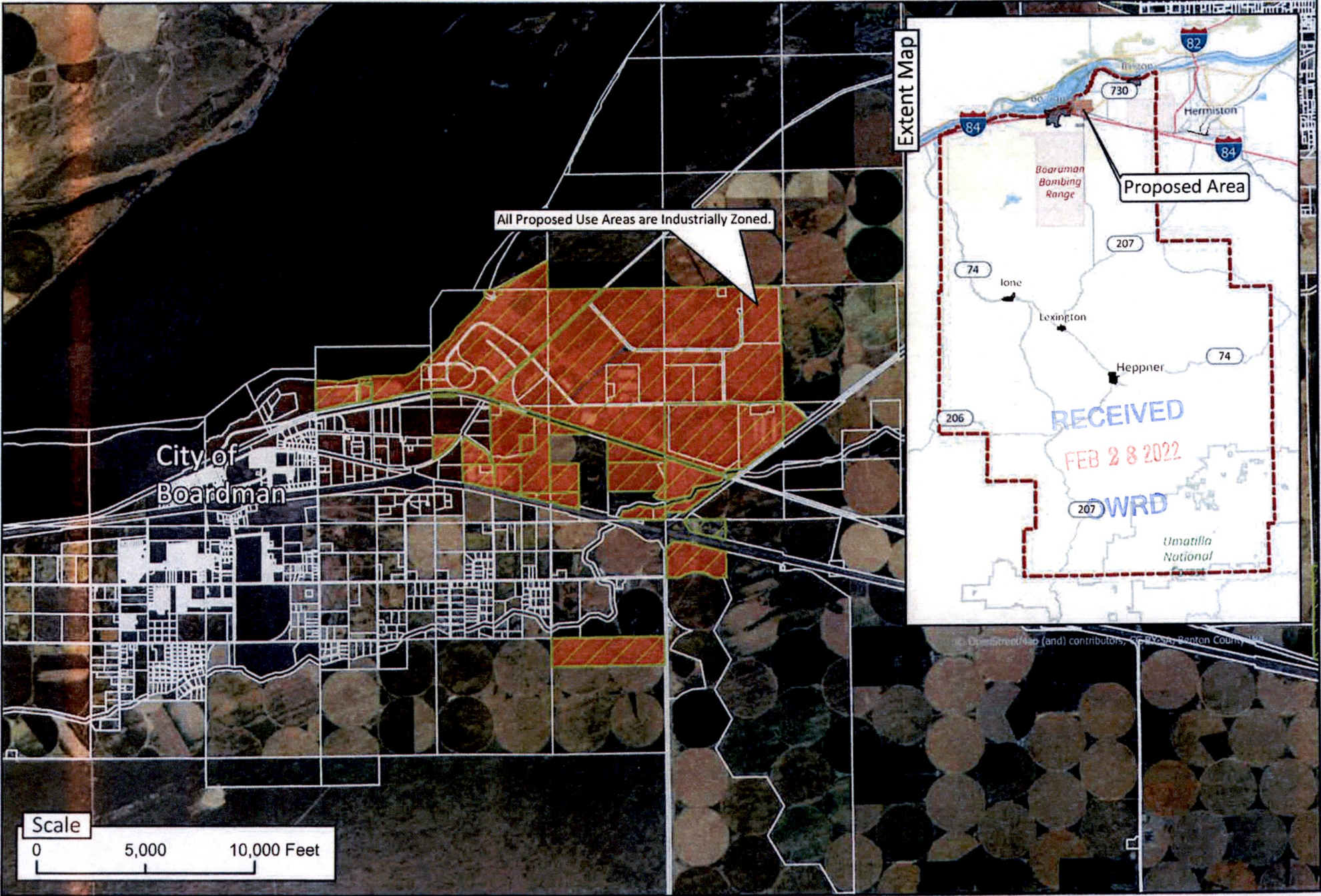

**DRAFT**

**Legend**

Tax Lot

Proposed Point of Use

Date Saved: 2/18/2022 6:10 PM

Cartography By: Stephen Wrecsics  
 Morrow County Planning Department  
 Coordinate System: NAD83 Oregon GIC Lambert ft  
 Datum: North American 1983  
 Projection: Lambert Conformal Conic



CORRECTED	OWNER	MAIL ADDRESS	CITY	STATE	ZIPCODE
4N25E03 100	USA (CORPS)				0
4N25E11 101	USA				0
4N25E11 1000	STATE OF OREGON	417 TRANSPORTATION BLDG	SALEM	OR	97310
4N25E11 202	COLUMBIA RIVER PROCESSING, INC	4185 HWY 101 N	TILLAMOOK	OR	97141
4N25E03 103	PORT OF MORROW	78888 WALTERS RD	MAUPIN	OR	97037
4N26E06 100	UMATILLA ELECTRIC COOPERATIVE	PO BOX 1148	HERMISTON	OR	97838
4N25E11 103	UMATILLA ELECTRIC COOPERATIVE	PO BOX 1148	HERMISTON	OR	97838
4N26E07 105	UMATILLA ELECTRIC COOP ASSOCIATION	PO BOX 1148	HERMISTON	OR	97838
4N25E02 106	UMATILLA ELECTRIC CO-OP	PO BOX 1148	HERMISTON	OR	97838
4N25E02 107	UMATILLA ELECTRIC CO-OP	PO BOX 1148	HERMISTON	OR	97838
4N25E02 109	UMATILLA ELECTRIC CO-OP	PO BOX 1148	HERMISTON	OR	97838
4N25E12 302	UMATILLA ELECTRIC COOPERATIVE ASSOCIATIO	PO BOX 1148	HERMISTON	OR	97838
4N25E11 700	UMATILLA ELECTRIC COOPERATIVE ASSOCIATIO	PO BOX 1148	HERMISTON	OR	97838
4N25E03 101	PORT OF MORROW	PO BOX 1210	VANCOUVER	WA	98666
4N25E01 100	PORT OF MORROW	PO BOX 200	BOARDMAN	OR	97818
4N25E11 100	PORT OF MORROW	PO BOX 200	BOARDMAN	OR	97818
4N25E02 100	PORT OF MORROW	PO BOX 200	BOARDMAN	OR	97818
4N26E07 100	PORT OF MORROW	PO BOX 200	BOARDMAN	OR	97818
4N26E06 101	PORT OF MORROW	PO BOX 200	BOARDMAN	OR	97818
4N25E02 102	PORT OF MORROW	PO BOX 200	BOARDMAN	OR	97818
4N25E12 102	PORT OF MORROW	PO BOX 200	BOARDMAN	OR	97818
4N25E03 102	PORT OF MORROW	PO BOX 200	BOARDMAN	OR	97818
4N26E06 102	PORT OF MORROW	PO BOX 200	BOARDMAN	OR	97818
4N25E12 103	PORT OF MORROW	PO BOX 200	BOARDMAN	OR	97818
4N26E06 103	PORT OF MORROW	PO BOX 200	BOARDMAN	OR	97818
4N26E06 104	PORT OF MORROW	PO BOX 200	BOARDMAN	OR	97818
4N25E12 105	PORT OF MORROW	PO BOX 200	BOARDMAN	OR	97818
4N25E12 106	PORT OF MORROW	PO BOX 200	BOARDMAN	OR	97818
4N25E03 108	PORT OF MORROW	PO BOX 200	BOARDMAN	OR	97818
4N25E11 1201	PORT OF MORROW	PO BOX 200	BOARDMAN	OR	97818
4N25E12 200	PORT OF MORROW	PO BOX 200	BOARDMAN	OR	97818
4N26E07 200	PORT OF MORROW	PO BOX 200	BOARDMAN	OR	97818
4N26E08 202	PORT OF MORROW	PO BOX 200	BOARDMAN	OR	97818
4N25E12 300	PORT OF MORROW	PO BOX 200	BOARDMAN	OR	97818
4N25E12 301	PORT OF MORROW	PO BOX 200	BOARDMAN	OR	97818
4N26E 4700	PORT OF MORROW	PO BOX 200	BOARDMAN	OR	97818
4N25E11 901	PORT OF MORROW	PO BOX 200	BOARDMAN	OR	97818
4N25E11 102	CITY OF BOARDMAN	PO BOX 229	BOARDMAN	OR	97818
4N25E12 400	CITY OF BOARDMAN	PO BOX 229	BOARDMAN	OR	97818
4N25E03 104	PORT OF MORROW	PO BOX 367	LEXINGTON	OR	97839
4N25E03 105	MORROW COUNTY GRAIN GROWERS INC ET AL	PO BOX 367	LEXINGTON	OR	97839

RECEIVED

Yellow = duplicate  
 S: / MAP REQUESTS / MAPS  
 FOR MABBA



4N25E02 108	MORROW COUNTY GRAIN GROWERS INC ET AL	PO BOX 367	LEXINGTON	OR	97839
4N25E02 105	COLUMBIA IMPROVEMENT DIST	PO BOX 47	BOARDMAN	OR	97818
4N25E02 104	FARMLAND RESERVE, INC	PO BOX 511196	SALT LAKE CITY	UT	84151
4N25E11 206	BOARDMAN FOODS, INC	PO BOX 786	BOARDMAN	OR	97818
4N25E01 102	AMAZON DATA SERVICES, INC	PO BOX 80416	SEATTLE	WA	98108
4N26E07 103	AMAZON DATA SERVICES, INC	PO BOX 80416	SEATTLE	WA	98108
4N26E06 105	AMAZON DATA SERVICES, INC	PO BOX 80416	SEATTLE	WA	98108
4N25E11 800	AMAZON DATA SERVICES, INC	PO BOX 80416	SEATTLE	WA	98108
4N25E03 107	PORT OF MORROW	PO BOX 820	BOARDMAN	OR	97818
4N26E07 102	UNITED STATES OF AMERICA	TERP-3 P.O. BOX 3621	PORTLAND	OR	97208

RECEIVED

FEB 28 2022

OWRD



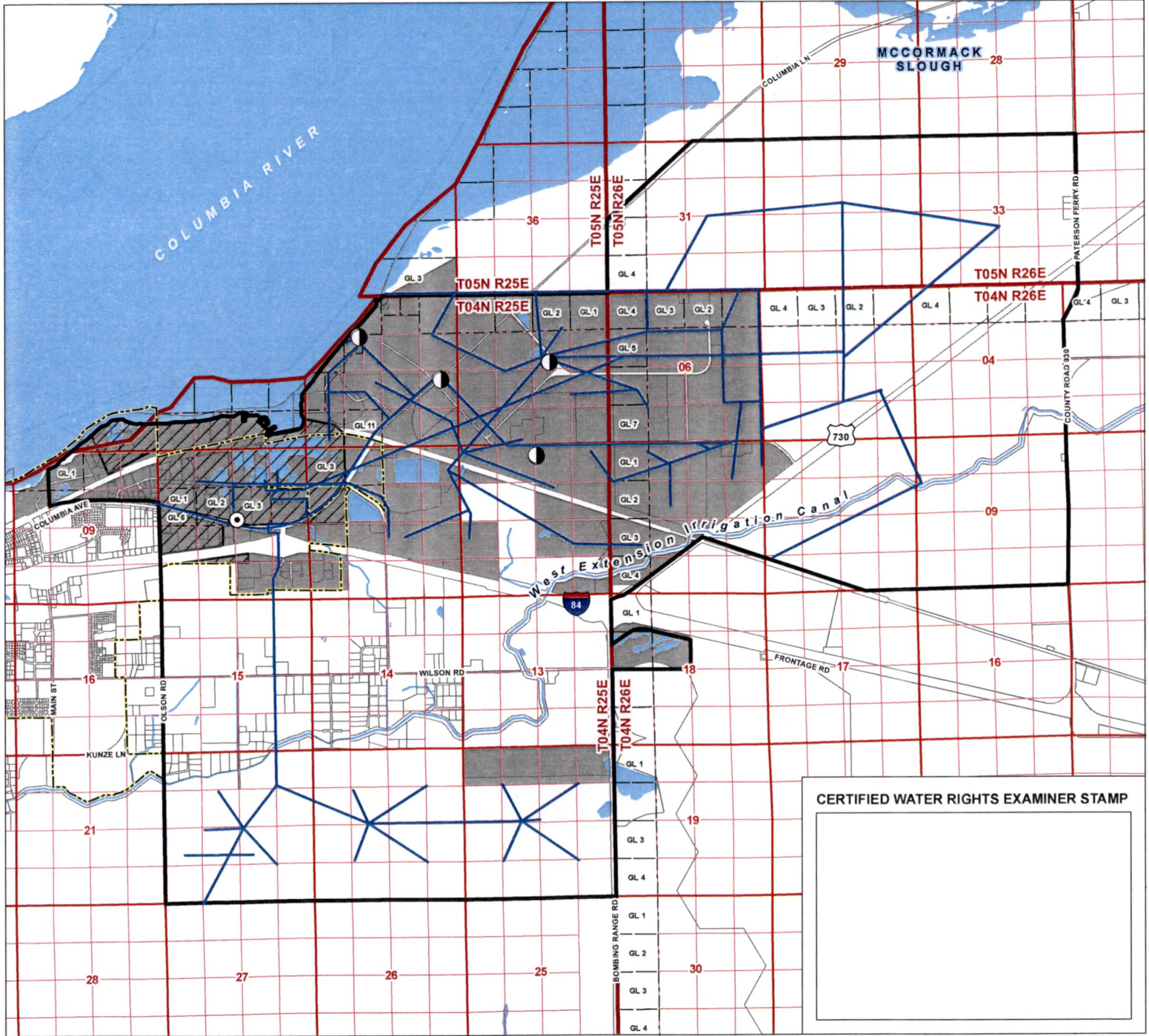

# Transfer Application Map Authorized and Proposed Industrial Place of Use Certificate 68545

Morrow County, Oregon  
Township 4 and 5 North, Range 25  
and 26 East (W.M.)

## LEGEND

- ⊙ Authorized Point of Appropriation
- Proposed Point of Appropriation
- Pipeline
- Proposed Place of Use (POU)  
– Port Industrial Service Area
- ▨ Authorized Place of Use
- ▭ POM Industrial Park Boundary
- ▭ City of Boardman Boundary
- ▭ Tax Lot
- ▭ Government Lot (GL)
- ~ Watercourse
- Waterbody

RECEIVED

FEB 23 2022

OWRD

### CERTIFIED WATER RIGHTS EXAMINER STAMP

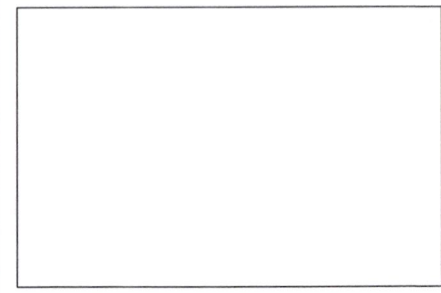

### DISCLAIMER

This map was prepared for the purpose of identifying the location of a water right only and it is not intended to provide legal dimensions or location of property ownership lines.

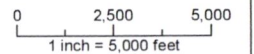

Date: February 15, 2022  
Data Sources: BLM, ESRI, OWRD,  
USGS, Morrow Co.





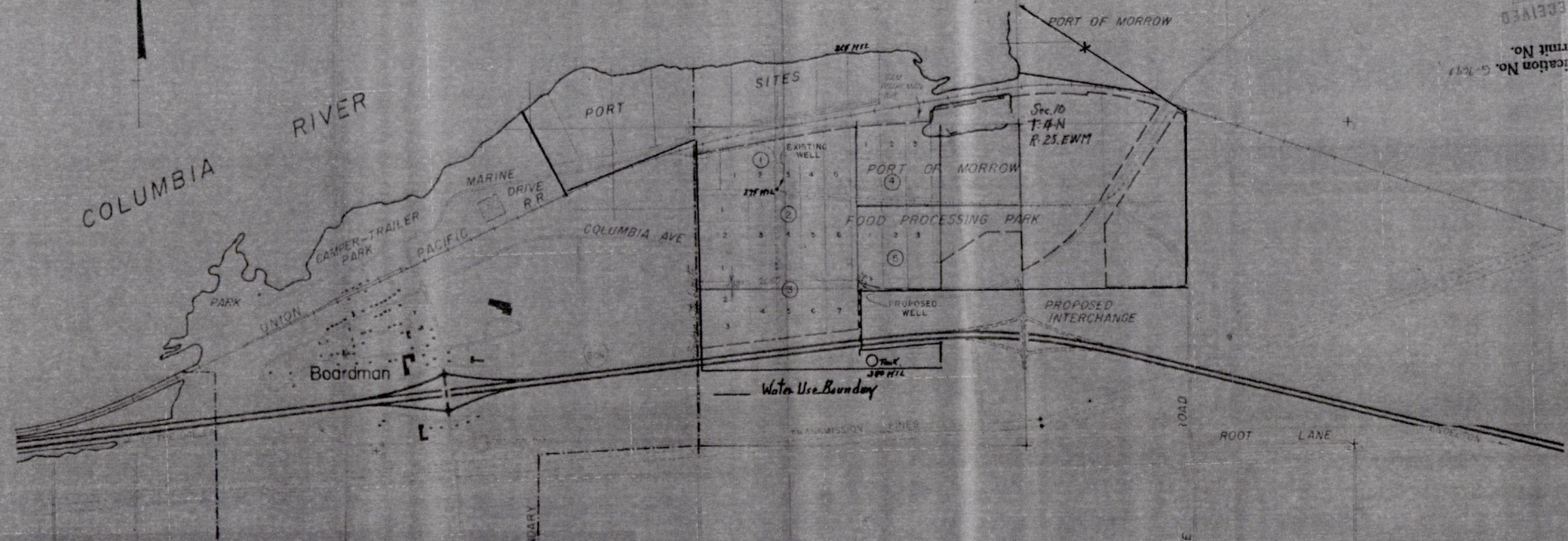

RECEIVED  
 Application No. G-7698  
 Permit No. G-7159

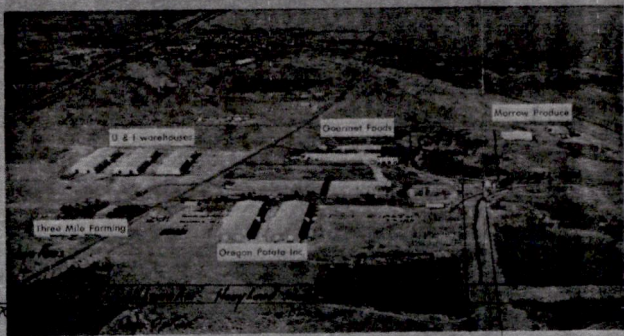

There are 345 million worth of plants located in the Port of Morrow and surrounding park on the waters of Boardman (top center). The park has two fresh produce packing plants, a French fry plant, a frozen french fries plant, a farm handicrafts and two large peach storage warehouses. Rippee, Kennedy, and Stange.



If the Port of Morrow food processing park) keeps growing, Port Manager Rippee Kennedy (right) said he'd like to build another sign board.

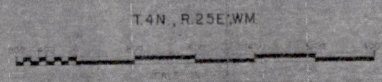

PORT OF MORROW  
 PROPOSED WATERWELL  
 LOCATION  
 MORROW COUNTY OREGON  
 SCALE 1" = 800' JANUARY 1977

Application No. G-7698  
 Permit No. G-7159

RECEIVED  
 WITH PLANNING DEPT  
 ENGINEERING



STORCH CORPORATION / ENGINEERS

RECEIVED

FEB 23 2022

OWRD

Application No. G-7698  
 Permit No. G-7159  
 1 MARINE DRIVE - BOARDMAN, OREGON - (503) 481-2895

Other Participants: Earl Doolittle, Vice President; Jack Carlson, Secretary; Lawrence Lindley, Treasurer; Duane St. West, Commissioner; Robert W. Kennedy, Coordinator