

MAR 22 2022

Salem, OR

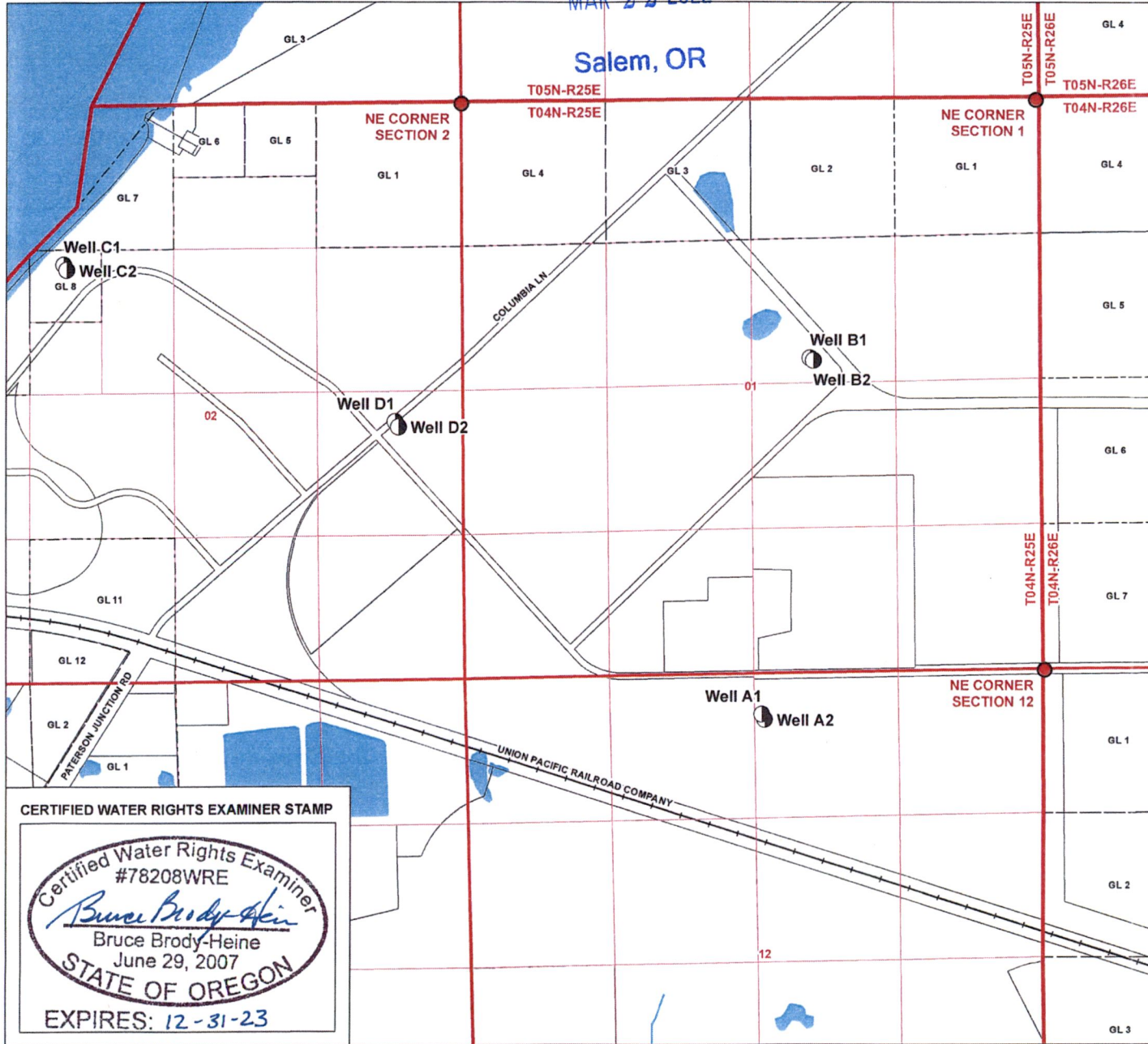

**Transfer Application Map
Proposed Additional Points
of Appropriation
Certificate 68545**

Morrow County, Oregon
Township 4 North and Range 25 East
(W.M.)

LEGEND

- Proposed Additional Points of Appropriation
- Tax Lot
- Government Lot (GL)
- Railroad
- Watercourse
- Waterbody

POA LOCATION DESCRIPTION

- Well A1** Located 390 feet South and 2,550 feet West from the NE Corner of Section 12, Township 4 North, Range 25 East (W.M.)
- Well A2** Located 370 feet South and 2,700 feet West from the NE Corner of Section 12, Township 4 North, Range 25 East (W.M.)
- Well B1** Located 2,390 feet South and 2,100 feet West from the NE Corner of Section 1, Township 4 North, Range 25 East (W.M.)
- Well B2** Located 2,410 feet South and 2,080 feet West from the NE Corner of Section 1, Township 4 North, Range 25 East (W.M.)
- Well C1** Located 1,485 feet South and 3,650 feet West from the NE Corner of Section 2, Township 4 North, Range 25 East (W.M.)
- Well C2** Located 1,540 feet South and 3,625 feet West from the NE Corner of Section 2, Township 4 North, Range 25 East (W.M.)
- Well D1** Located 2,950 feet South and 600 feet West from the NE Corner of Section 2, Township 4 North, Range 25 East (W.M.)
- Well D2** Located 2,970 feet South and 580 feet West from the NE Corner of Section 2, Township 4 North, Range 25 East (W.M.)

DISCLAIMER

This map was prepared for the purpose of identifying the location of a water right only and it is not intended to provide legal dimensions or location of property ownership lines.

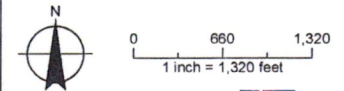

Date: March 22, 2022
Data Sources: BLM, ESRI, OWRD, USGS, Morrow Co.



CERTIFIED WATER RIGHTS EXAMINER STAMP

