

AUTHORIZED POINT OF DIVERSION: NORTH 76 DEGREES 45 MINUTES 56 SECONDS EAST;
 2913.19 FEET FROM THE W 1/4 CORNER OF SECTION 21

LEGEND

- SECTION LINES
- TAX LOT LINES
- - - - - BURIED PIPELINE
- UMATILLA RIVER
- TL 100 TAX LOT NUMBERS

13955

Township 3 North, Range 29 East, W.M.
Section 21
UMATILLA COUNTY

RECEIVED
MAR 28 2022

POINT OF DIVERSION
WESTLAND IRRIGATION DISTRICT

THIS MAP WAS PREPARED FOR THE PURPOSE OF IDENTIFYING THE LOCATION OF A WATER RIGHT ONLY AND IS NOT INTENDED TO PROVIDE LEGAL DIMENSIONS OR LOCATION OF PROPERTY OWNERSHIP LINES.

DAVID CORREA 2022 1 YEAR TEMPORARY TRANSFER

MAP 3 OF 3
UMATILLA COUNTY
T3N, R29E, WM

RECEIVED

MAR 28 2022

OWRD

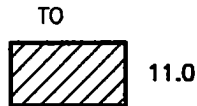
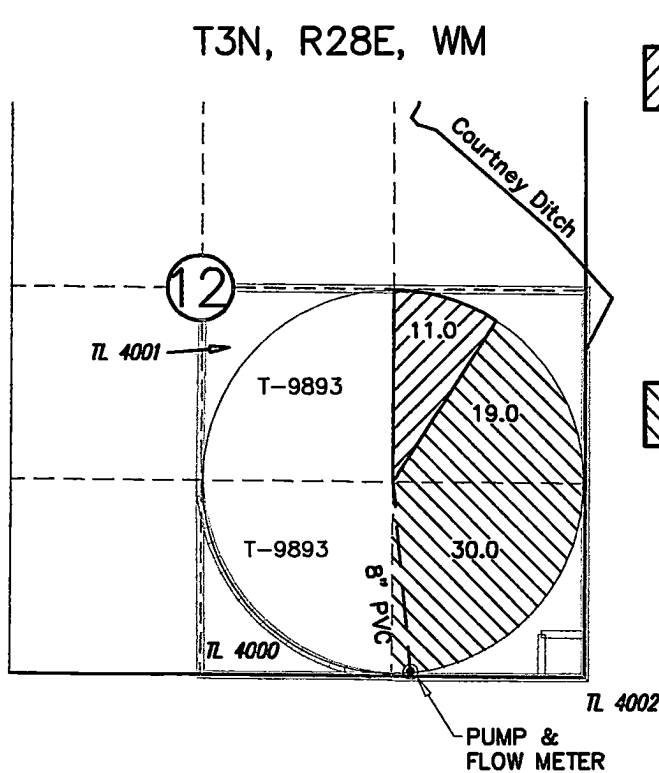

ALLAN DITCH CO.
UMATILLA RIVER DECREE VOL 3
PAGE 195 IN THE NAME OF
FRED ANDREWS, 12/31/1870

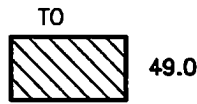

PIONEER IRRIGATION CO.
UMATILLA RIVER DECREE VOL 3
PAGE 239 IN THE NAME OF
B.F. McCULLOUGH, 01/09/1900
UMATILLA RIVER DECREE VOL 15
PAGE 432 IN THE NAME OF
FRANK CORREA SR, 01/09/1900
UMATILLA RIVER DECREE VOL 3
PAGE 239 IN THE NAME OF
ELMER REEVES, 01/09/1900
UMATILLA RIVER DECREE VOL 15
PAGE 240 IN THE NAME OF
GEO. WARD, 01/09/1900

T.3N., R.29E., W.M.

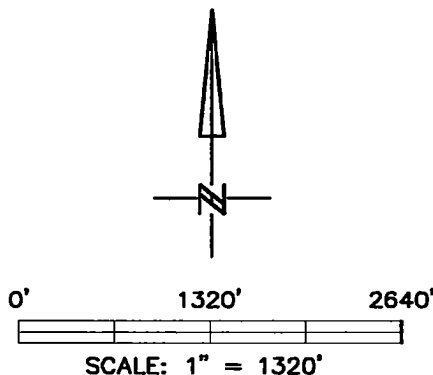
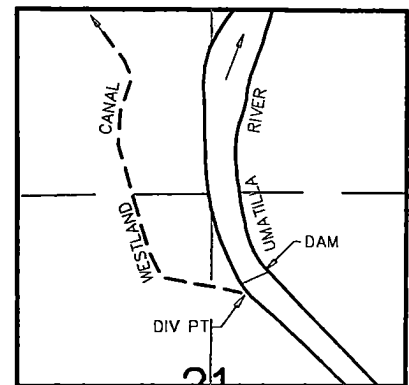

DIV PT LCT N.76°45'56"E. 2913.19' FROM W.1/4 COR. SEC 21

13955

NOTE:
THE PURPOSE OF THIS MAP IS TO IDENTIFY THE APPROXIMATE LOCATION OF THE WATER RIGHT. IT IS NOT INTENDED TO PROVIDE INFORMATION RELATIVE TO THE LOCATION OF PROPERTY OWNERSHIP BOUNDARY LINES.

RECEIVED

MAR 28 2022

OWRD

DAVID CORREA (MILLS TO CORREA) 2022 1 YEAR TEMPORARY TRANSFER

MAP 2 OF 3
UMATILLA COUNTY
T3N, R29E, WM

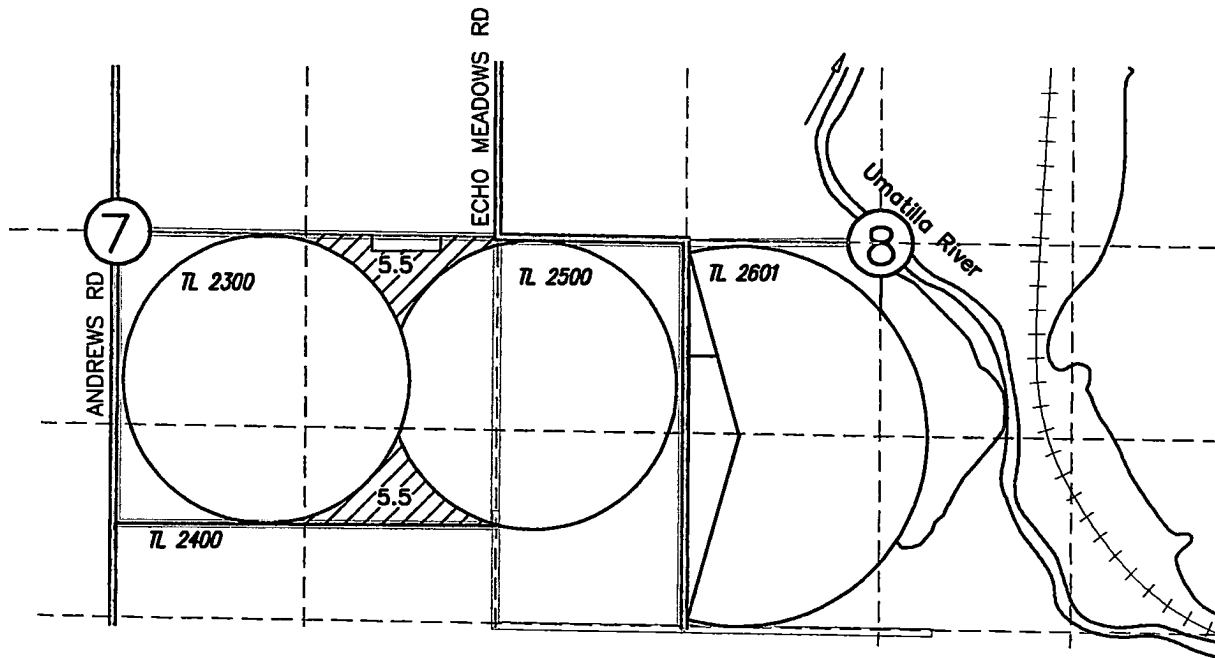

FROM



11.0

ALLAN DITCH CO

UMATILLA RIVER DECREE VOL 3
PAGE 195 IN THE NAME OF
FRED ANDREWS, 12/31/1870

T.3N., R.29E., W.M.

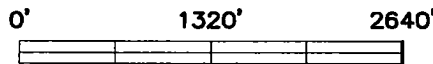

SCALE: 1" = 1320'

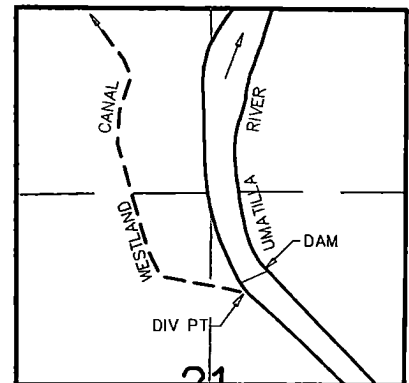

21

DIV PT LCT N.76°45'56"E. 2913.19' FROM W.1/4 COR. SEC 21

NOTE:

THE PURPOSE OF THIS MAP IS TO IDENTIFY THE APPROXIMATE LOCATION OF THE WATER RIGHT. IT IS NOT INTENDED TO PROVIDE INFORMATION RELATIVE TO THE LOCATION OF PROPERTY OWNERSHIP BOUNDARY LINES.

12955

DAVID CORREA

2022 1 YEAR TEMPORARY TRANSFER

MAP 1 OF 3

UMATILLA COUNTY

RECEIVED

MAR 28 2022

OWRD



PIONEER IRRIGATION CO.
UMATILLA RIVER DECREE VOL 3
PAGE 239 IN THE NAME OF
B.F. McCULLOUGH, 01/09/1900
UMATILLA RIVER DECREE VOL 15
PAGE 432 IN THE NAME OF
FRANK CORREA SR, 01/09/1900
UMATILLA RIVER DECREE VOL 3
PAGE 239 IN THE NAME OF
ELMER REEVES, 01/09/1900
UMATILLA RIVER DECREE VOL 15
PAGE 240 IN THE NAME OF
GEO. WARD, 01/09/1900

T3N, R29E, WM
CORREA TO CORREA

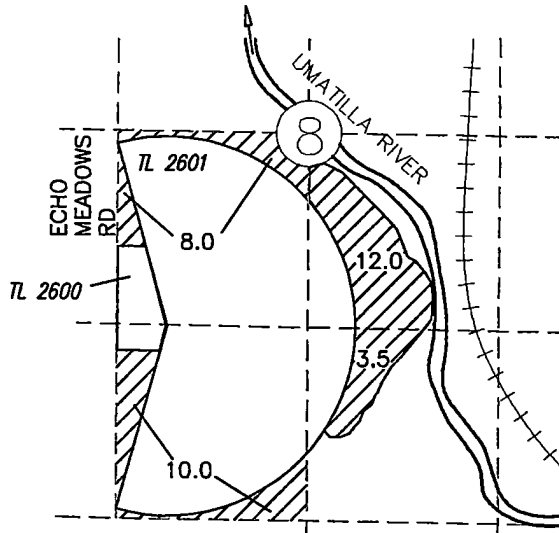

T4N, R29E, WM
EMERT TO CORREA

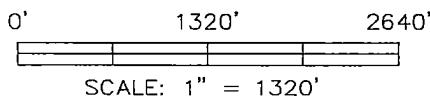
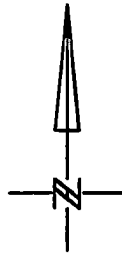
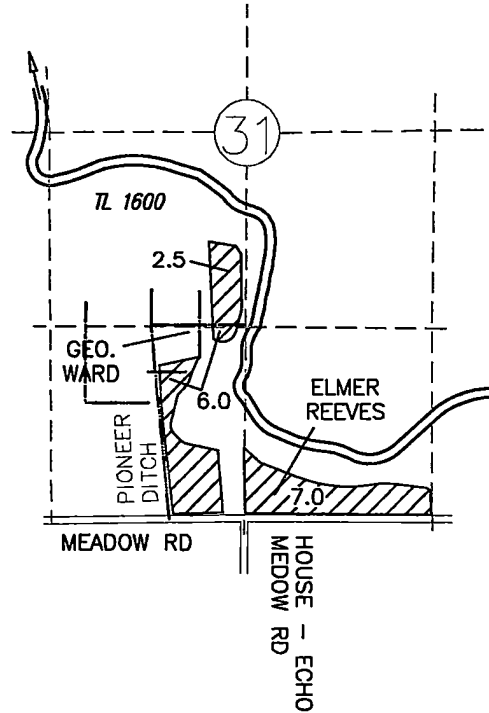

13955

NOTE:
THE PURPOSE OF THIS MAP IS TO IDENTIFY THE APPROXIMATE LOCATION
OF THE WATER RIGHT. IT IS NOT INTENDED TO PROVIDE INFORMATION
RELATIVE TO THE LOCATION OF PROPERTY OWNERSHIP BOUNDARY LINES.

DRAWING: \\KWKFILES\Public\Project\30-08-016 - Porfily Water Rights Consulting\00 Misc Engineering\Cad\correa\30-08-016 CORR BEAR 2020 1-3.dwg
PRINTED BY: kvaidovinos on 02/22/22 01:38 PM