

LOCATION DESCRIPTION

Authorized PODs

POD 1: Located 2,130 feet South and 260 feet West from the NW corner of Snowden DLC 68, Township 3 South, Range 2 West (W.M.)
POD 2: Located 1,630 feet South and 1,400 feet West from the NW corner of Snowden DLC 68, Township 3 South, Range 2 West (W.M.)

Proposed Additional PODs

POD 3 (Location A): Located 2,290 feet South and 130 feet West from the NW corner of Snowden DLC 68, Township 3 South, Range 2 West (W.M.)
POD 3 (Location B): Located 2,720 feet South and 300 feet East from the NW corner of Snowden DLC 68, Township 3 South, Range 2 West (W.M.)

NOTE

The proposed new point of diversion, POD 3, will be located between POD 3 (Location A) and POD 3 (Location B).

CERTIFIED WATER RIGHTS EXAMINER STAMP

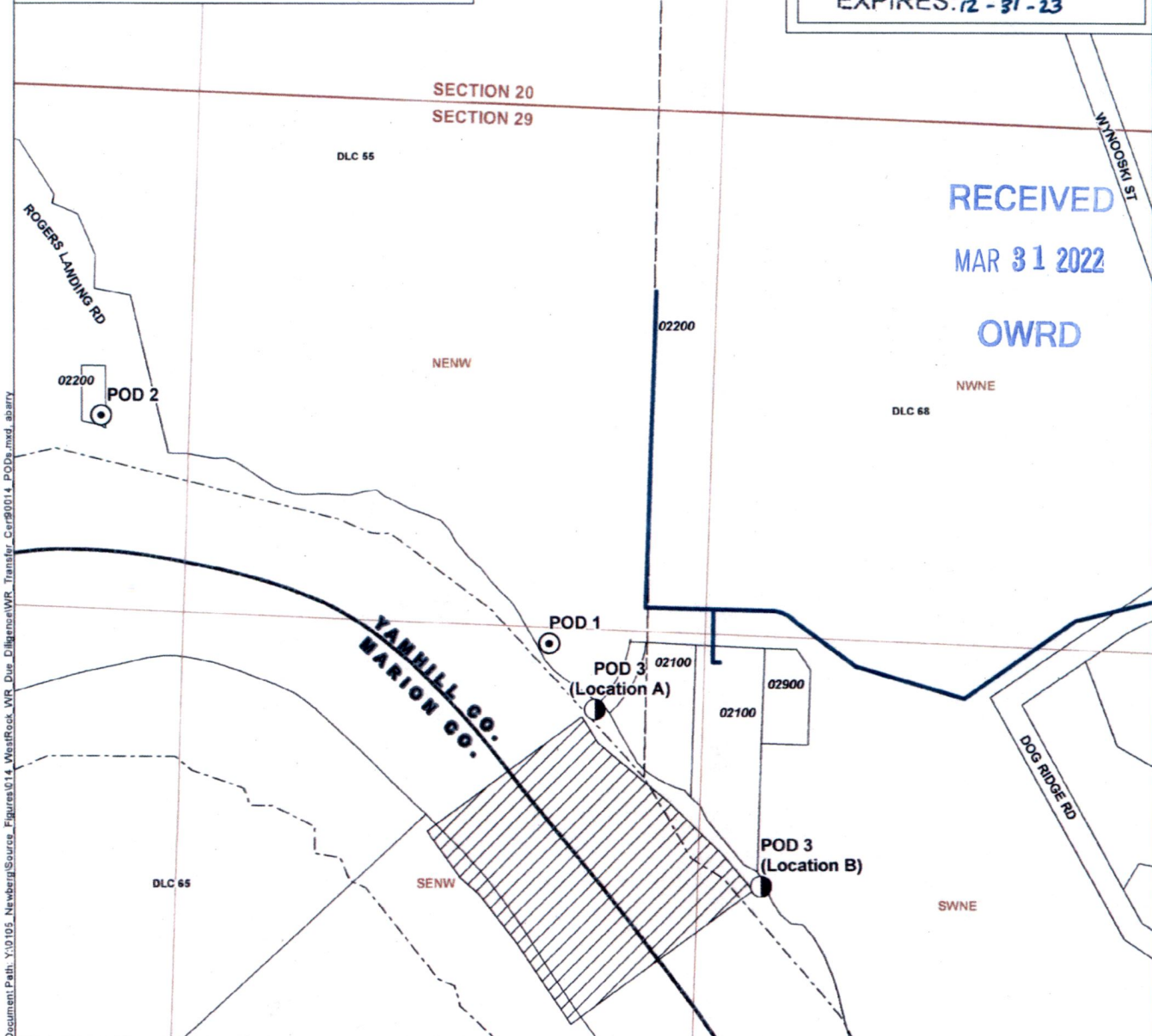

LEGEND

- | | | |
|--------------------------|---------------------------|-----------------|
| Point of Diversion (POD) | Conveyance | City Boundary |
| Authorized | Proposed Diversion Area | County Boundary |
| Proposed Additional | Donation Land Claim (DLC) | Watercourse |
| | Tax Lot | Waterbody |

Application for a Permanent Water Right Transfer in the Name of WestRock Northwest, LLC Authorized and Proposed Additional Points of Diversion Map

Certificate 90014

Yamhill County
Township 3 South, Range 2 West (W.M.)

DISCLAIMER

This map was prepared for the purpose of identifying the location of a water right only and it is not intended to provide legal dimensions or location of property ownership lines.
 Date: March 21, 2022
 Data Sources: BLM, ESRI, OWRD, USGS, Yamhill Co., Marion Co., City of Newberg

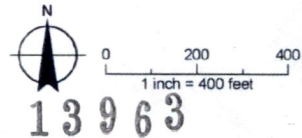

13963

Document Path: Y:\0105 Newberg\Source_Figures\014 WestRock_WR Due Diligence\WR_Transfer_Cert90014_PODs.mxd, aberry

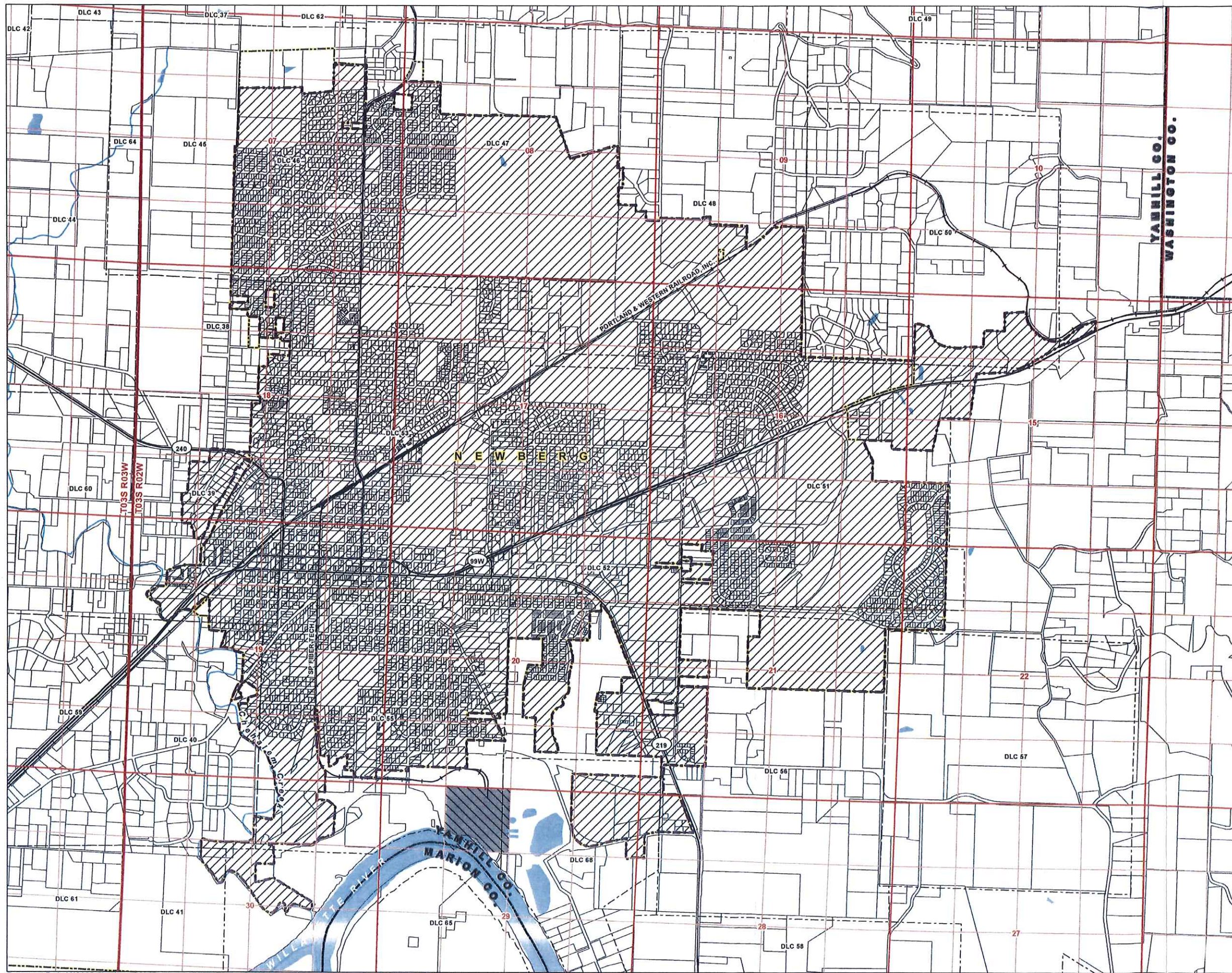

**Application for a Permanent
Water Right Transfer
in the Name of WestRock
Northwest, LLC
Authorized and Proposed
Place of Use Map
Certificate 90014
Yamhill County
Township 3 South,
Range 2 West (W.M.)**

LEGEND

- Authorized Place of Use (POU)
- Proposed Place of Use (POU)
- City Service Area
- Donation Land Claim (DLC)
- Tax Lot
- County Boundary
- City Boundary
- Railroad
- Major Road
- Watercourse
- Waterbody

RECEIVED
MAR 31 2022
OWRD

CERTIFIED WATER RIGHTS EXAMINER STAMP



DISCLAIMER

This map was prepared for the purpose of identifying the location of a water right only and it is not intended to provide legal dimensions or location of property ownership lines.

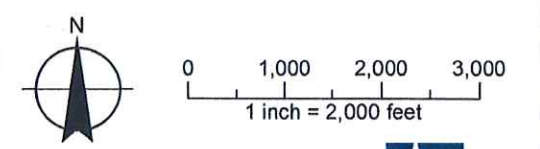





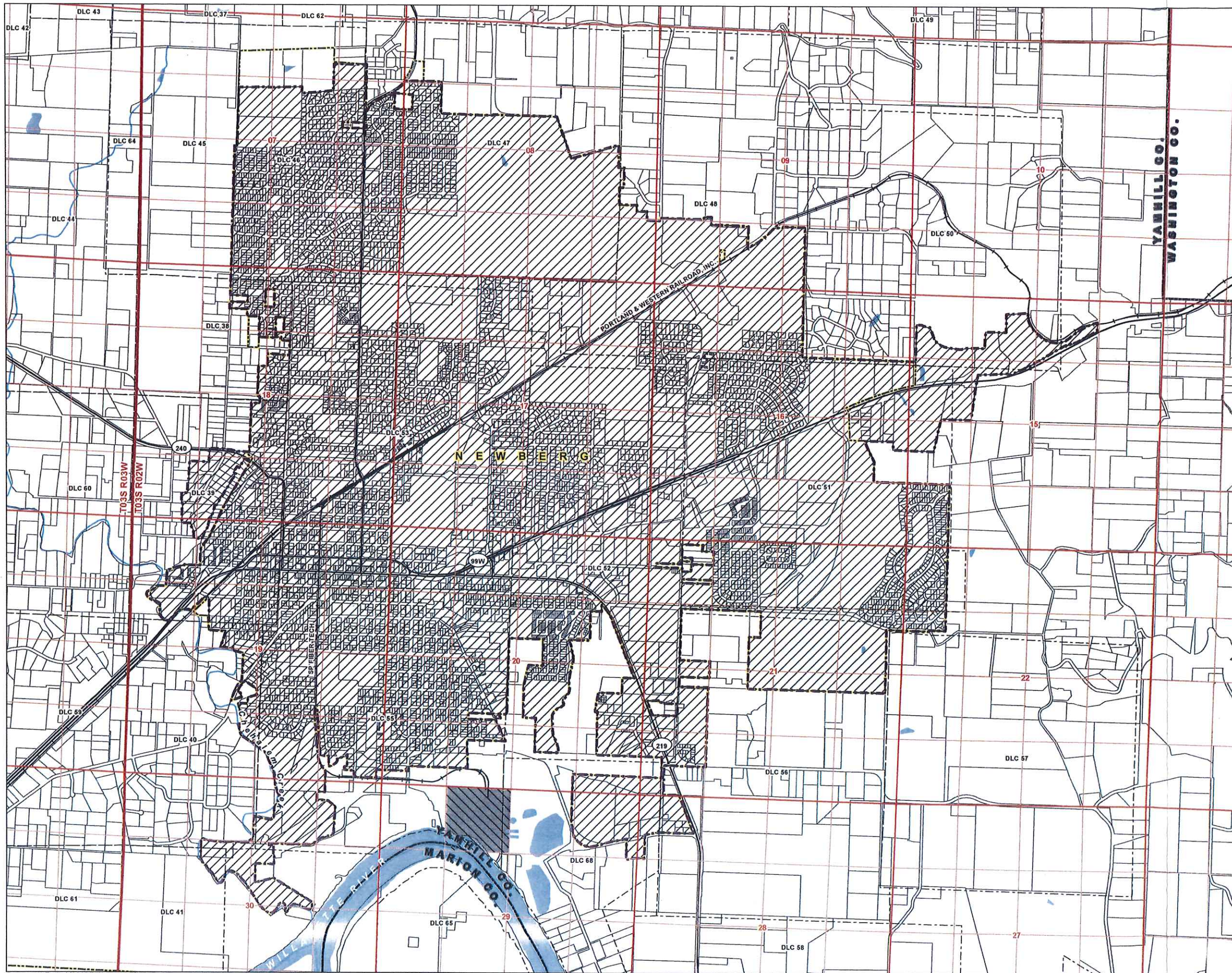





Date: March 21, 2022
Data Sources: BLM, ESRI, OWRD, USGS,
Yamhill Co., Marion Co., City of Newberg





**Application for a Permanent
Water Right Transfer
in the Name of WestRock
Northwest, LLC
Authorized and Proposed
Place of Use Map
Certificate 90014
Yamhill County
Township 3 South,
Range 2 West (W.M.)**

LEGEND

-  Authorized Place of Use (POU)
-  Proposed Place of Use (POU)
-  City Service Area
-  Donation Land Claim (DLC)
-  Tax Lot
-  County Boundary
-  City Boundary
-  Railroad
-  Major Road
-  Watercourse
-  Waterbody

RECEIVED
MAR 31 2022
OWRD

CERTIFIED WATER RIGHTS EXAMINER STAMP

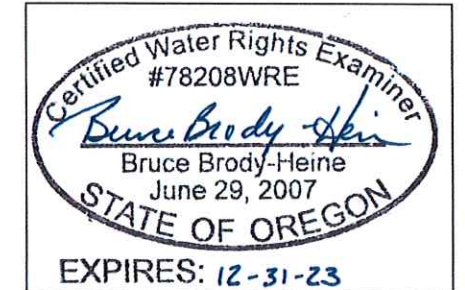

DISCLAIMER

This map was prepared for the purpose of identifying the location of a water right only and it is not intended to provide legal dimensions or location of property ownership lines.

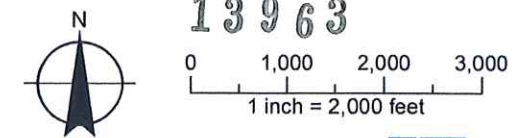

Date: March 21, 2022
Data Sources: BLM, ESRI, OWRD, USGS,
Yamhill Co., Marion Co., City of Newberg

