

- LEGEND**
- Authorized Point of Appropriation (POA)
 - Additional POA
 - ▨ Authorized Place of Use
 - ▭ Sections
 - ▭ Quarter Quarter Sections
 - ▭ Donation Land Claims (DLCs)
 - ▭ Government Lots (GLs)
 - ▭ Tax Lots
 - ~ Mainline (Approximate)
 - ~ Watercourse

POA Location Descriptions

Well #1 (POLK-1786):
South 3 degrees, 12 minutes East 2308 feet from the NW 18

Well #2 (POLK-1787):
South 5 degrees, 14 minutes East 2412 feet from the NW 18

Lafayette Well (POLK-1789):
North 62 degrees, 54 minutes east, 780 feet from W quarter Section 18



Disclaimer:
This map was prepared for the purpose of identifying the location of a water right only and is not intended to show legal dimensions or location of property ownership.



Data Sources: Polk County, OWRD, USGS, BLM
Date: 10/10/2022

Application for a Permanent Water Right Transfer Certificate

A Water Right in the Name of
Orchard Heights Water Association

Township 7S, Range 3W, Section 18
Township 7S, Range 4W, Sections 17, 18, 19, 20, 21



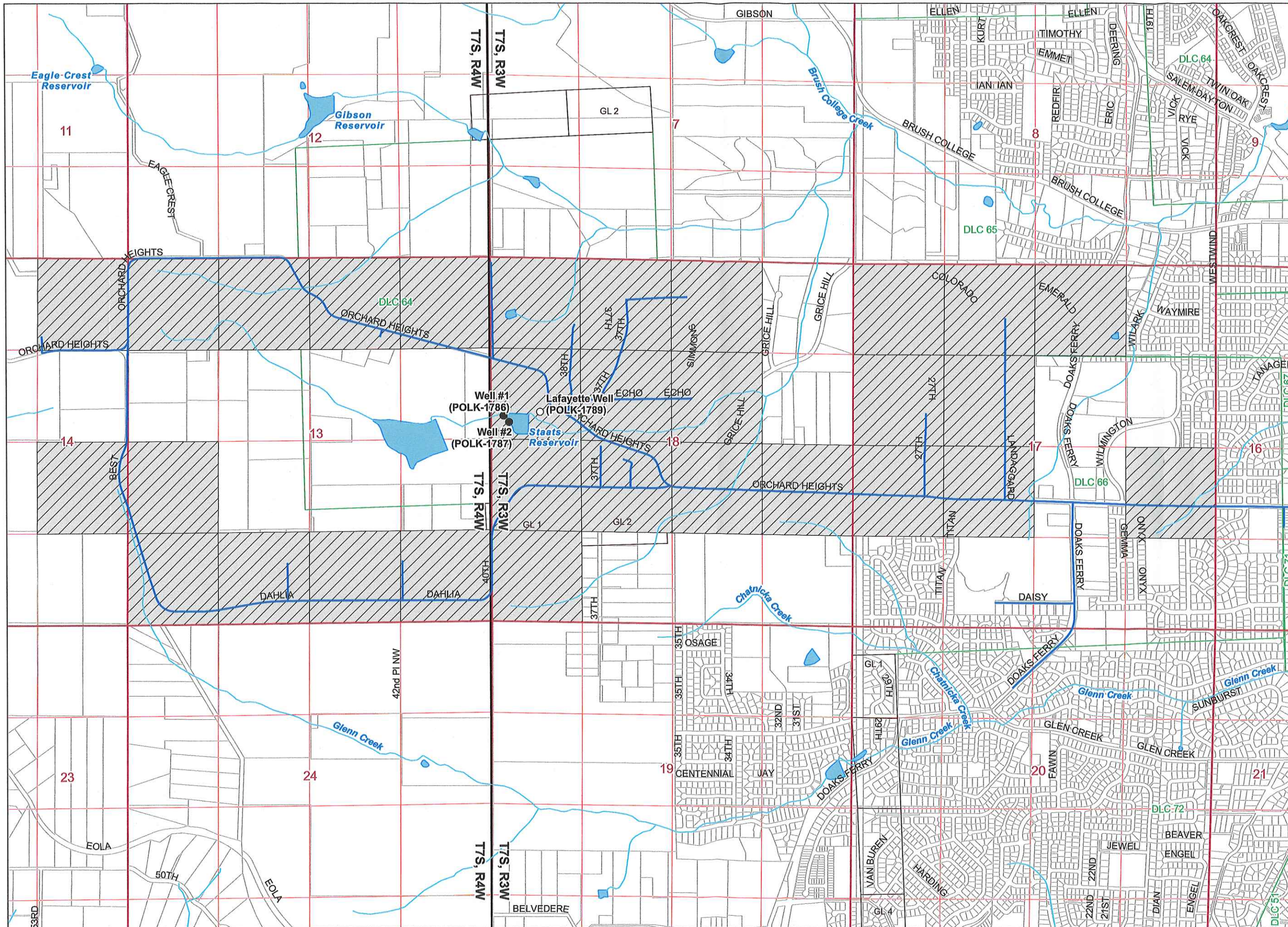

LEGEND

- Authorized Point of Appropriation (POA)
- Additional POA
- ▨ Authorized Place of Use
- ▭ Sections
- ▭ Quarter Quarter Sections
- ▭ Donation Land Claims (DLCs)
- ▭ Government Lots (GLs)
- ▭ Tax Lots
- ~ Mainline (Approximate)
- ~ Watercourse

POA Location Descriptions

Well #1 (POLK-1786):
 South 3 degrees, 12 minutes East 2308 feet from the NW corner of Section 18

Well #2 (POLK-1787):
 South 5 degrees, 14 minutes East 2412 feet from the NW corner of Section 18

Lafayette Well (POLK-1789):
 North 62 degrees, 54 minutes east, 780 feet from W quarter of Section 18

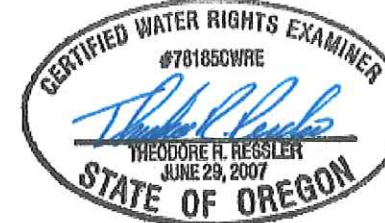

RENEWS: 12-31-2022
 CWRE Seal and Signature

Disclaimer:
 This map was prepared for the purpose of identifying the location of a water right only and is not intended to show legal dimensions or location of property ownership.



Data Sources: Polk County, OWRD, USGS, BLM
 Date: 10/10/2022

Application for a Permanent Water Right Transfer Certificate

A Water Right in the Name of
 Orchard Heights Water Association

Township 7S, Range 3W, Sections 13, 14, 15, 16, 17, 18, 19, 20, 21, 22, 23, 24
 Township 7S, Range 4W, Sections 13, 14, 15, 16, 17, 18, 19, 20, 21, 22, 23, 24

