





TRANSFER APPLICATION MAP
FOR THE
U.S. FISH AND WILDLIFE SERVICE,
KLAMATH BASIN NATIONAL WILDLIFE REFUGE COMPLEX
IN T. 34 & 35 S., R. 7 E., W.M.

-  A.P. 5 7535 P.M. 5 4791 Ch 7552 AUTHORIZED PLACE OF USE
-  A.P. 5 29718 P.M. 5 23356 Ch 42583 AUTHORIZED PLACE OF USE
-  ACRES TO BE TRANSFERRED (Ch 42583/2023 PR (SUPP))
-  ACRES TO BE TRANSFERRED (Ch 42583 PR)
-  UPPER KLAMATH NATIONAL WILDLIFE REFUGE BOUNDARY

AUTHORIZED DIVERISION POINTS

WOOD RIVER DIV. PT. IS LOCATED 340 FEET SOUTH AND 345 FEET EAST FROM THE NW CORNER OF SECTION 13 WITH T1 LOT 3 OF SECTION 13 T34S R75E W1M

FOUR MILE CR. DIV. PT. IS LOCATED 200 FEET NORTH AND 30 FEET EAST FROM THE SW CORNER OF SECTION 16 WITH T1 LOT 3 (27/4 52/24) SECTION 16 T34S R75E W1M

WYVERN MILE CR. DIV. PT. IS LOCATED 225 FEET NORTH AND 30 FEET EAST FROM THE SW CORNER OF SECTION 16 WITH T1 LOT 20 (82/4 52/24) SECTION 16 T34S R75E W1M

AGUA CR. DIV. PT. IS LOCATED 40 FEET SOUTH AND 130 FEET EAST FROM THE CENTER OF SECTION 5 WITH T1 LOT 3 (82/4 22/24) SECTION 5 T34S R75E W1M

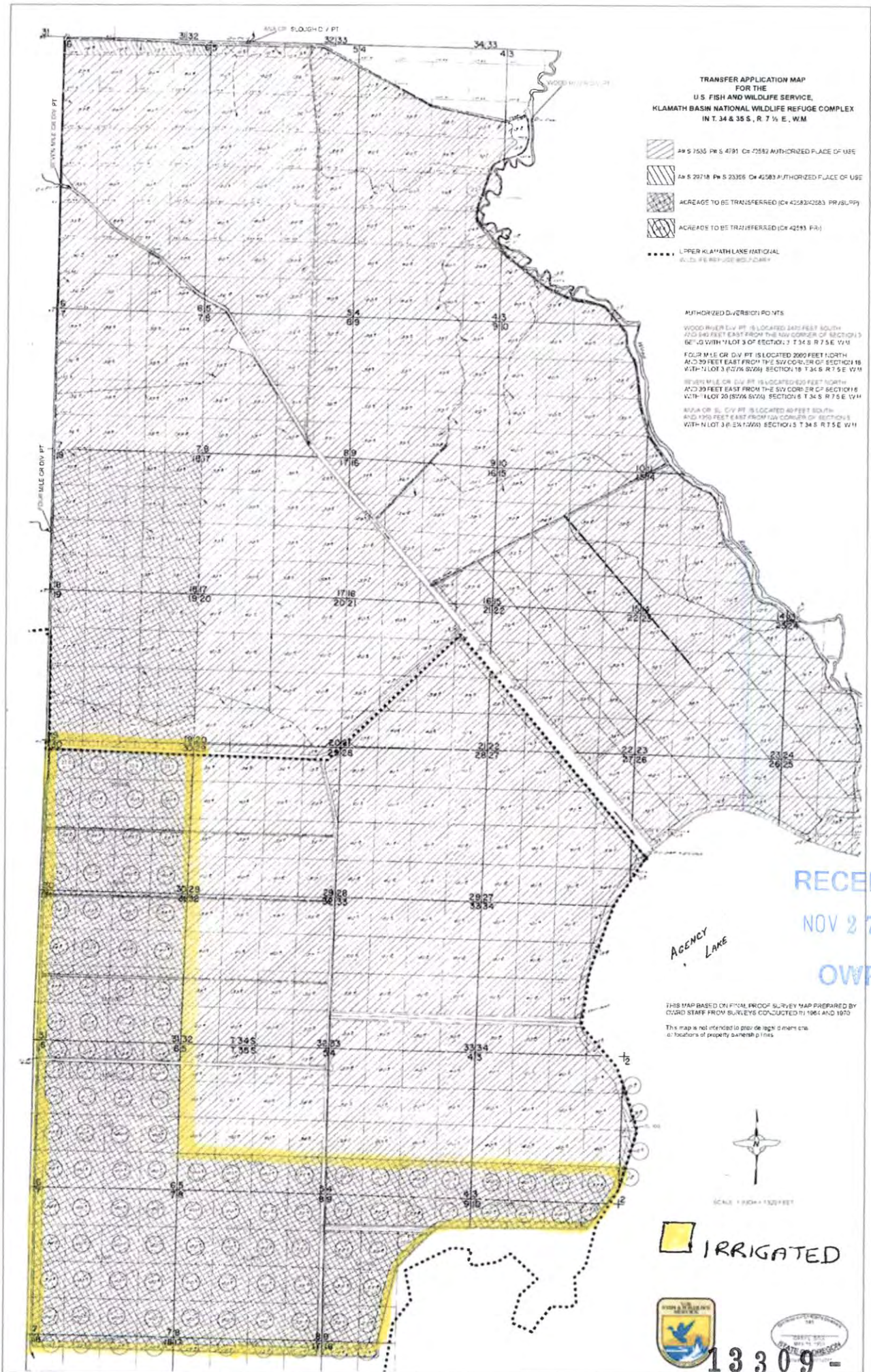

RECEIVED
NOV 27 2019
OWRD

AGENCY LAKE

THIS MAP BASED ON FINAL PROOF SURVEY MAP PREPARED BY
OWRD STAFF FROM SURVEYS CONDUCTED IN 1964 AND 1970
This map is not intended to provide legal advice as to
a) locations of property ownership lines



SCALE 1" = 120 FEET

 IRRIGATED



13309



Imagery date 8/23/2016

RECEIVED

NOV 27 2019

OWRD

13309 -



Imagery date 7/24/2014

RECEIVED

NOV 27 2019

OWB

13309 -

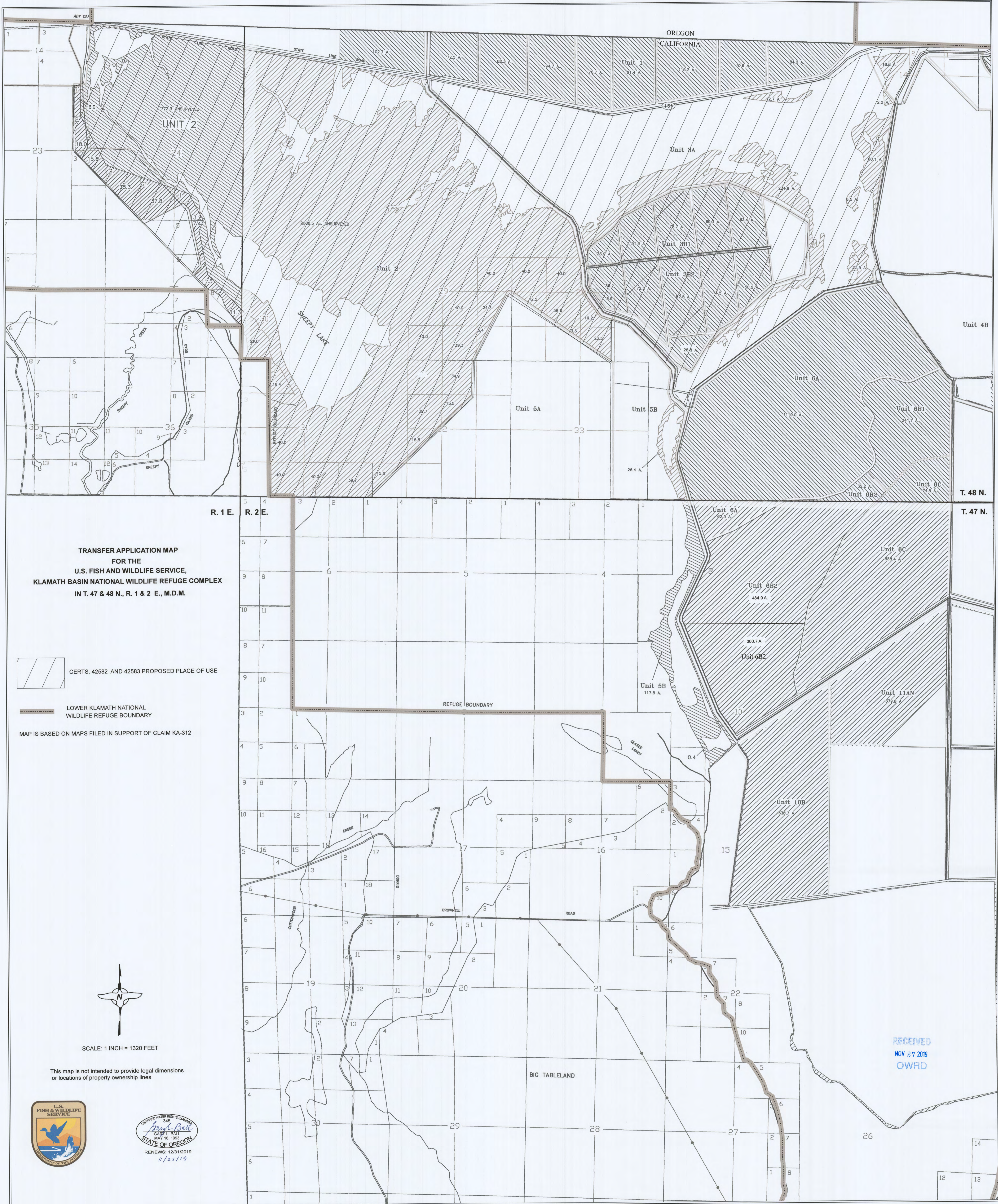

**TRANSFER APPLICATION MAP
FOR THE
U.S. FISH AND WILDLIFE SERVICE,
KLAMATH BASIN NATIONAL WILDLIFE REFUGE COMPLEX
IN T. 47 & 48 N., R. 1 & 2 E., M.D.M.**

 CERTS. 42582 AND 42583 PROPOSED PLACE OF USE

 LOWER KLAMATH NATIONAL WILDLIFE REFUGE BOUNDARY

MAP IS BASED ON MAPS FILED IN SUPPORT OF CLAIM KA-312





SCALE: 1 INCH = 1320 FEET

This map is not intended to provide legal dimensions or locations of property ownership lines

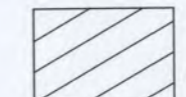

RECEIVED
NOV 27 2019
OWRD

TRANSFER APPLICATION MAP
FOR THE
U.S. FISH AND WILDLIFE SERVICE,
KLAMATH BASIN NATIONAL WILDLIFE REFUGE COMPLEX
IN T. 34 & 35 S., R. 7 1/2 E., W.M.

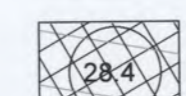
-  A# S-7535, P# S-4791, C# 42582 AUTHORIZED PLACE OF USE
-  A# S-29718, P# S-23396, C# 42583 AUTHORIZED PLACE OF USE
-  ACREAGE TO BE TRANSFERRED (C# 42582/42583, PRI/SUPP)

■■■■■ UPPER KLAMATH LAKE NATIONAL WILDLIFE REFUGE BOUNDARY

AUTHORIZED DIVERSION POINTS:

WOOD RIVER DIV. PT. IS LOCATED 2470 FEET SOUTH AND 940 FEET EAST FROM THE NW CORNER OF SECTION 3, BEING WITHIN LOT 3 OF SECTION 3, T 34 S, R 7.5 E, W.M.

FOUR MILE CR. DIV. PT. IS LOCATED 2050 FEET NORTH AND 30 FEET EAST FROM THE SW CORNER OF SECTION 18, WITHIN LOT 3 (NW 1/4 SW 1/4), SECTION 18, T 34 S, R 7.5 E, W.M.

SEVEN MILE CR. DIV. PT. IS LOCATED 620 FEET NORTH AND 30 FEET EAST FROM THE SW CORNER OF SECTION 6, WITHIN LOT 20 (SW 1/4 SW 1/4), SECTION 6, T 34 S, R 7.5 E, W.M.

ANNA CR. SL. DIV. PT. IS LOCATED 40 FEET SOUTH AND 1350 FEET EAST FROM NW CORNER OF SECTION 5, WITHIN LOT 3 (NE 1/4 NW 1/4), SECTION 5, T 34 S, R 7.5 E, W.M.

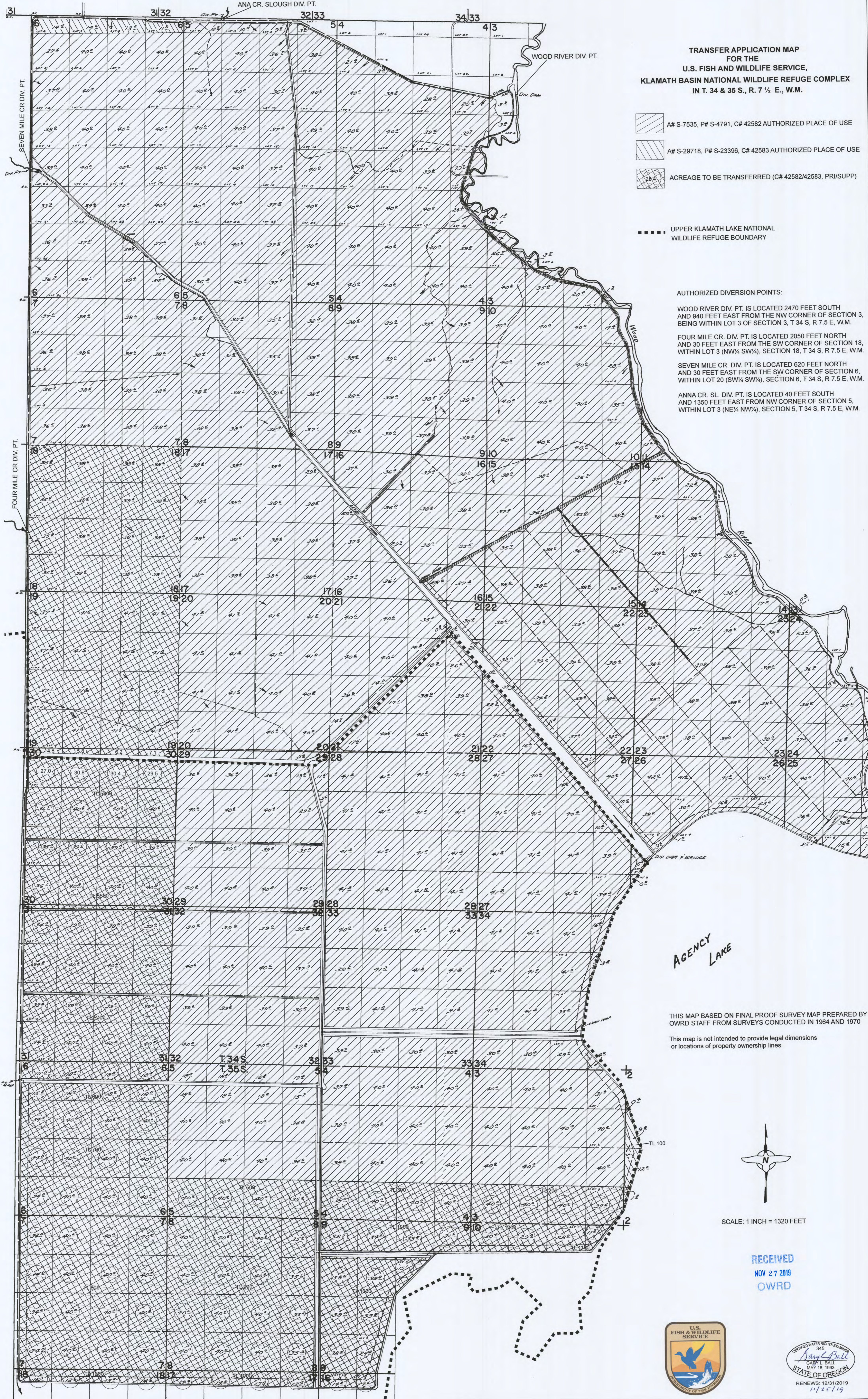

AGENCY LAKE

THIS MAP BASED ON FINAL PROOF SURVEY MAP PREPARED BY OWRD STAFF FROM SURVEYS CONDUCTED IN 1964 AND 1970

This map is not intended to provide legal dimensions or locations of property ownership lines



SCALE: 1 INCH = 1320 FEET

RECEIVED
NOV 27 2019
OWRD





TRANSFER APPLICATION VICINITY MAP
FOR THE U.S. FISH AND WILDLIFE SERVICE,
KLAMATH BASIN NATIONAL WILDLIFE REFUGE COMPLEX

FOR TRANSFER APPLICATION PROPOSING TO TRANSFER
PORTIONS OF CERTIFICATES 42582 AND 42583 FROM
UPPER KLAMATH NATIONAL WILDLIFE REFUGE TO LOWER KLAMATH NATIONAL WILDLIFE REFUGE



LEGEND

-  AUTHORIZED PLACE OF USE
-  PROPOSED PLACE OF USE
-  REFUGE APPROVED BOUNDARY

THE AUTHORIZED POINTS OF DIVERSION ARE ON WOOD RIVER, ANA CREEK SLOUGH, SEVEN MILE CREEK, AND FOUR MILE CREEK

THE PROPOSED POINT OF DIVERSION IS THE ADY/CENTRAL CANAL INTAKE AT THE KLAMATH RIVER, LOCATED IN THE NE 1/4 NW 1/4 OF SECTION 15, T. 40 S., R. 8 E., W.M. AND 1220 FT SOUTH AND 2730 FT WEST FROM THE NE CORNER OF SECTION 15.

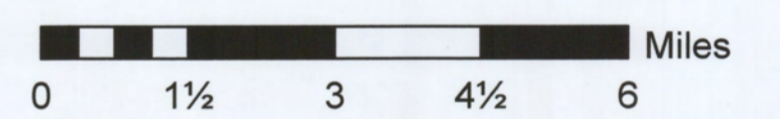

This map is not intended to provide legal dimensions or locations of property ownership lines

RECEIVED
NOV 27 2019
OWRD

