

RECEIVED
JUL 23 2019
OWRD

- 13228

Attachment #1
Transfer Application Map
POU Transfer Application for Certificate 48445

map to accompany application for permit to appropriate the Public Waters of the State of Oregon.

Permit 38081

Located within T2S, R9E, W.M.
Hood River County, Oregon

Mt. Hood Meadows Development Corporation
Portland, Oregon

RECEIVED
FEB 9
STATE ENGINEER
SALEM, OREGON

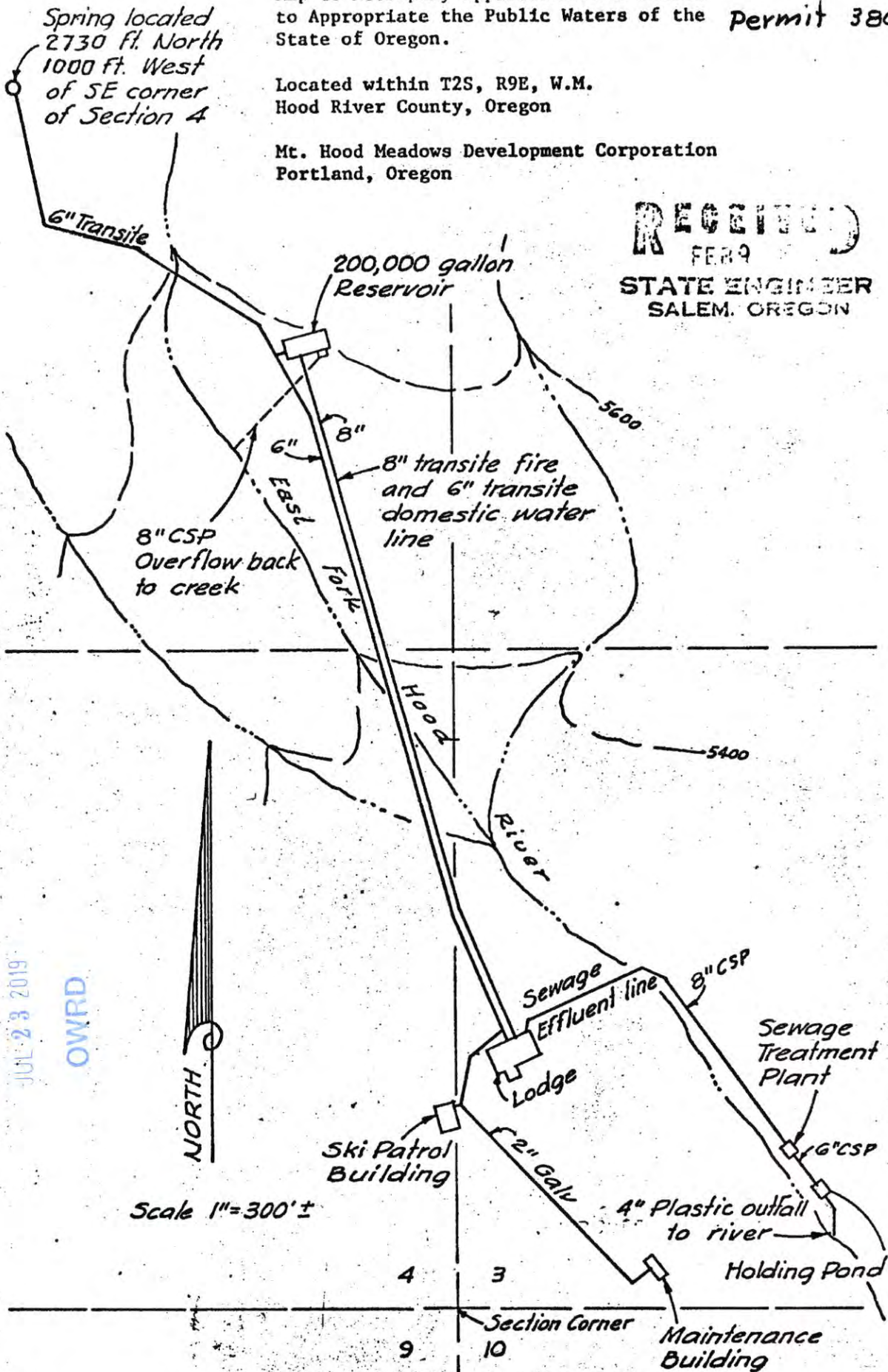

RECEIVED
JUL 23 2019
OWRD

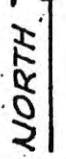

Scale 1" = 300' ±

WATER SUPPLY SYSTEM
MT. HOOD MEADOWS SKI AREA

APPENDIX A

MT. HOOD MEADOWS., OR., LTD.
Permit boundary located in
T.2 S., R. 9 E., &
T.3 S., R. 9 E., W.M.

Boundary from legal
description dated
5/7/86

RECEIVED

JUL 23 2019

13228

OWRD

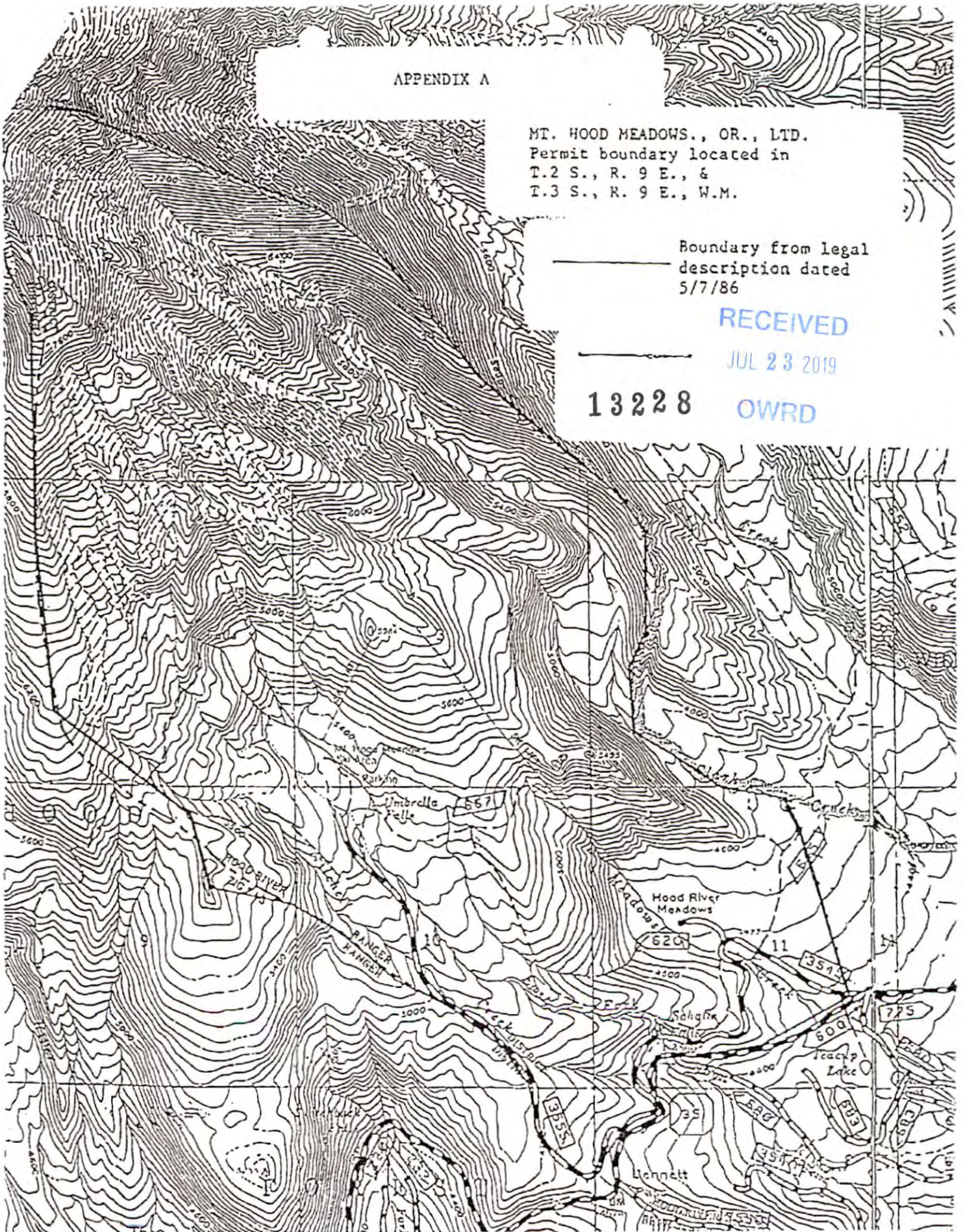

R9E

27 28 29 30 31

T2S

32 33 34 35 36

T3S

5 4 3 2 1

8 9 10 11 12

15 14 13

TL101

TL100





TL100

TL100

TL101

TL101

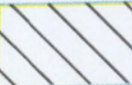
LEGEND

-  Authorized Point of Diversion (POD)
SE NE Section 4 T.3S R.9E W.M.
2730 feet North & 1000 feet West from
the SE corner of Section 4
-  Authorized Place of Use
-  Proposed Place of Use (POU)
-  Tax Lot 101
-  Watercourse

Application for a Water Right Transfer Place of Use Certificate 48445

MEADOWS UTILITIES, LLC
T. 2 & 3 SOUTH R. 9 EAST W.M. HOOD RIVER COUNTY, OREGON

CERTIFIED WATER RIGHTS EXAMINER STAMP

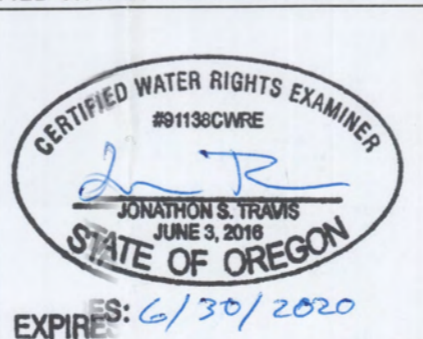

13228

RECEIVED

JUL 23 2019

OWRD

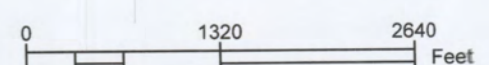

DISCLAIMER
This map was prepared for the purpose of identifying the location of a water right only and it is not intended to provide legal dimensions or location of property ownership lines

MAP NOTES:
Date July 10, 2017

Data Sources: USBLM, USFS, Hood River County

Date: 07-10-2019
Scale: 1" = 1320'
Sheet No. 1 OF 1

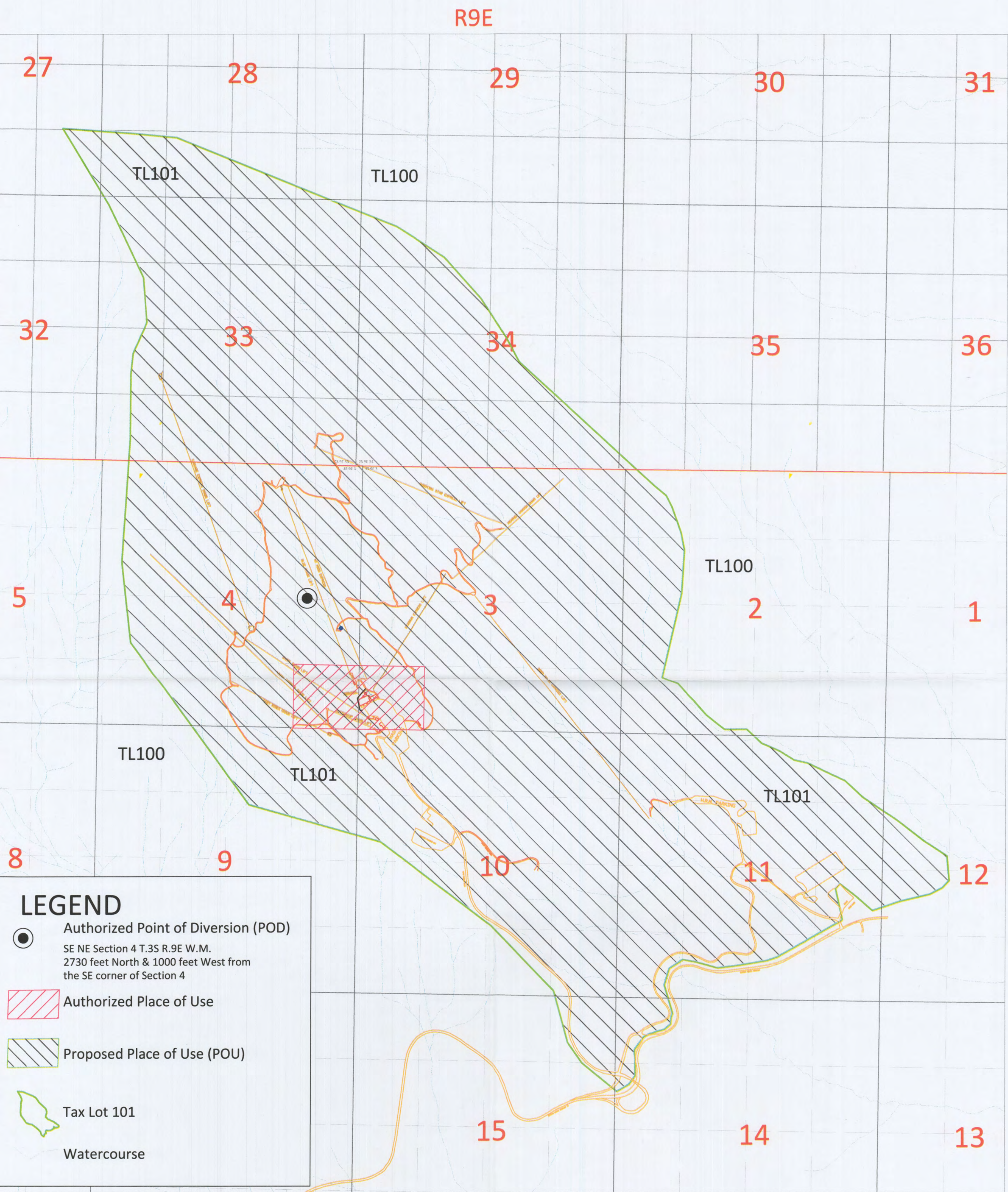

LEGEND

- Authorized Point of Diversion (POD)
 SE NE Section 4 T.3S R.9E W.M.
 2730 feet North & 1000 feet West from
 the SE corner of Section 4
- Authorized Place of Use
- Proposed Place of Use (POU)
- Tax Lot 101
- Watercourse

**Application for a Water Right Transfer
Place of Use Certificate 48445**

MEADOWS UTILITIES, LLC
 T. 2 & 3 SOUTH R. 9 EAST W.M. HOOD RIVER COUNTY, OREGON

DISCLAIMER
 This map was prepared for the purpose of identifying the location of a water right only and it is not intended to provide legal dimensions or location of property ownership lines

MAP NOTES:
 Date July 10, 2017

Data Sources: USBLM, USFS, Hood River County

CERTIFIED WATER RIGHTS EXAMINER STAMP



13228

RECEIVED
 JUL 23 2019
 OWRD

MT. HOOD MEADOWS
 Meadows GIS