

Document Path: Y:\0224 - Prineville Source Figures\039 - FY22 - 23\TransferApp_Cert94816_POAs.mxd_albany

- LEGEND**
- Authorized Point of Appropriation (POA)
 - Proposed Additional Point of Appropriation (POA)
 - Government Lot (GL)
 - City Boundary
 - Watercourse

**Transfer Application for Certificate 94816
in the Name of the City of Prineville**

**Authorized and Proposed Additional
Points of Appropriation Map**

Crook County
Township 15 South, Range 16 East (W.M.)

RECEIVED

JAN 23 2023

OWRD

CERTIFIED WATER RIGHTS EXAMINER STAMP

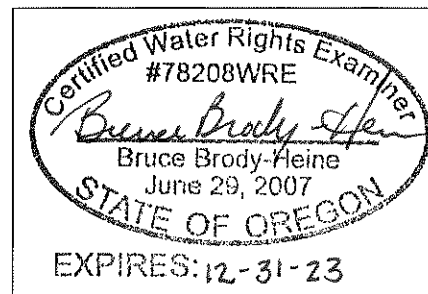

POA LOCATION DESCRIPTION

Authorized POAs:

Barney Well (CROO 3132)
Located 1315 feet South and 1370 feet East from the N 1/4 corner of Section 4, Township 15 South, Range 16 East (W.M.)

Stearns Well 2 (CROO 2083)
Located 1810.2 feet South and 1151.5 feet East from the N 1/4 corner of Section 4, Township 15 South, Range 16 East (W.M.)

Proposed Additional POA:

Stearns Well 3: Located 1800 feet South and 1380 feet West from the NE corner of Section 04, Township 15 South, Range 16 East (W.M.)

DISCLAIMER
This map was prepared for the purpose of identifying the location of a water right only and it is not intended to provide legal dimensions or location of property ownership lines.

Date: November 3, 2022
Data Sources: BLM, ESRI, OWRD, USGS, Crook County

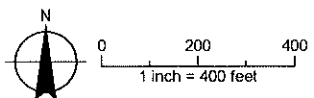

14156

Transfer Application for Certificate 94816 in the Name of the City of Prineville

Place of Use Map

Crook County, Oregon
Township 14, 15 South,
Range 16 East (W.M.)

LEGEND

- ⊙ Authorized Point of Appropriation (POA)
 - Proposed Additional Point of Appropriation (POA)
 - ▭ Authorized Place of Use (POU)
 - Government Lot (GL)
- All Other Features**
- ⊕ Tax Lot
 - City Boundary
 - Major Road
 - Railroad
 - Watercourse
 - Waterbody

RECEIVED
JAN 23 2023
OWRD

Certified Water Rights Examiner Stamp

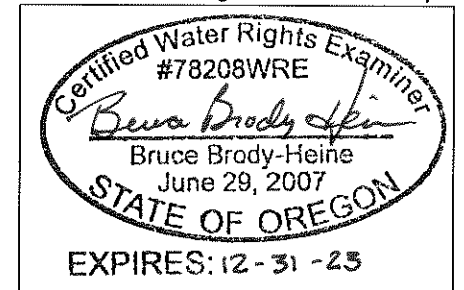

DISCLAIMER

This map was prepared for the purpose of identifying the location of a water right only and it is not intended to provide legal dimensions or location of property ownership lines.

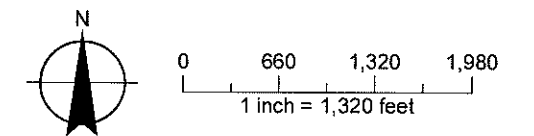

Date: November 3, 2022
Data Sources: OWRD, USGS, BLM,
ESRI, City of Prineville, Crook County



14156

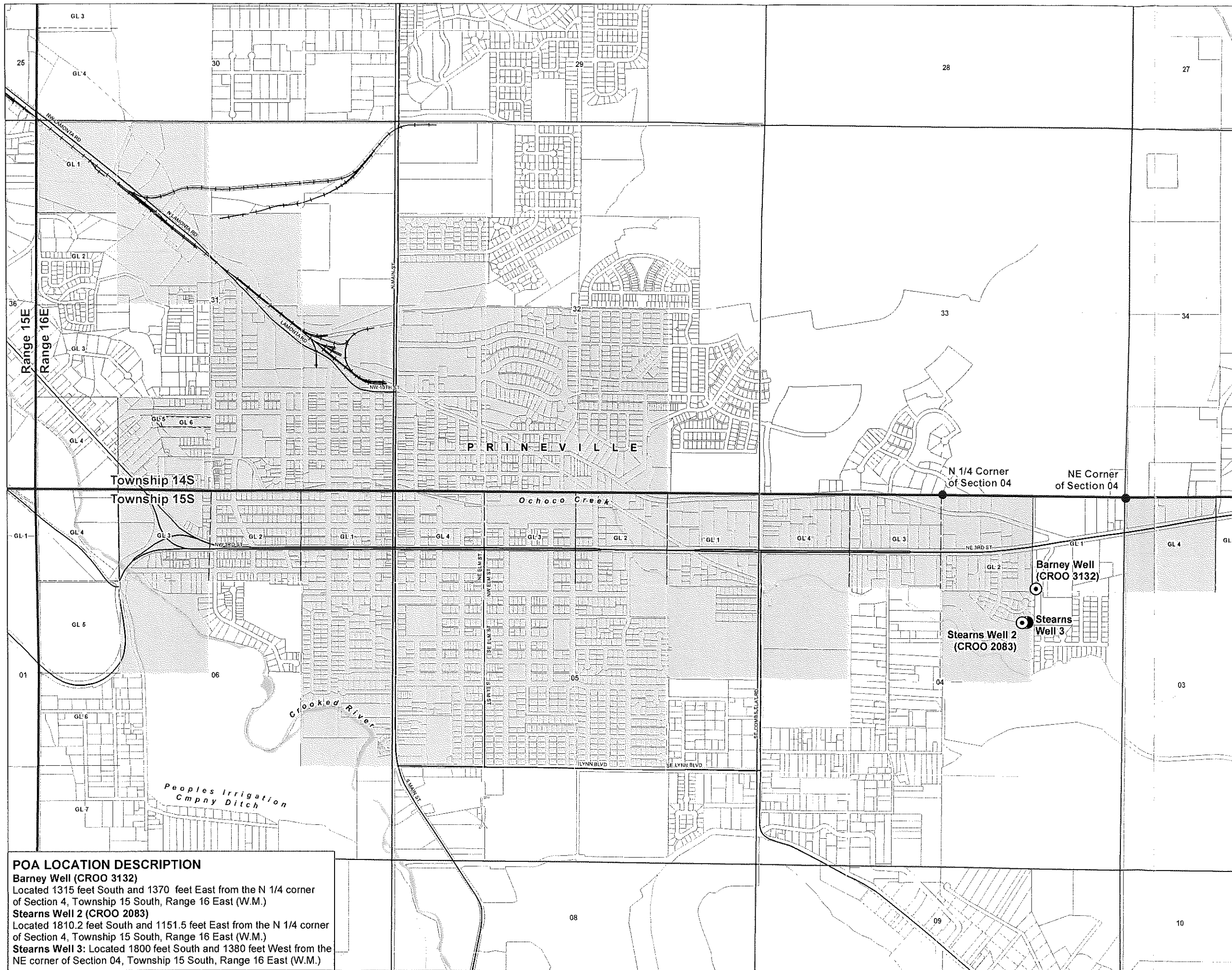

POA LOCATION DESCRIPTION

Barney Well (CROO 3132)
Located 1315 feet South and 1370 feet East from the N 1/4 corner of Section 4, Township 15 South, Range 16 East (W.M.)

Stearns Well 2 (CROO 2083)
Located 1810.2 feet South and 1151.5 feet East from the N 1/4 corner of Section 4, Township 15 South, Range 16 East (W.M.)

Stearns Well 3: Located 1800 feet South and 1380 feet West from the NE corner of Section 04, Township 15 South, Range 16 East (W.M.)