

**LEGEND**

- SECTION LINE
- 1/4 1/4 LINE
- TAX LOT LINE
- PIPE
- ROAD
- SECTION CORNER
- TAX LOT NUMBER
- POA (WELL)
- CERTIFICATE 65944 TRANSFERRED "TO" LANDS

**NOTES:**

1. THIS MAP WAS PREPARED FROM FIELD MEASUREMENTS, NAIP 2023 AERIAL PHOTOGRAPHY, KLAMATH COUNTY TAX MAPS, AND OREGON GLO MAPS.
2. THE PURPOSE OF THIS MAP IS TO IDENTIFY THE LOCATION OF THE WATER RIGHT ONLY, AND IS NOT INTENDED TO PROVIDE DIMENSIONS OR LOCATION OF PROPERTY LINES.
3. DATE OF PRIORITY FOR THIS CERTIFICATE IS MARCH 4, 1981.

**WELL LOCATIONS:**

- AUTHORIZED WELL 1 (KLAM 14772): 2590' SOUTH & 720' EAST FROM THE NORTHWEST CORNER OF SECTION 32.
- PROPOSED WELL 2 (KLAM 61453): 2565' SOUTH & 730' WEST FROM THE NORTHWEST CORNER OF SECTION 32.

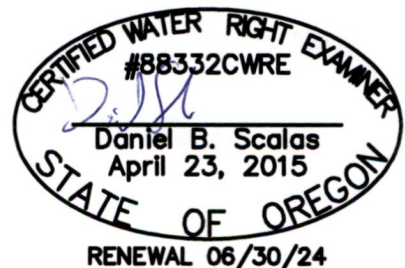

**AL ADKINS** ENGINEERING & SURVEYING  
 o / 541.884.4666  
 w / AdkinsEngineering.com

1435 ESPLANADE AVENUE, KLAMATH FALLS, OR 97601

SERVING S. OREGON & N. CALIFORNIA

ENGINEERING • SURVEYING • PLANNING • TESTING

**TRANSFER APPLICATION MAP**

FOR  
 JOHN ELLIOTT AND LOUDEAN ELLIOTT  
 T40S, R11E, SEC. 32, WM  
 KLAMATH COUNTY, OREGON  
 CERTIFICATE 65944  
 APPLICATION G-10195  
 PERMIT G-9243

14151  
 14151

65944

# T. 40S., R.1E., W.M.

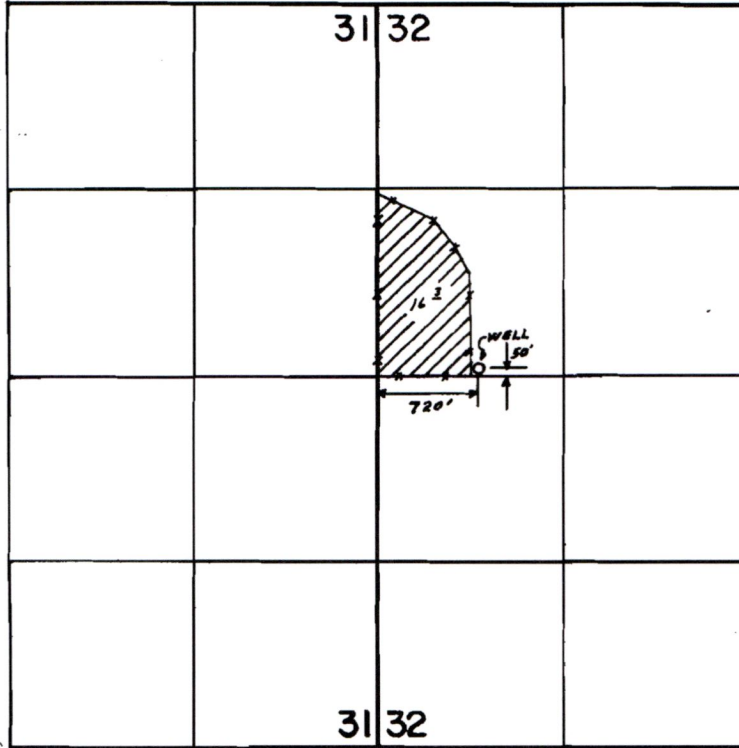

SCALE: 1"=1320'

## FINAL PROOF SURVEY UNDER

Application No. G-10195 Permit No. G-9243  
IN NAME OF

GARY D. OREM

Surveyed AUG. 18 1987, by V.L. CHURCH

14151

PTS 1987-P6

3-20-89

*V.L.C.*

*East Arica Wells*