

T7S R46E WM

RECEIVED

MAR 30 2023

**OWHD
SALEM, OREGON**

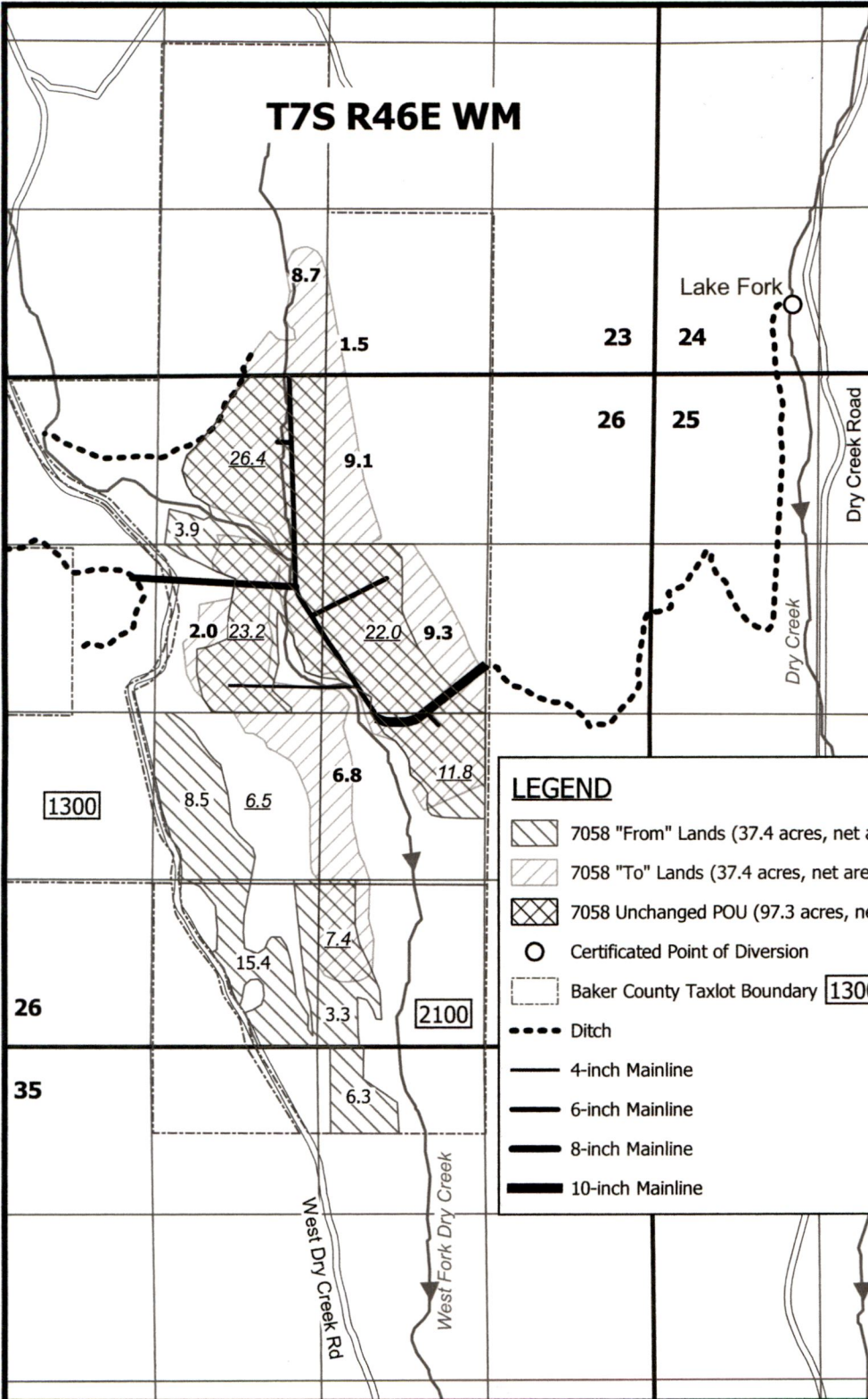
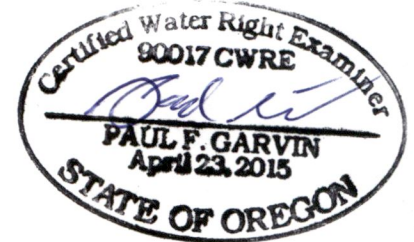

LEGEND

- 7058 "From" Lands (37.4 acres, net area per QQ denoted in regular font)
- 7058 "To" Lands (37.4 acres, net area per QQ denoted in bold font)
- 7058 Unchanged POU (97.3 acres, net area per QQ denoted in italicized underlined font)
- Certificated Point of Diversion
- Baker County Taxlot Boundary **1300**
- Ditch
- 4-inch Mainline
- 6-inch Mainline
- 8-inch Mainline
- 10-inch Mainline

Notes:

This map is not intended to provide legal dimensions or locations of property ownership lines.

Lake Fork Ditch POD location: 1,101 ft E and 544 ft N from the SW Corner of Section 24

Under Certificate 7058 134.7 acres of irrigation are certificated on the Denson Dry Creek Ranch (TLs 1300 and 2100)

Since all area calculations are net per QQ and the from/to lands dont always overlap within the QQ, the correct net area of the to, from, and unchanged lands per QQ consists of the values denoted on this map. Areas are not denoted where zero.



**Certificate 7058 Transfer Application Map
Denson Dry Creek Ranch
Halfway, OR 97834**

Prepared on behalf of Brad Denson



1 inch = 1,320 feet

Date: 3/28/23
Drawn by: Paul F. Garvin