

LEGEND

- Authorized Point of Diversion (POD)
- Proposed Additional Point of Diversion (POD)
- Water Treatment Plant
- Proposed Pipeline
- Existing Pipeline
- Tax Lot
- Government Lot (GL)
- Donation Land Claim (DLC)
- Railroad
- Major Road
- Watercourse
- Waterbody

**Application for a Permit Amendment
in the Name of City of Philomath
Authorized and Proposed Additional
Points of Diversion
Permit S-49245**

RECEIVED

JUL 31 2023

OWRD

LOCATION DESCRIPTION

Authorized Point of Diversion
1550 feet North and 715 feet West from SE Corner,
Section 11, Township 12 South, Range 6 West (W.M.)
Proposed Additional Point of Diversion
875 feet North and 330 feet West from SE Corner,
Section 11, Township 12 South, Range 6 West (W.M.)

DISCLAIMER
This map was prepared for the purpose of
identifying the location of a water right only and
it is not intended to provide legal dimensions
or location of property ownership lines.

Date: June 27, 2023
Data Sources: BLM, ESRI, OWRD, USGS

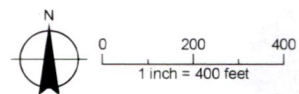

14292

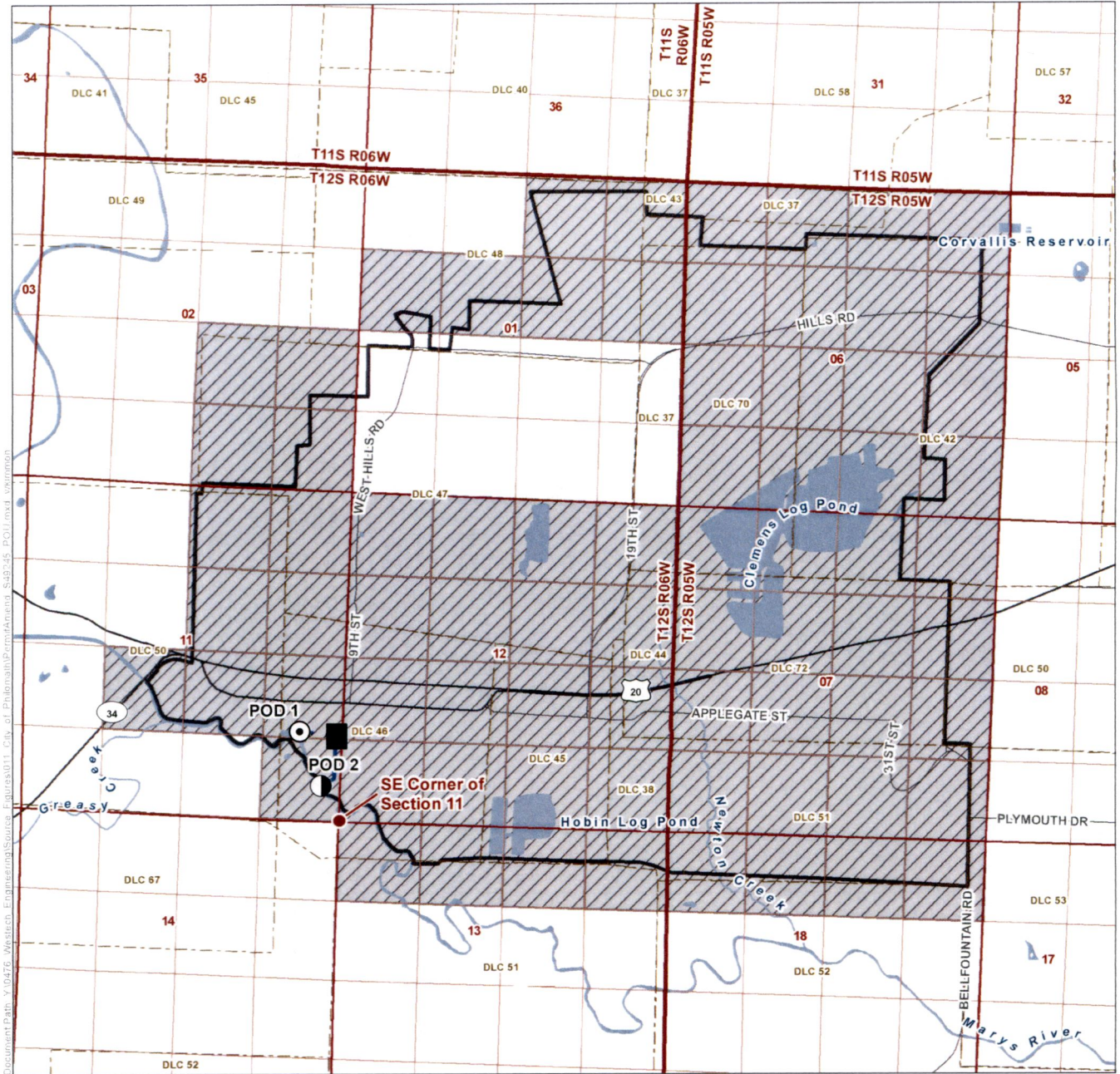

LEGEND

- Authorized Point of Diversion (POD)
- Proposed Additional Point of Diversion (POD)
- Authorized Place of Use (POU)
- City of Philomath Service Area Boundary
- Water Treatment Plant
- Proposed Pipeline
- Existing Pipeline
- Government Lot (GL)
- Donation Land Claim (DLC)
- Railroad
- Major Road
- Watercourse
- Waterbody

**Application for a Permit Amendment
in the Name of City of Philomath
Authorized Place of Use
Permit S-49245
Township 12 South, Range 5/6 West (W.M.)**

LOCATION DESCRIPTION

Authorized Point of Diversion
1550 feet North and 715 feet West from SE Corner,
Section 11, Township 12 South, Range 6 West (W.M.)

Proposed Additional Point of Diversion
875 feet North and 330 feet West from SE Corner,
Section 11, Township 12 South, Range 6 West (W.M.)

RECEIVED
JUL 31 2023
OWRD

DISCLAIMER
This map was prepared for the purpose of
identifying the location of a water right only and
it is not intended to provide legal dimensions
or location of property ownership lines.

Date: June 27, 2023
Data Sources: BLM, ESRI, OWRD, USGS

