

T2S, R3W

SESW

Sec. 11

SWSE

Certified Water Rights Examiner  
 #712101  
 Robert E. Long Jr.  
 May 15, 2002  
 STATE OF OREGON  
 EXPIRATION DATE: 12-31-2024

Graver Creek  
 NENW  
 POD 1,  
 790 S, 150' W  
 from N1/4 corner, Sec. 14

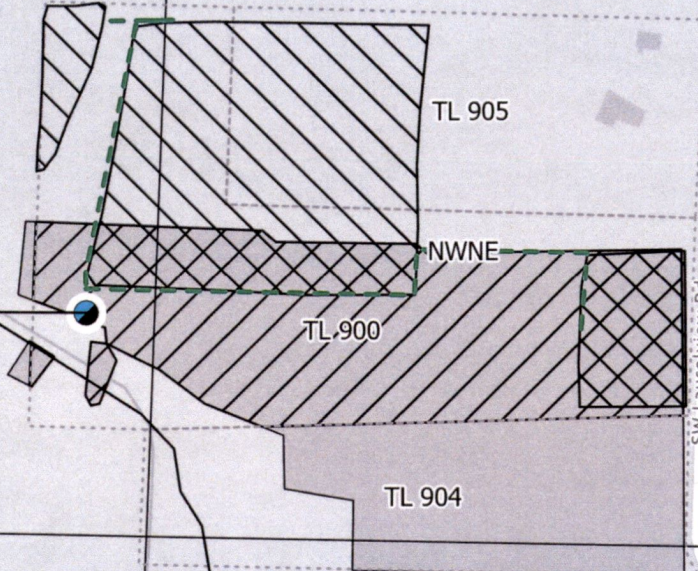

NENE

Existing Place of Use:  
 1.5 ac in NENW of Sec 14  
 10.1 ac in NWNE of Sec 14  
 11.6 ac in Taxlot 900

Sec. 14

SESW

SWNE

SE

Proposed Place of Use:  
 2.2 ac in NENW of Sec 14  
 9.4 ac in NWNE of Sec 14  
 3.9 ac in Taxlot 905  
 7.7 ac in Taxlot 900

Mc Fee Creek

McFee Pl



311 B Avenue, Suite P  
 Lake Oswego, Oregon 97034  
 (503) 954-1326

Figure 3  
 Cert. 73636 Water Right  
 Transfer Map

No.	Date	By	Revisions
1	DATE	AUTH	DRAFT



100 0 100 200 ft  
 1:4800

Proj#: 2405001  
 Roselli Transfer  
 Paola Roselli  
 32508 SW Laurelview Road  
 Hillsboro, OR, 97123

- Proposed To Lands
- Proposed From Lands
- Existing POU
- Taxlot Boundaries
- Proposed POD
- Proposed Distribution Lines

RECEIVED  
 MAR 22 2024

14426 -

OWRD