

PRELIMINARY Exhibit Map

for USA Small Farm Investment Group

110 River Grove Dr., Cave Junction, OR

by William Colisch PLS PC

291 Pyle Drive, Grants Pass, OR 97527

541 474-1081 Survey@charter.net

Section 2, T40S, R8W, WM

RECEIVED

NOV 09 2023

OWRD

Received by OWRD

MAR 26 2024

Salem, OR

- Legend:**
- Place of Use REMAINING, Certificate 87001
Tract 2, priority 1905, 20 Ac NENW & 3 Ac SENW
 - Place of Use REMAINING, Certificate 87000
priority 1/30/1920, 1.6 Ac SENW
 - Place of Use REMAINING, Certificate 87001
Tract 1, priority 1881, 3.37 Ac SENW
 - Place of Use Transfer FROM, Certificate 87001
Tract 1, priority 1881, 3.63 Ac SENW
 - Place of Use Transfer TO, Certificate 87001
Tract 1, priority 1881, 0.21 Ac SENW & 3.42 Ac NESW

Notes:
Existing water rights area & Point of Diversion taken from Jonathan Spero's 1998 Water Right Transfer map.

Received by OWRD

MAY 14 2024

Salem, OR

Received by OWRD

JUN 07 2024

Salem, OR



SCALE
1" = 400'

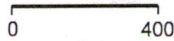

REGISTERED
PROFESSIONAL
LAND SURVEYOR

PRELIMINARY

OREGON
July 19, 1994
WILLIAM COLISCH
2659

Renews 12/31/23

22020 110 River Grove

AP# 40-08-02 Taxlot 1403

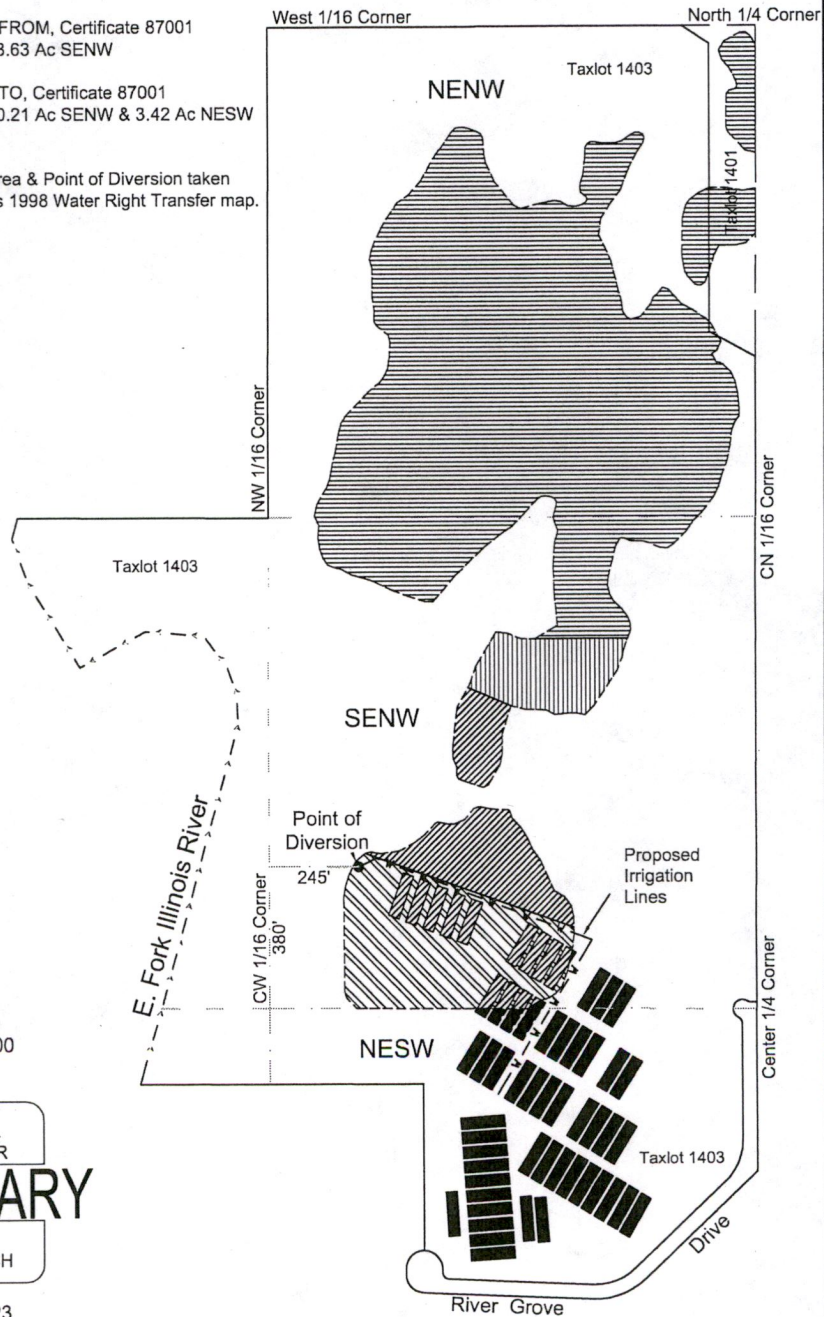

14438 -