

# Application for a Permanent Water Right Transfer Certificate 41895

A Water right held by Princess Properties LLC,  
Polk County

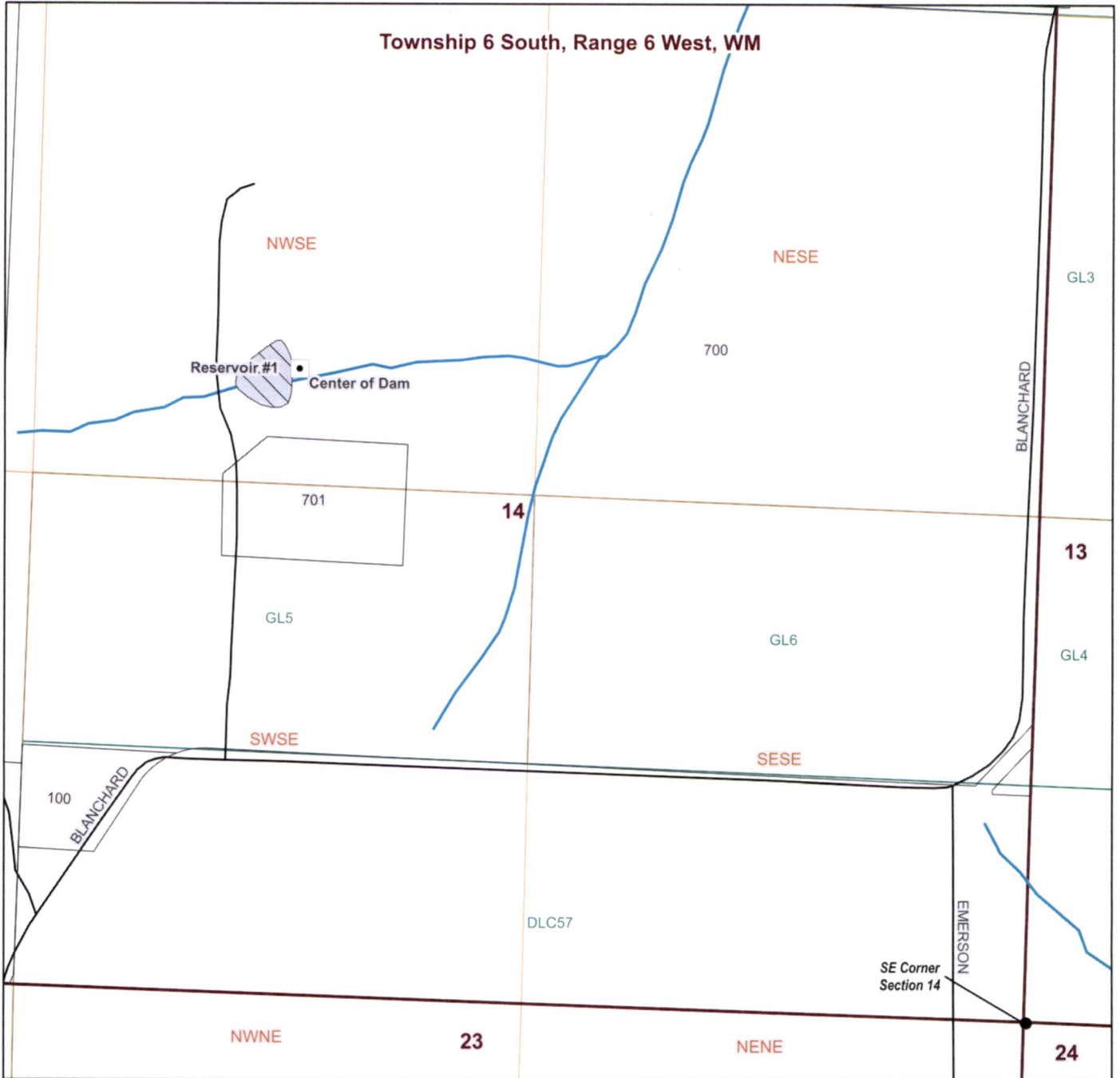

## LEGEND

- Place of Use (POU)
- Point of Diversion (POD)
- Taxlots
- Section
- QQ
- DLC/Glots
- Public Roads
- Streams

## POD Location Description

**Center of Dam**  
Located 1667 feet North and 1945 feet West from the SE corner of Section 14 (NWSE), Township 6 South, Range 6 West, W.M.

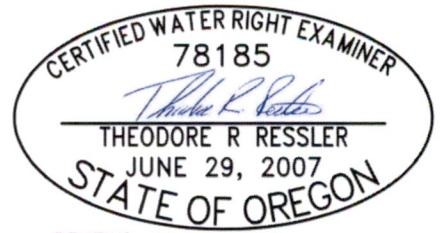

Received  
JUN 18 2024

OWRD

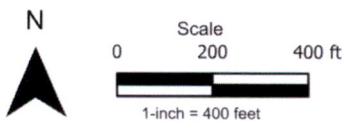

Date: 4/5/2024  
Data Sources: OWRD, USGS, ODOT, Polk County  
Disclaimer: This map is not intended to provide legal dimensions or property ownership lines.

14478 -

