

SECTION

4

TOWNSHIP 36 S, RANGE 4 W, W. M.

North

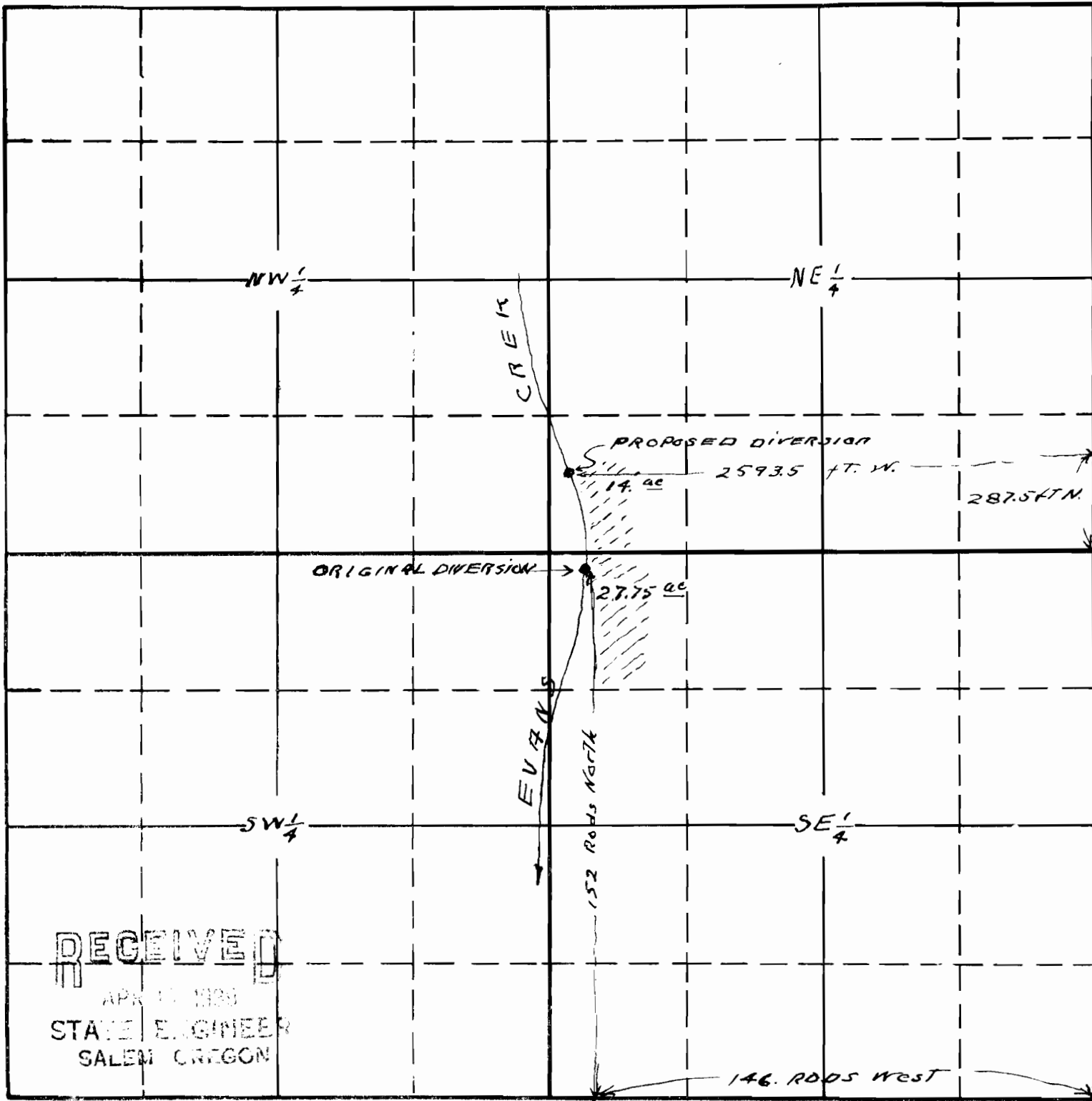

RECEIVED
 APR 11 1939
 STATE ENGINEER
 SALEM OREGON

Map to accompany application of Arden M Tyrell of Rogue River, Ore. for change in point of diversion from Evans Creek for irrigation

Original permit # 1173
 Cert. # 2015

APPLICATION No.
 PERMIT No.

This office 4/10/39 E. Smith