

T. 4 N. R. 27 E. W. M.

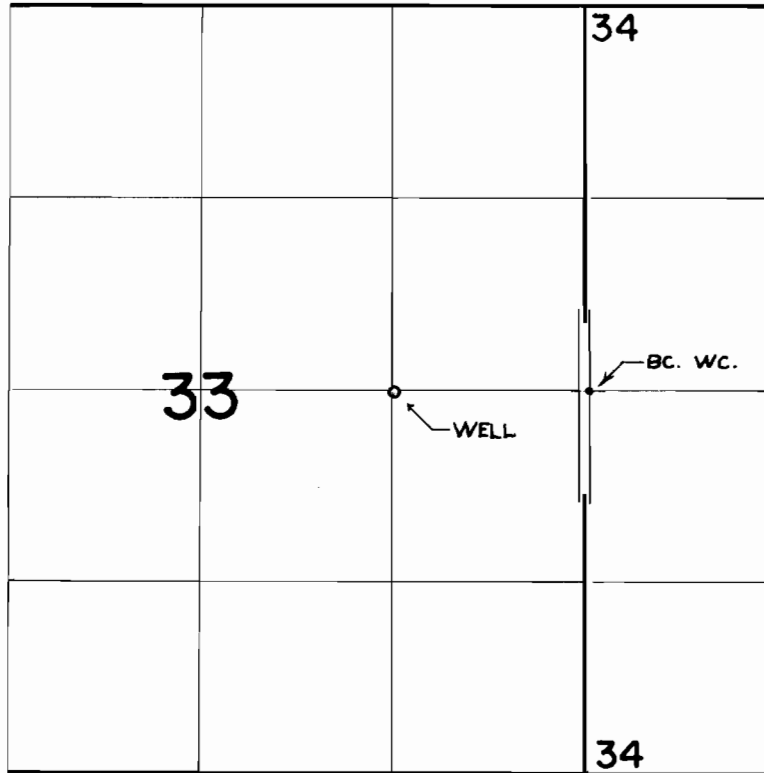

WELL LOC. 16' S & 1310' W FROM E 1/4 COR. SEC. 33

FINAL PROOF SURVEY
UNDER

Application No. _____ Transfer No. 2343
Permit No. _____
IN NAME OF

..... **ELROY F. McDOLE**

Surveyed JUNE 30, 1971, by R. MUGKEN