

Note: When being used does not agree with map.

5-17-12
SECTION T. S. R. E.W.M.
1" = 400'

① See deeme book
Page 155
Ole Gault
14 A water NESW,
west of highway

②^(a) In 1959 Ole Gault sold
19 acres land w/ 11 A water
N $\frac{1}{2}$ NESW to O'Leary
(1) 8 $\frac{1}{2}$ NESW to Broome
w/ 3 acres water

③ See below where
11 acres of N $\frac{1}{2}$ is
being put to beneficial
use.

④ Transfer application
attached to put
2 more acres of
water on N $\frac{1}{2}$

⑤ Land ——— 19 acres
Existing water 11
 8
Application
for transfer 2
 6 acres

Allowed ready
for future transfer

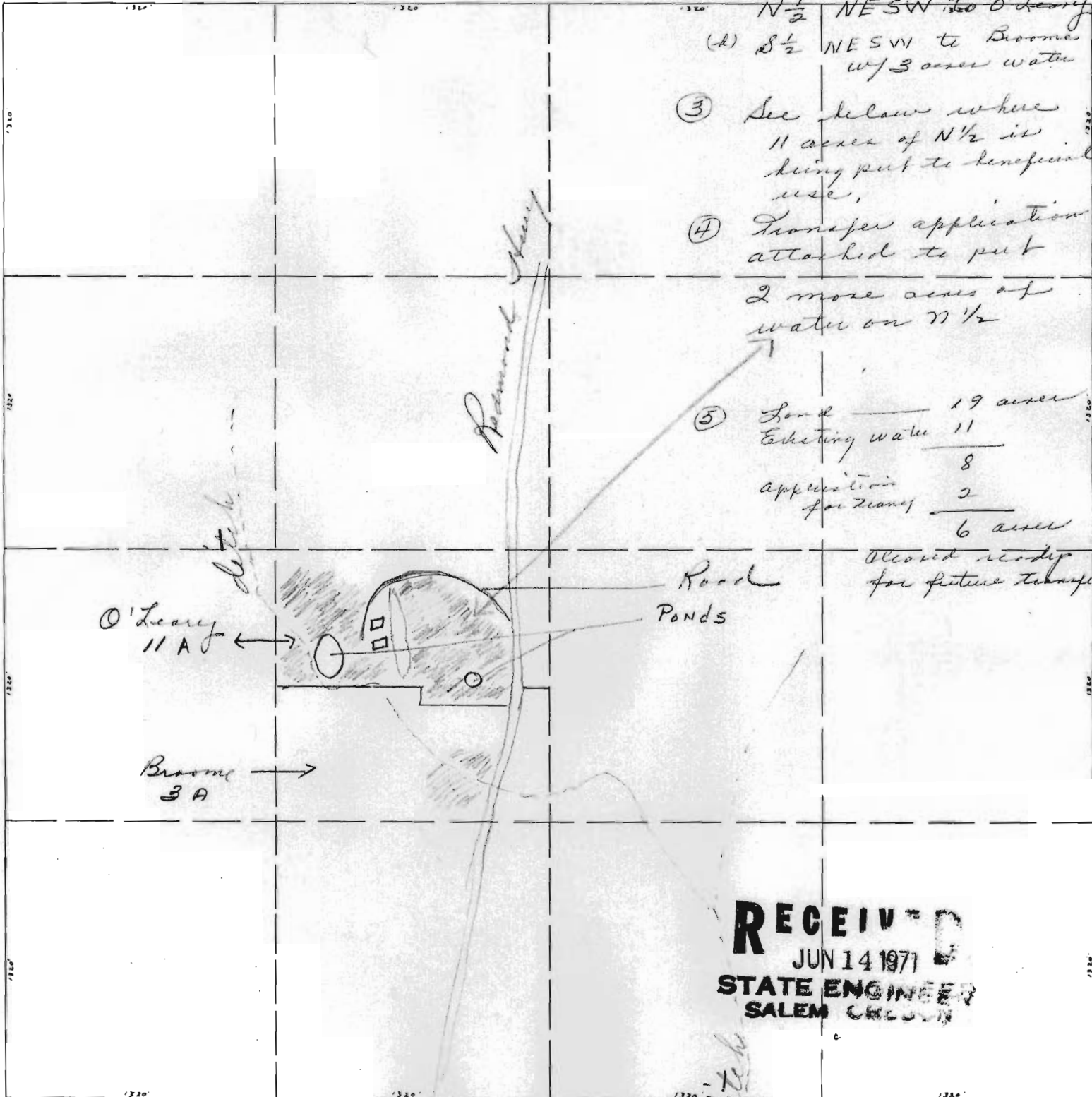

RECEIVED
JUN 14 1971
STATE ENGINEER
SALEM OREGON