

T.34S. R.1W. W.M.

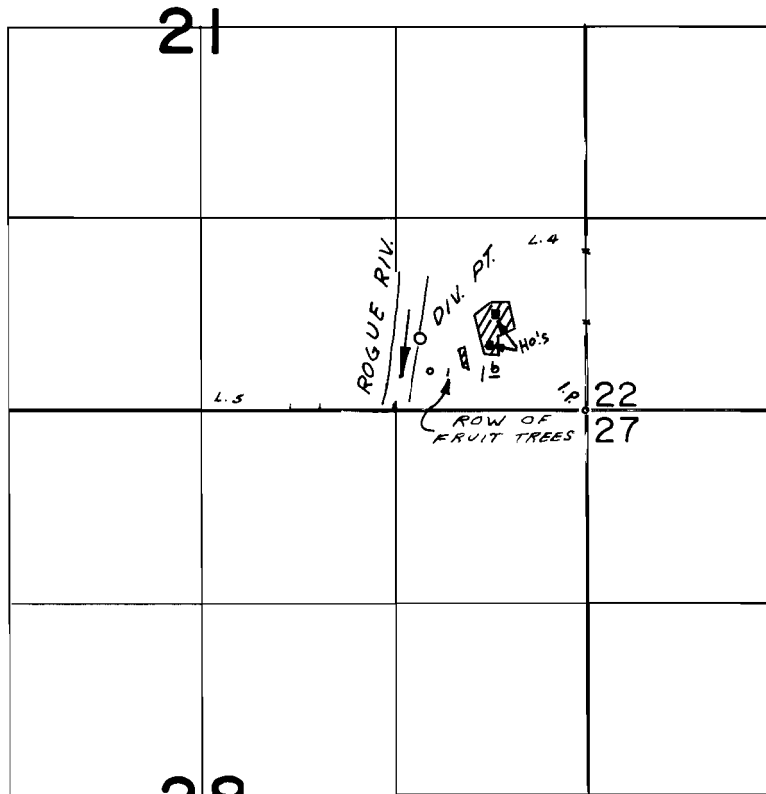

DIV. PT. LOC. 500' N. & 1140' W. FROM SE COR. SEC. 21

**FINAL PROOF SURVEY**  
UNDER

Transfer No. 2619  
Application No. .... Permit No. ....  
IN NAME OF

..... JAMES F. JOHNSON .....

Surveyed APR. 26. 1975., by L.H. NUNN.....