

T.38S.R.3W.W.M

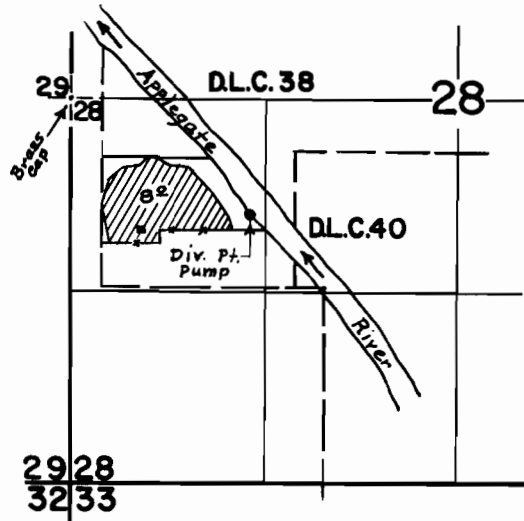

Diversion Point is located 790' S. & 1235' E. from the W¹/₄ Cor. Sec. 28.

FINAL PROOF SURVEY
UNDER

Transfer No. 2715
Application No. Permit No.
IN NAME OF
Frank Gates

Surveyed Mar. 4 1976, by D.C. Hendrix

RECEIVED

JUN 14 1976

WATER RESOURCES DEPT
SALEM, OREGON

T. 40S., R. 7 & 8 W., W.M.

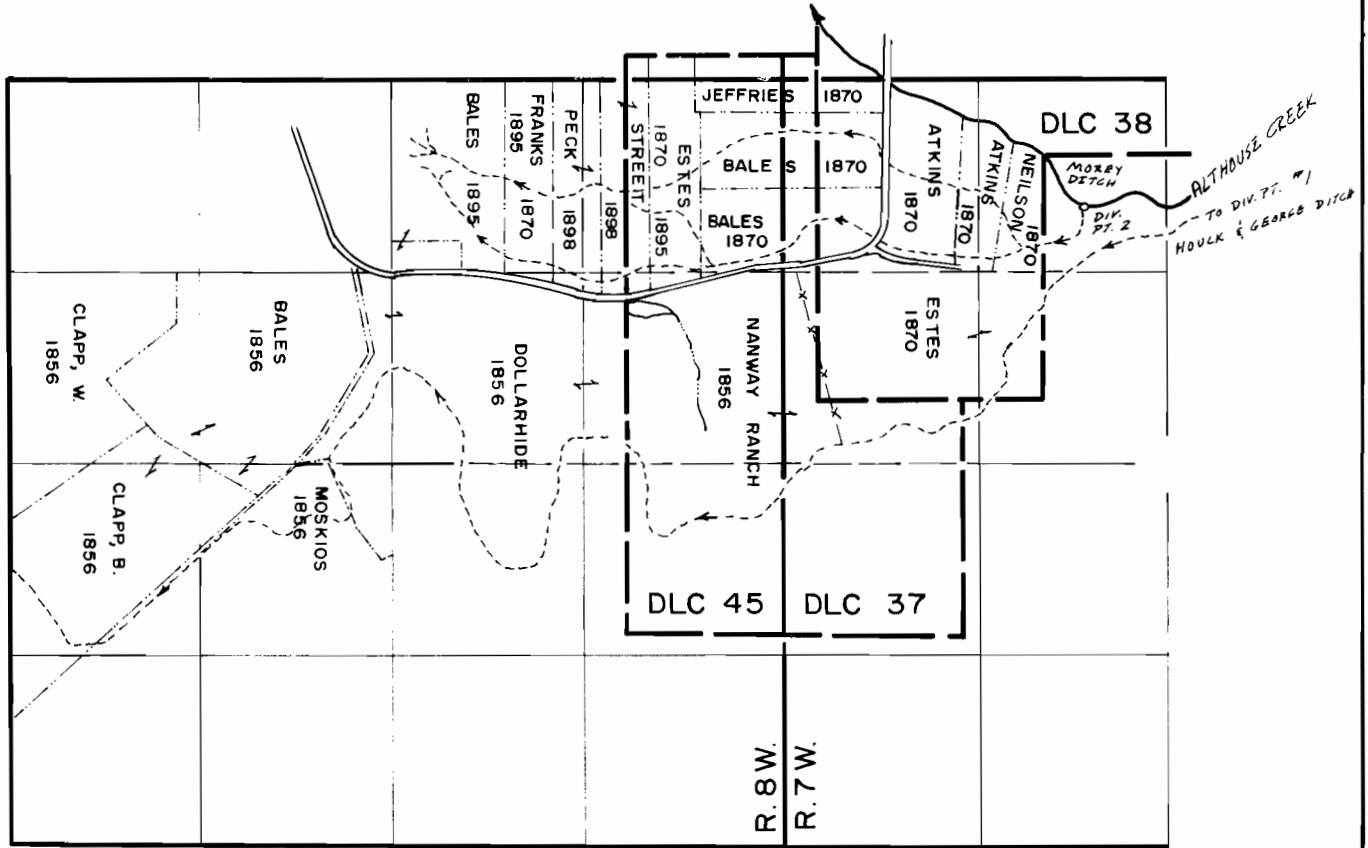

SCALE 1" = 1320'

Cert. 2713 = 1856, 1859, 1870.
 Cert. 2715 = 1856, 1895.

FINAL PROOF SURVEY UNDER

Certificates 2713 & 2715

Application No. Permit No.
 IN NAME OF

..... PROPERTY OWNERS OVERLAY

Surveyed 19....., by