

RECEIVED
FEB 28 1973

WATER RIGHT PLAT
Roseburg Lumber Company
Dillard, Oregon

STATE ENGINEER
SALEM, OREGON

T. 28 E 29 S. R. 6 W.M.M.
Scale 4" = 1 Mile

For Change of Diversion Point, Place of Use, And Use of
Water For Permit No. 29249.

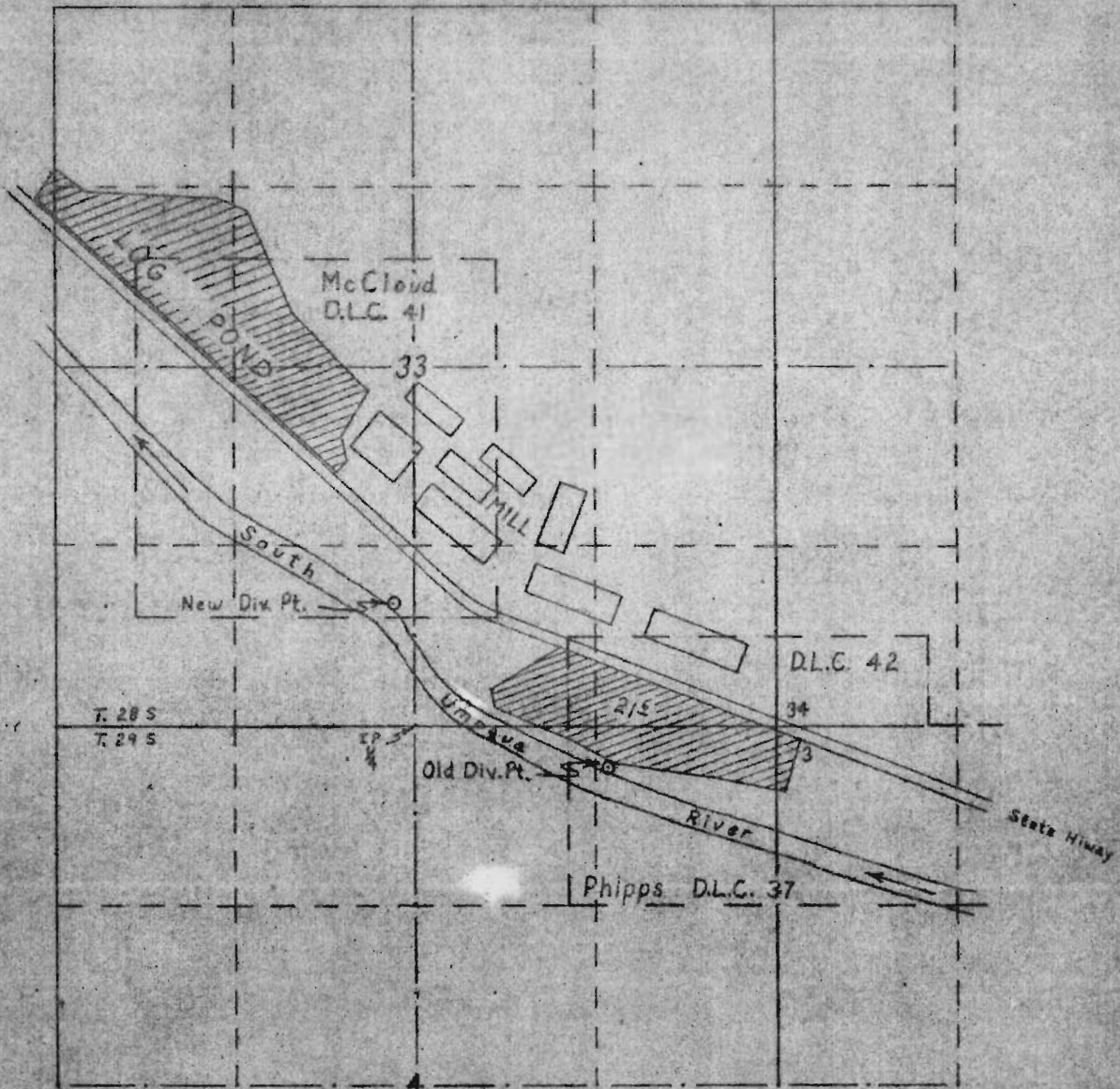

Old Div. Pt. Located 1410' E And 280' S From N 1/4 Cor. Sec. 4
New Div. Pt. Located 160' W And 900' N From N 1/4 Cor. Sec. 4