

This map is only to be used to identify the location of the points of diversion found during an inspection of the project on August 16, 1988, by field staff of the Water Resources Department. The location of the lands illustrated herein do not agree with the location of the Decreed Rights and should not be considered as any determination of the proper location of the underlying rights for which Groundwater Permit No. G-9178 are to supplement.

Steve Brown
Certificates
February 15, 2001

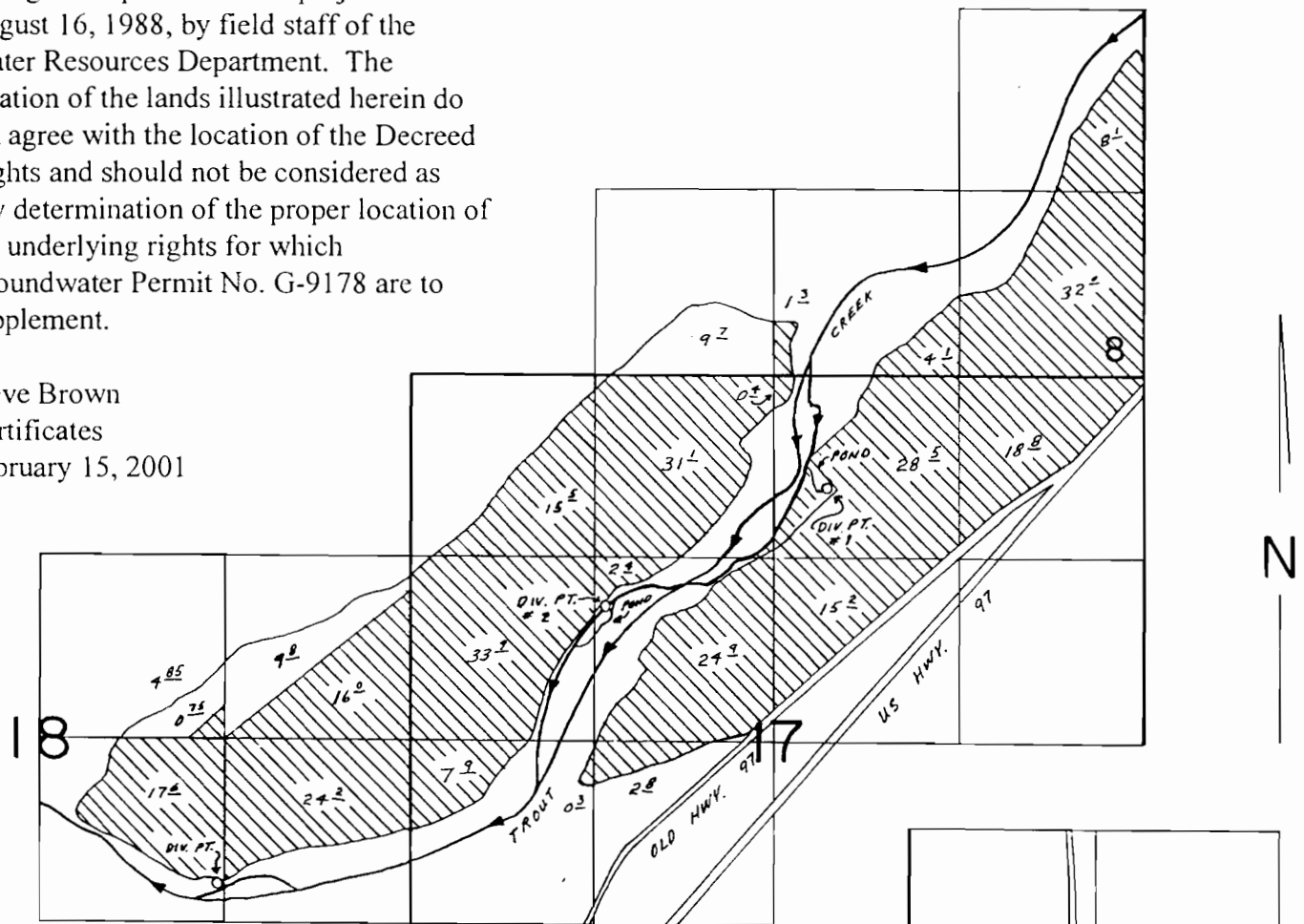

DIV. PT. #1 LOC: 800'S 2260'W FROM NE COR. SEC. 17
 DIV. PT. #2 LOC: 1650'S 1400' E FROM NW COR. SEC 17
 DIV. PT. LOC: 1050'S 1280'E FROM C.VA COR. SEC 18



WELL LOC: 150'N 1230'E FROM SW COR. SEC. 20

SCALE: 1"=1320'

FINAL PROOF SURVEY
 UNDER

T-2786
 T-2798
 Application No. G-8956 Permit No. G-9178.....
 IN NAME OF

.....RONALD B. OCHS.....

Surveyed AUG. 16, 1988, by B. BISHOP.....

Transfer No. 2798

2 of 2