

T.23S.R.7W.W.M.

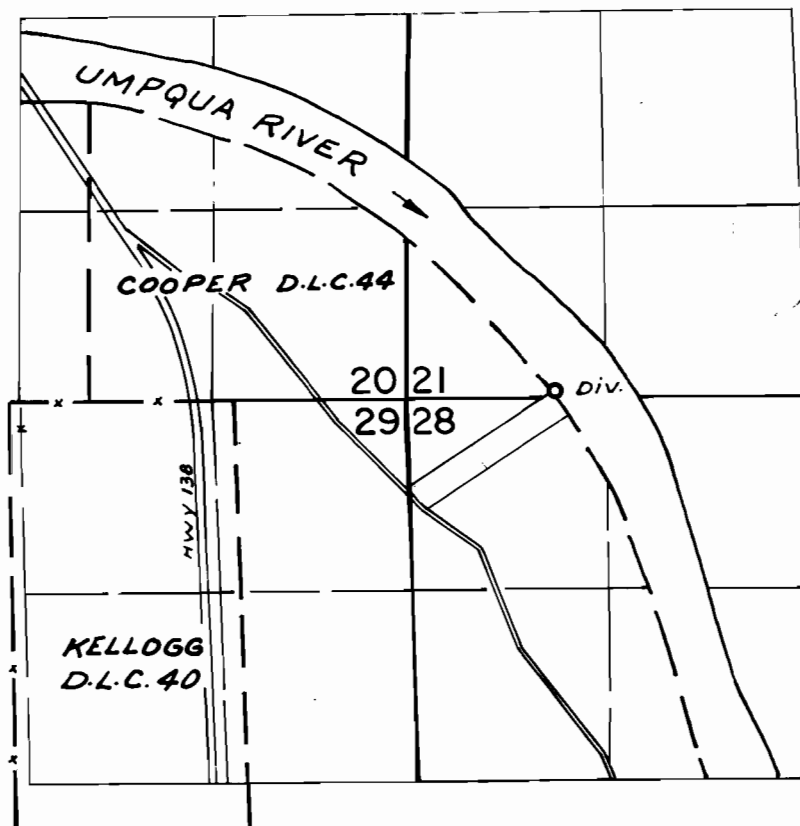

DIV. LOC: 60' N. & 3750' E. FROM N.W. COR. D.L.C. 40

FINAL PROOF SURVEY UNDER

TRANSFER NO. 2893
Application No. Permit No.
IN NAME OF

..... GEORGE F. & GLORIA M. PURCELL

Surveyed MAY 13, 1976, by R. MUCKEN