

21/22
28/27
N

RECEIVED
APR 16 1975
STATE ENGINEER
SALEM, OREGON

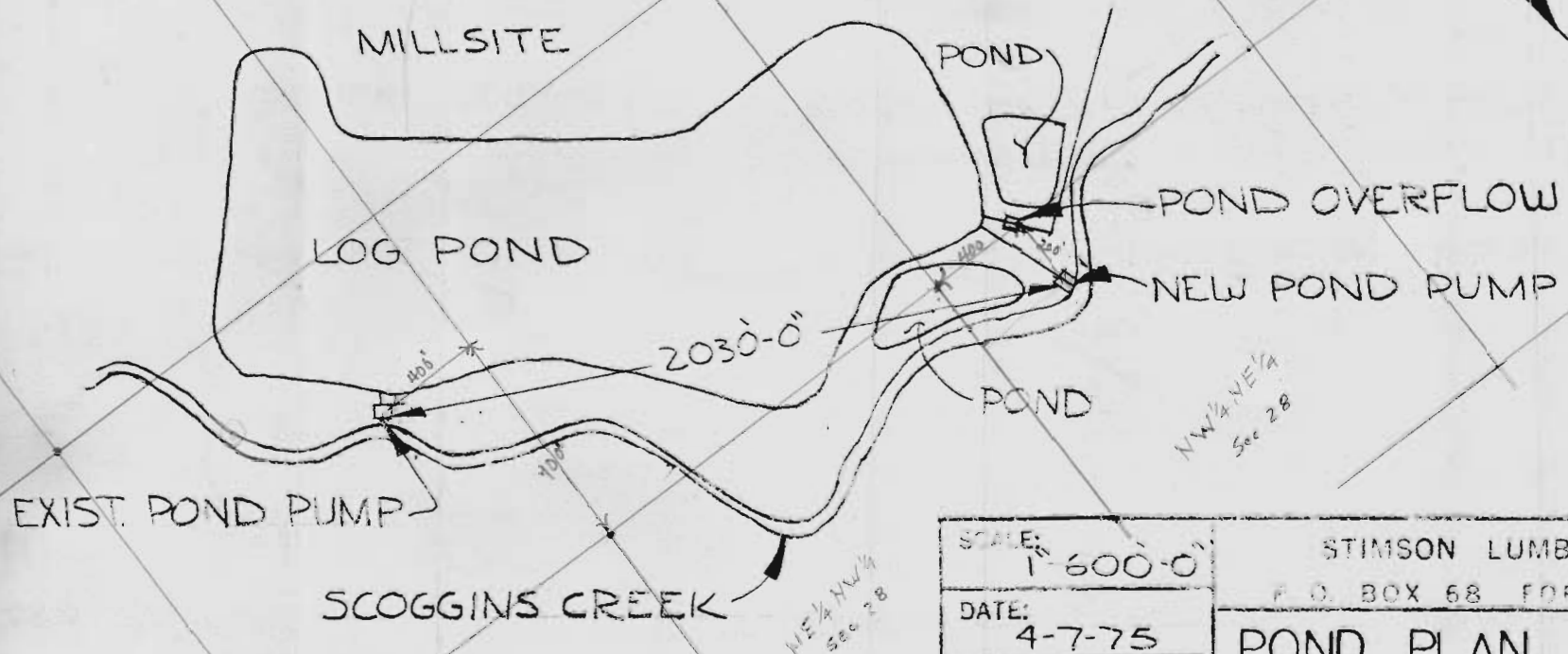

RECEIVED
JAN 20 1976
WATER RESOURCES DEPT.
SALEM, OREGON

20/21
29/28

SCALE: 1"=600'-0"	STIMSON LUMBER COMPANY P. O. BOX 68 FOREST GROVE OR.
DATE: 4-7-75	POND PLAN
DWN. BY: B. FRITZ	
APP. BY:	Tp. 1 S. R. 4 W.
	DWG. NO:

T-3204