

Ralph Boese Transfer showing development of the NE $\frac{1}{4}$ SW $\frac{1}{4}$ Sec. 1 T.18S. R.12E.W.M.

Additional water rights will be transferred out as sales are made.

SECTION 1 T.18S. R.12E.W.M.
DESCHUTES COUNTY

1"=400'

dead, numbers
200
400
1000
1100
1200
1300
1500
901
918
910

18 12 1

See Map 17 12 36

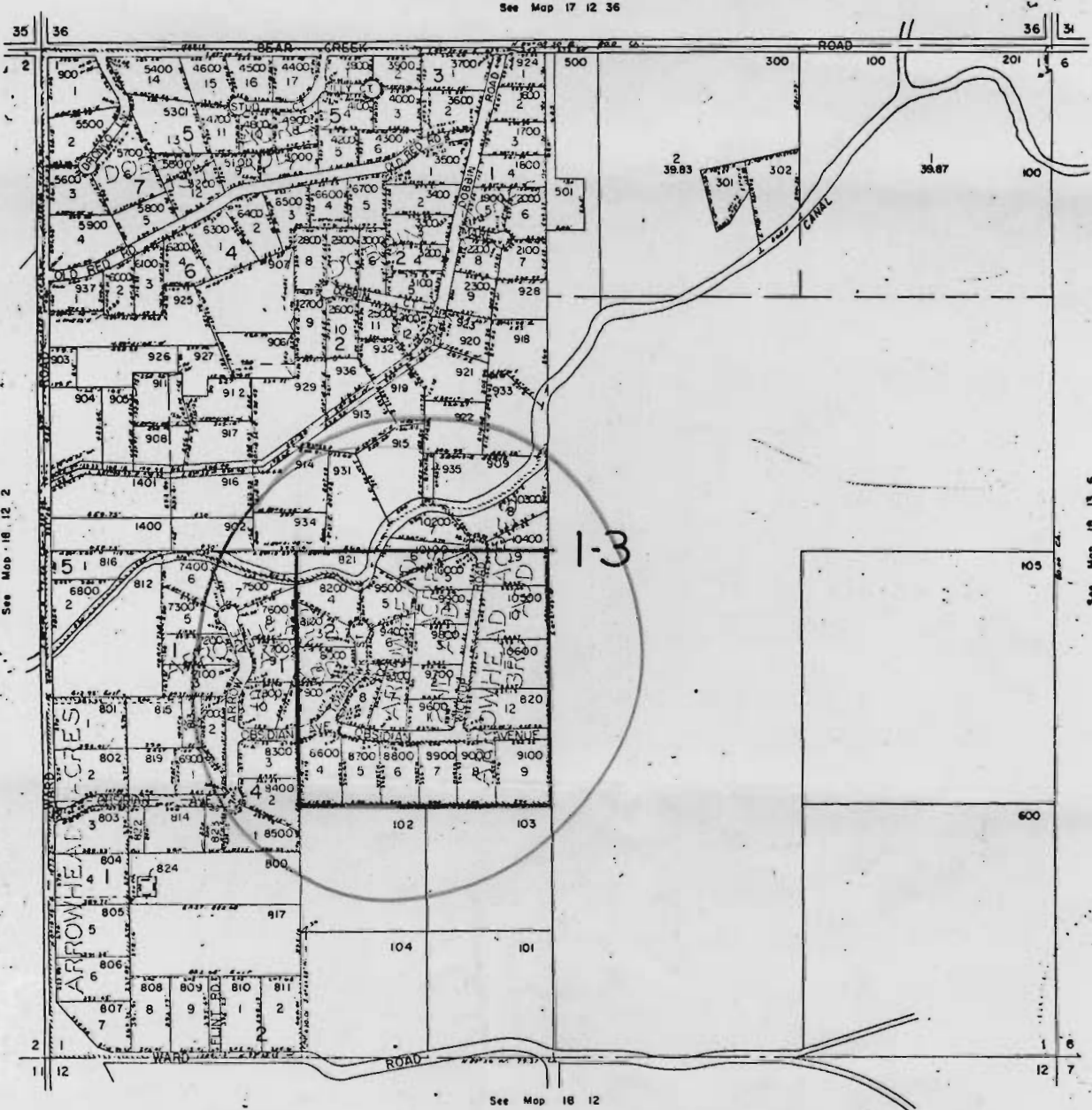

See Map 16 12 2

See Map 16 13 6

See Map 16 12

RECEIVED
JAN 23 1976
WATER RESOURCES DEPT.
SALEM, OREGON

RECEIVED
MAY 27 1975
STATE ENGINEER
SALEM, OREGON

18 12 1

T-3241

Transfer Ralph Boese to the following -

Lee Edwards	10.0
R. H. Britton	2.0
Earl Lynn	3.00
Mills & Hicks	<u>6.5</u>
	21.5

SEC. 1 T.18 S R.12 E.W.M.

18 12

DESCHUTES COUNTY

SCALE: 1" = 200'

See Map 18-12-AC

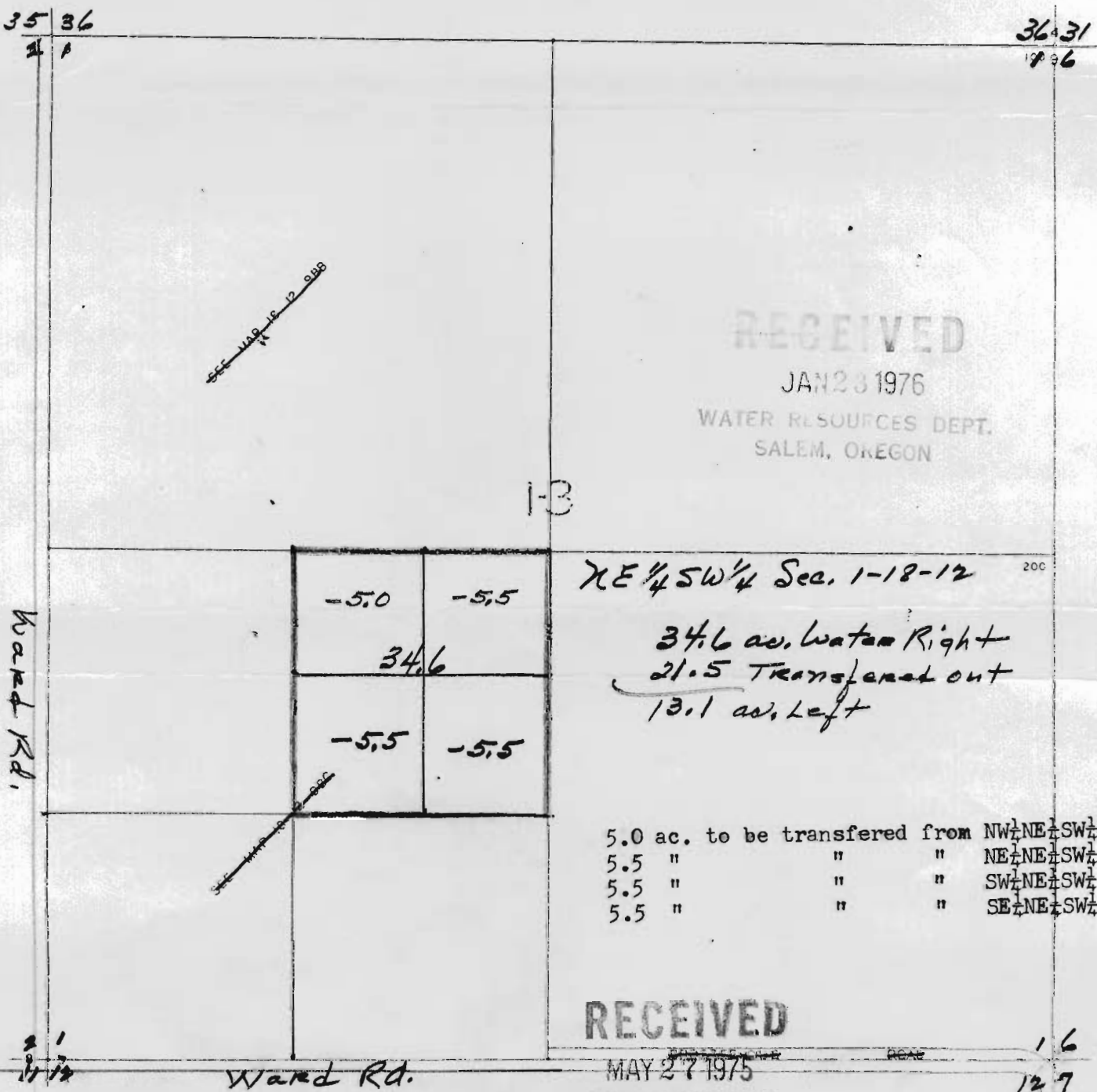

RECEIVED

JAN 23 1976

WATER RESOURCES DEPT.
SALEM, OREGON

13

Ward Rd.

35 36
31

36 31
18 12



NE 1/4 SW 1/4 Sec. 1-18-12

200

34.6 ac. Water Right
21.5 Transferred out
13.1 ac. Left

5.0 ac. to be transferred from	NW 1/4 NE 1/4 SW 1/4	Sec 1
5.5 "	" "	NE 1/4 NE 1/4 SW 1/4 "
5.5 "	" "	SW 1/4 NE 1/4 SW 1/4 "
5.5 "	" "	SE 1/4 NE 1/4 SW 1/4 "

RECEIVED

MAY 27 1975

STATE ENGINEER
SALEM, OREGON

Ward Rd.

16
12 7

18 12

T-2041

Transfer Ralph Boese to the following

Mills & Hicks	(2.0 ac. NW $\frac{1}{4}$ SE $\frac{1}{4}$ SE $\frac{1}{4}$ Sec. 13 T. 18 R. 12		
	(2.0 " NE $\frac{1}{4}$ SE $\frac{1}{4}$ SE $\frac{1}{4}$ " " " "		
	(2.0 " SE $\frac{1}{4}$ SE $\frac{1}{4}$ SE $\frac{1}{4}$ " " " "		
	(0.5 " SW $\frac{1}{4}$ SE $\frac{1}{4}$ SE $\frac{1}{4}$ " " " "		
Lee Edwards	10.0 " E $\frac{1}{2}$ SE $\frac{1}{2}$ NE $\frac{1}{2}$ " 24		
Earl Lynn	3.0 " E $\frac{1}{2}$ NE $\frac{1}{2}$ NW $\frac{1}{2}$ NE $\frac{1}{2}$ " 24		
R. M. Brittson	2.0 " W $\frac{1}{2}$ NE $\frac{1}{2}$ NW $\frac{1}{2}$ NE $\frac{1}{2}$ " 24		
	21.5 Total		

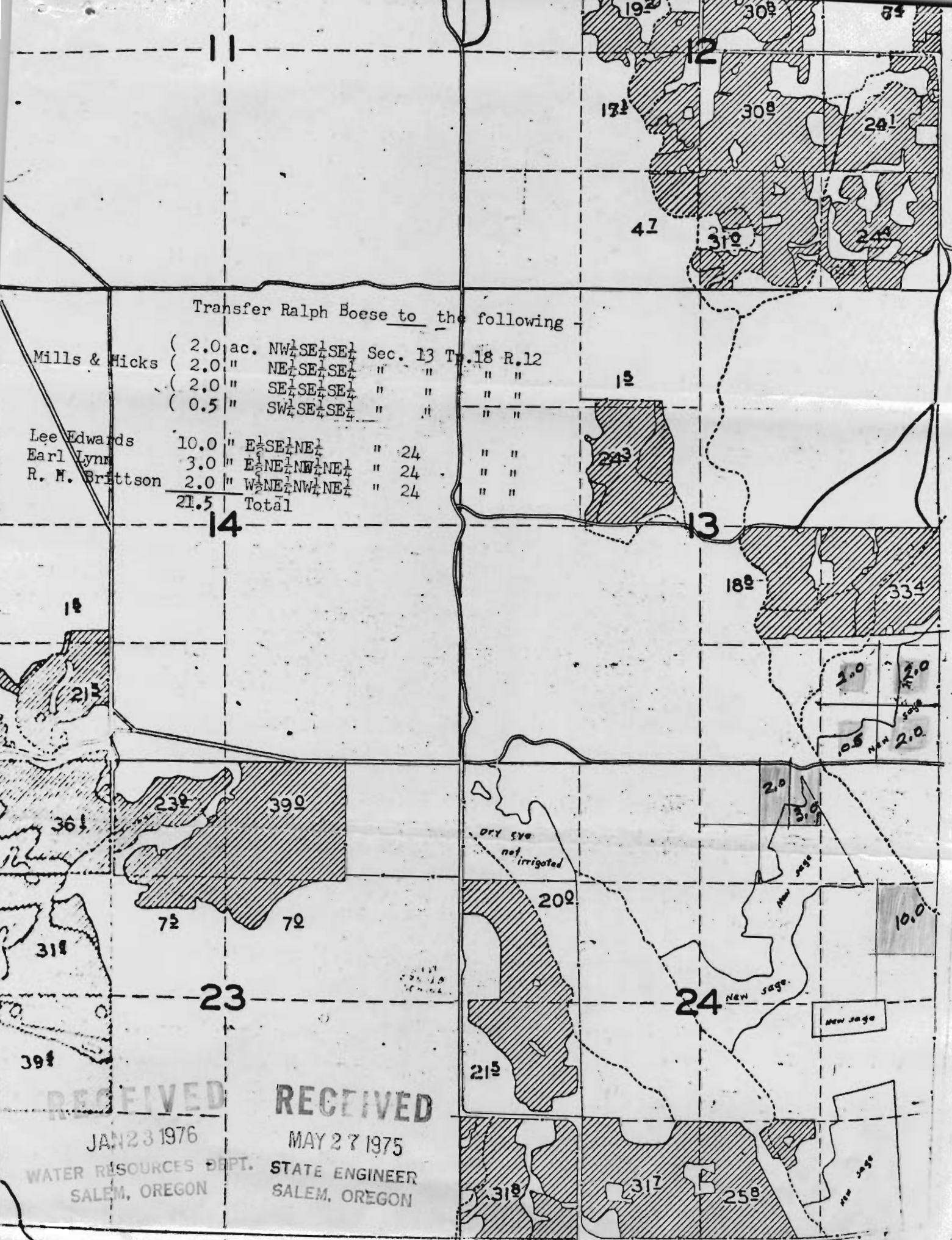

RECEIVED
 JAN 23 1976
 WATER RESOURCES DEPT.
 SALEM, OREGON

RECEIVED
 MAY 27 1975
 STATE ENGINEER
 SALEM, OREGON

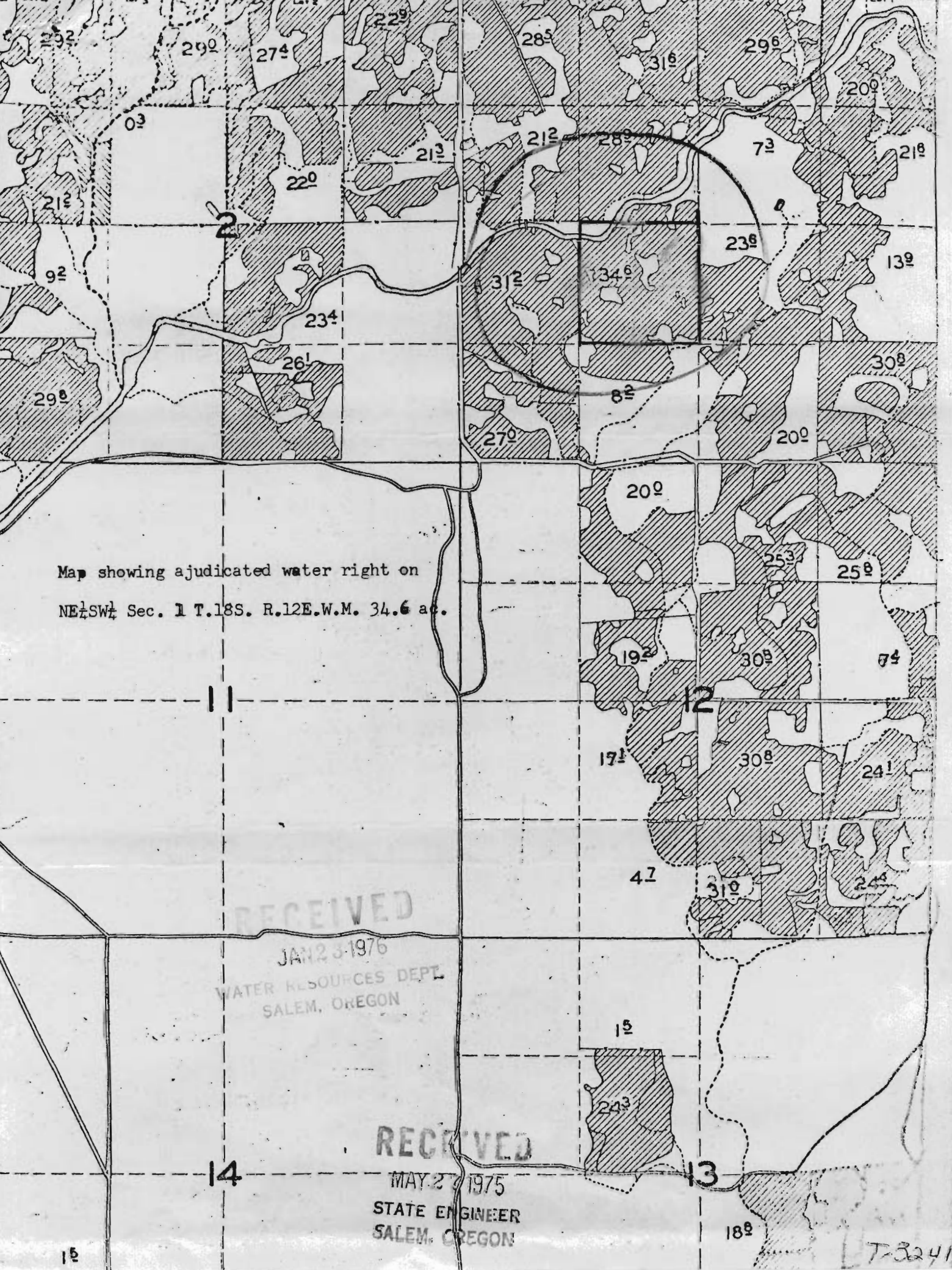

Map showing adjudicated water right on
NE $\frac{1}{4}$ SW $\frac{1}{4}$ Sec. 1 T.18S. R.12E.W.M. 34.6 ac.

RECEIVED
JAN 23 1976
WATER RESOURCES DEPT.
SALEM, OREGON

RECEIVED
MAY 27 1975
STATE ENGINEER
SALEM, OREGON

T-3241

T-3241

PROPERTY OF: PIERRE J. DE SANTIS JR.
60805 Billadeau Rd.
Bend, Oregon 97701

NW 1/4 OF SE 1/4 OF SE 1/4 OF SEC. 13 T. 18 S., R. 12 E
W.M.
10 ACRES

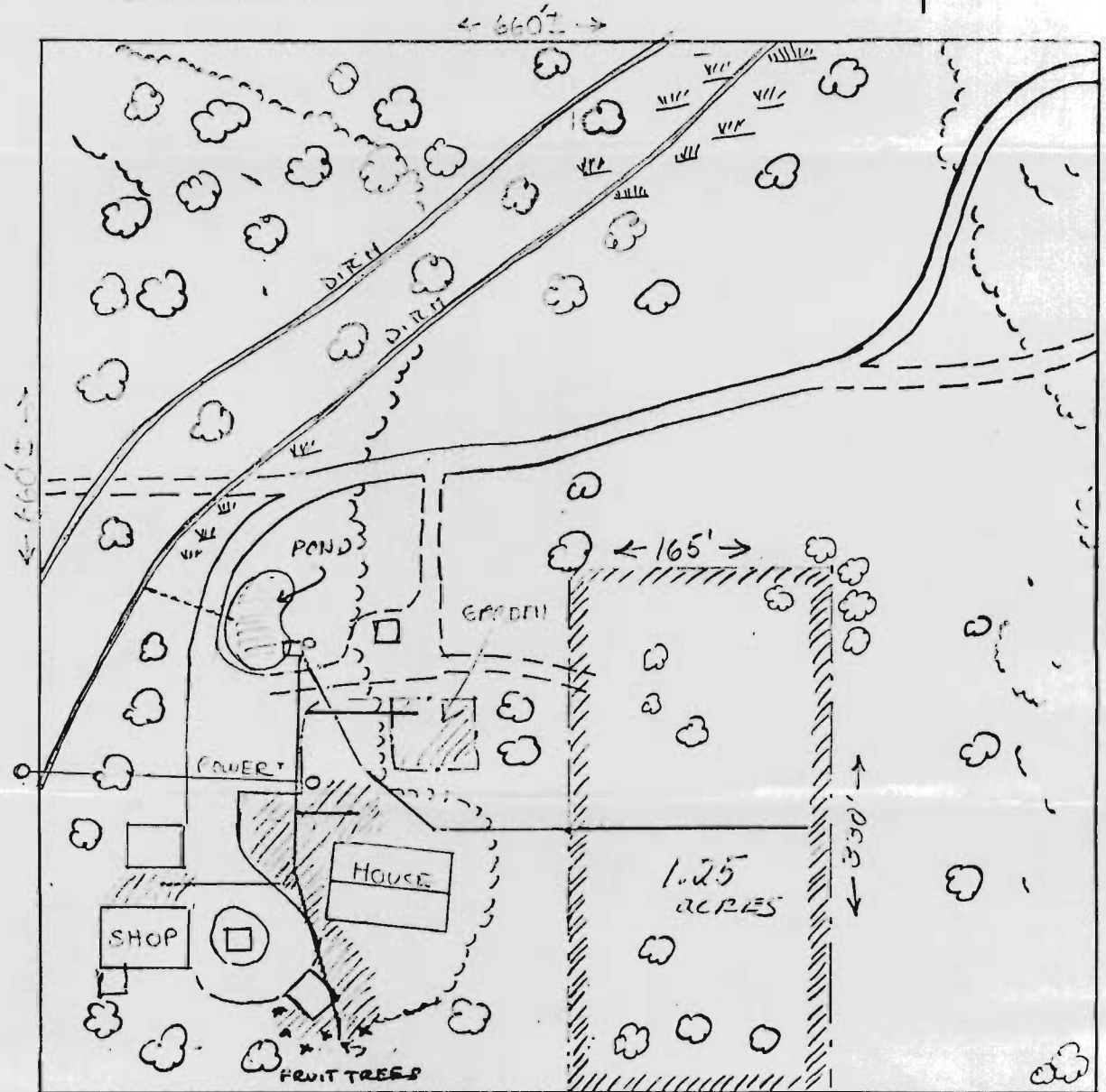
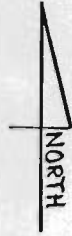

RECEIVED

SEP 29 1980

WATER RESOURCES DEPT
SALEM, OREGON

////// IRRIGATED AREAS: APPROX 2 ACRES

----- UTTERLINES

~~~~~ shallow ROCK CREEKS

☉ TREES (JUNIPER, PINE)