

T.3N.,R.27E.,W.M.

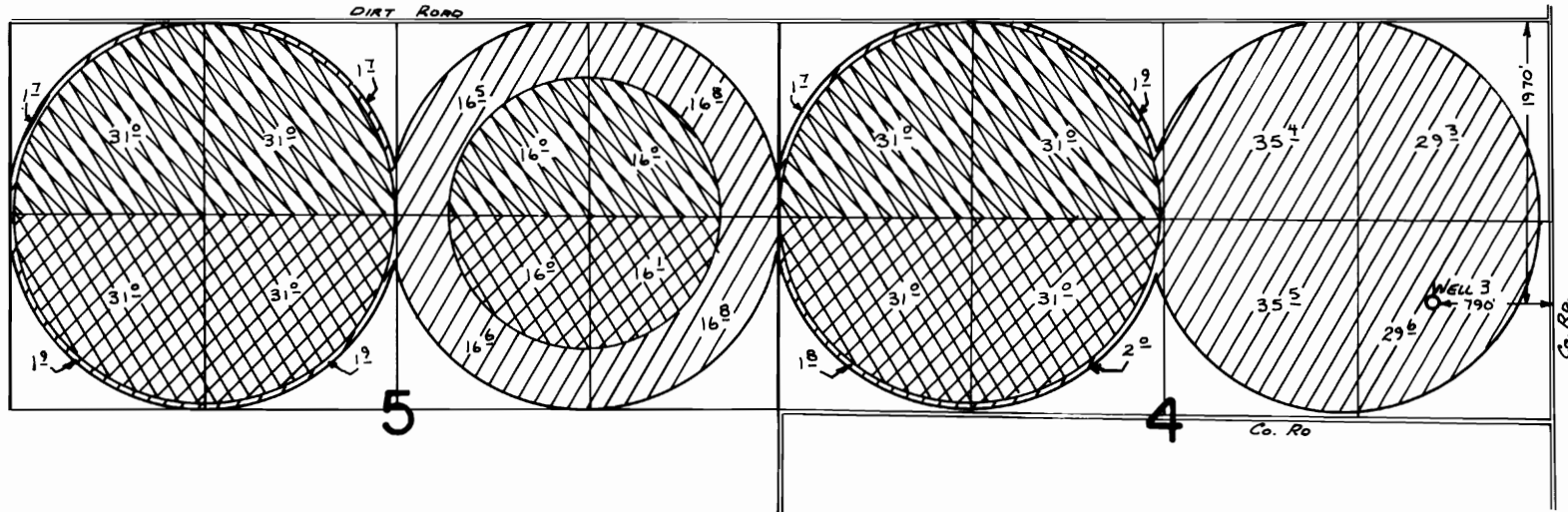

T.4N.,R.27E.,W.M.

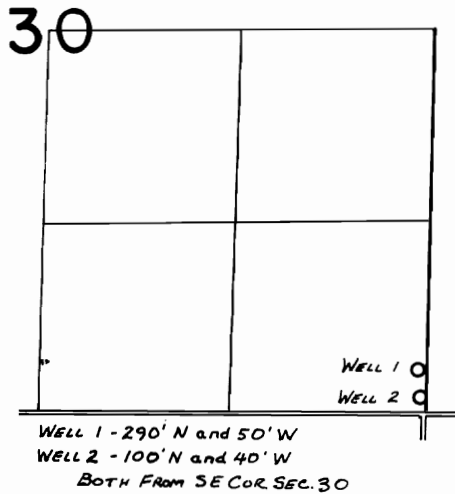

SUPERSEDING FINAL PROOF SURVEY UNDER

Transfer No. 3393
Application No. G-3092 Permit No. G-2823
G-5145 G-4878

IN NAME OF

JIM & DON KEY

Surveyed August 4, 1978 by R. BARWIN
April 11, 1975 by R. G. MUCKEN

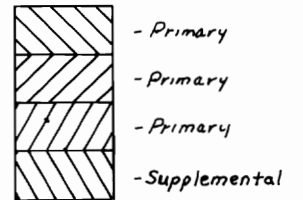

PTS 1978-P-D
272-169
NE-1/4-123, 115
Redrafted 2/15/83 LMT