

T. 4N., R. 29E., W.M.

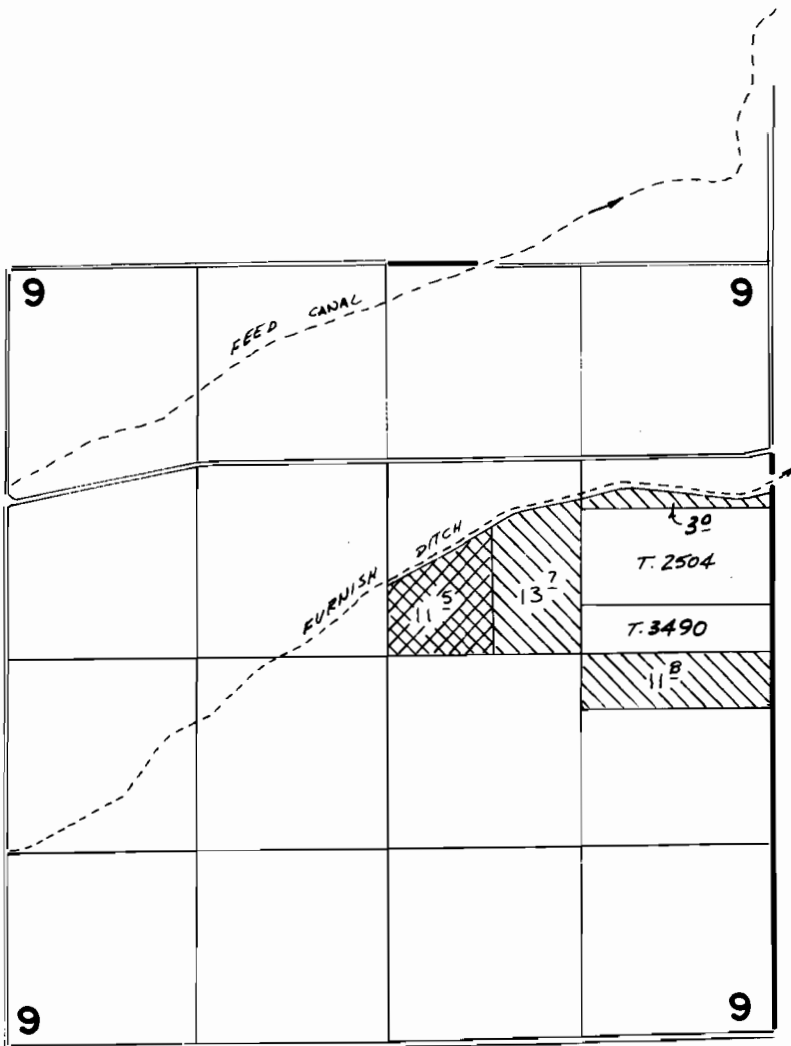

T. 3N., R. 30E., W.M.

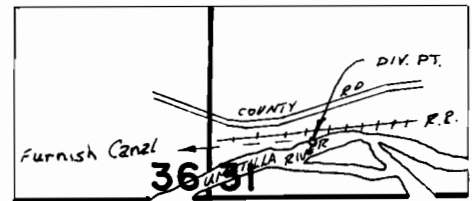

DIV. PT. LOCATED 380' N + 650' E. FROM SW. COR.
SEC. 31 T. 3N., R. 30E., W.M.



PRIMARY-F.D.



PRIMARY - FURNISH DITCH
SUPP'L - PERMIT 30373

FINAL PROOF SURVEY

UNDER

TRANSFER 3489

IN NAME OF

JOHN F. WALCHLI

Surveyed 8-28 1981, by V.L. Church