

T.5S. R.7W. W.M.

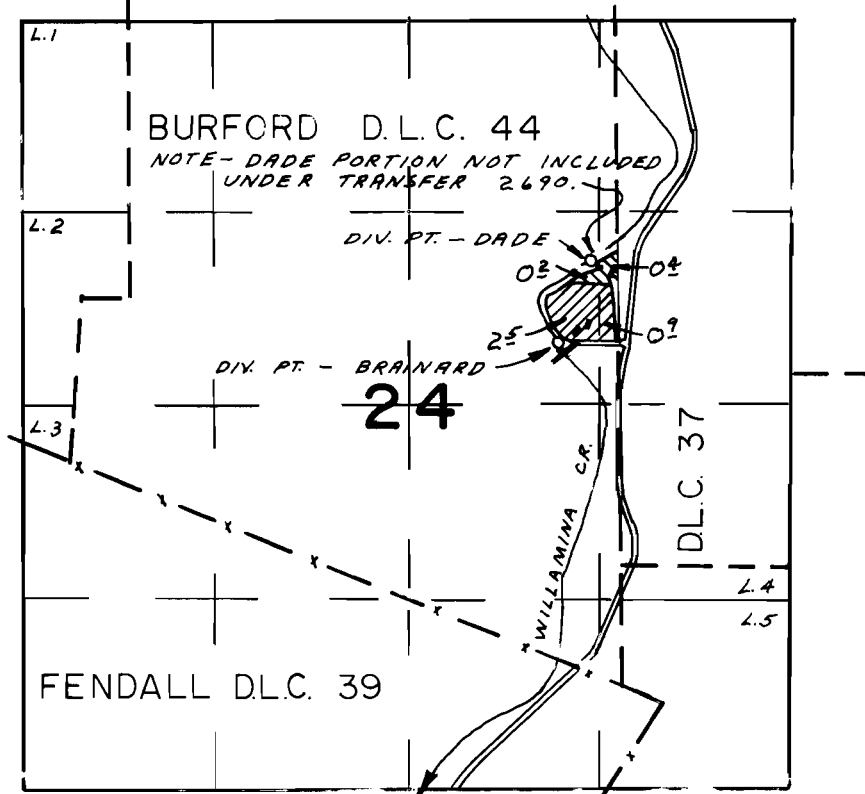

BRAINARD DIV. PT. LOC. 2480' N & 710' W.; DADE DIV. PT. LOC. 3040' N & 490' W. BOTH FROM NE CORNER FENDALL D.L.C. 39.

FINAL PROOF SURVEY UNDER

TRANSFER NO. 2690
Application No. Permit No.
IN NAME OF

ROBERT BRAINARD

Surveyed OCT. 12... 1976, by L.H. NUNN.....