

T.15S. R.15 & 16E. W.M.

T.16S. R.15E. W.M.
S 1/2, SE 1/4, SEC. 1

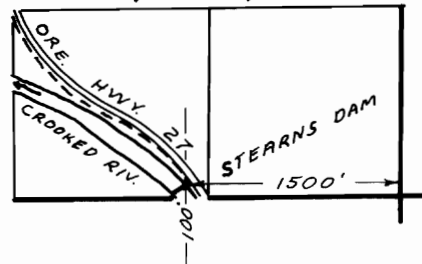
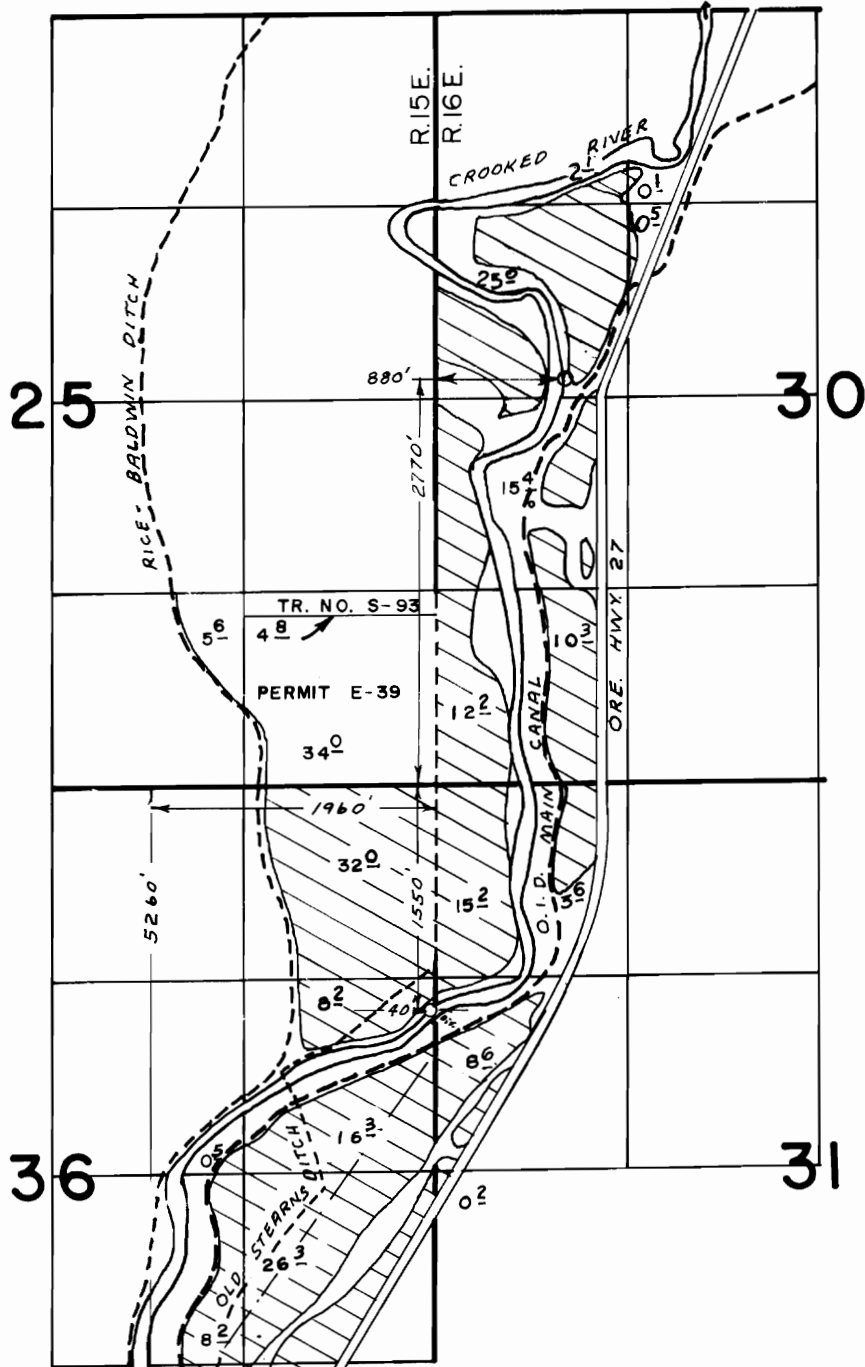

FINAL PROOF SURVEY
UNDER

TRANSFER NO'S 3676 & 4292

Application No. Permit No.
IN NAME OF

WILLIAM H. PLEDGER

Surveyed JUL. 19. 1979., by L.H. NUNN.....