

Section 28, T.16S. R.12E.W.M.
DESCHUTES COUNTY

T-3773
"TO"

16 12 2
Tax Lot 500 Canceled

1" = 400'

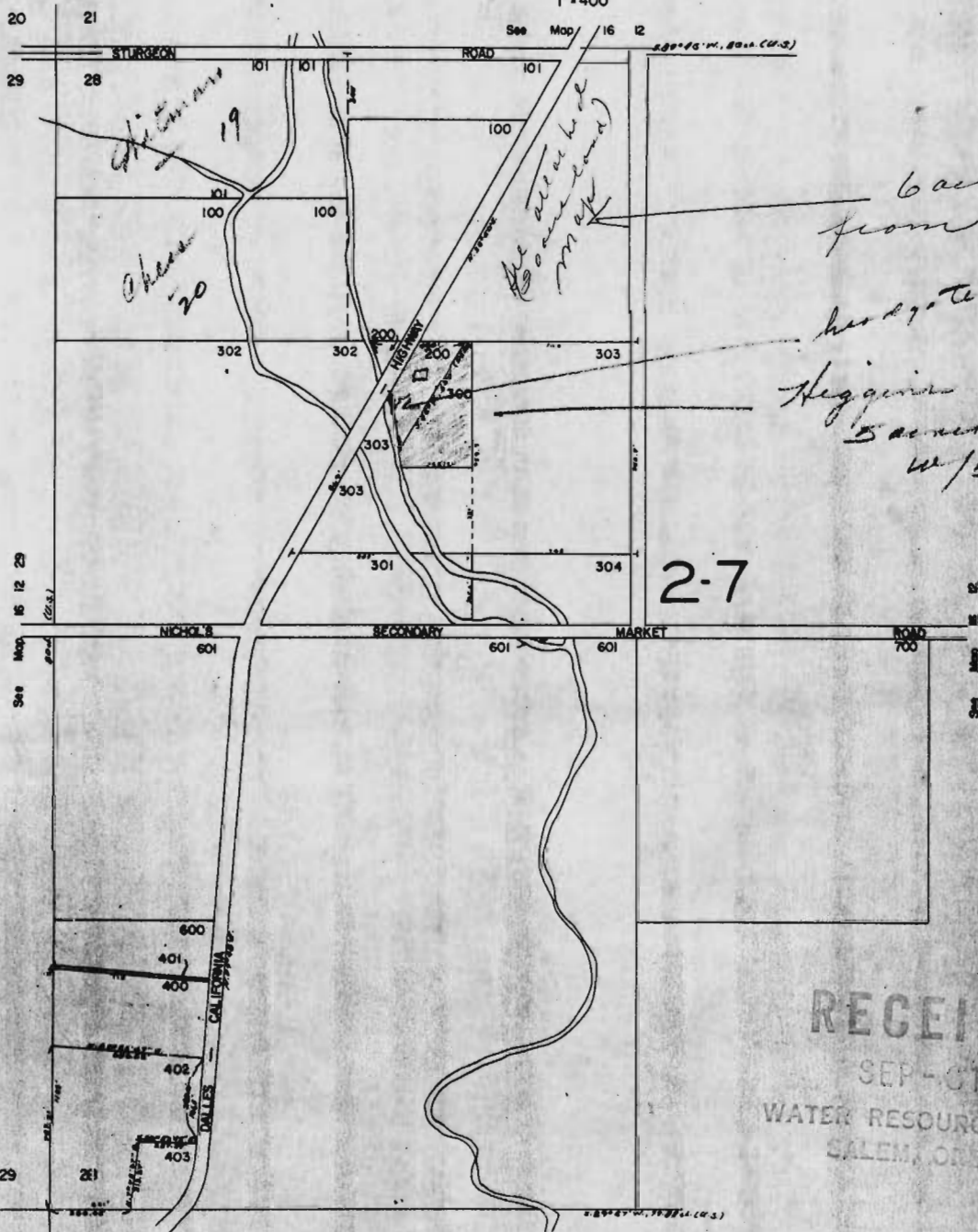

21	22
28	27

2-7

RECEIVED
SEP - 6 1977
WATER RESOURCES DEPT
SALEM, OREGON

28	27
33	34

See Map 16 12

The N.W & S.W of SE 4 9-17-12

Chas Church
removing 10 acres of water
6 acres going to 28-16-12 Higgins

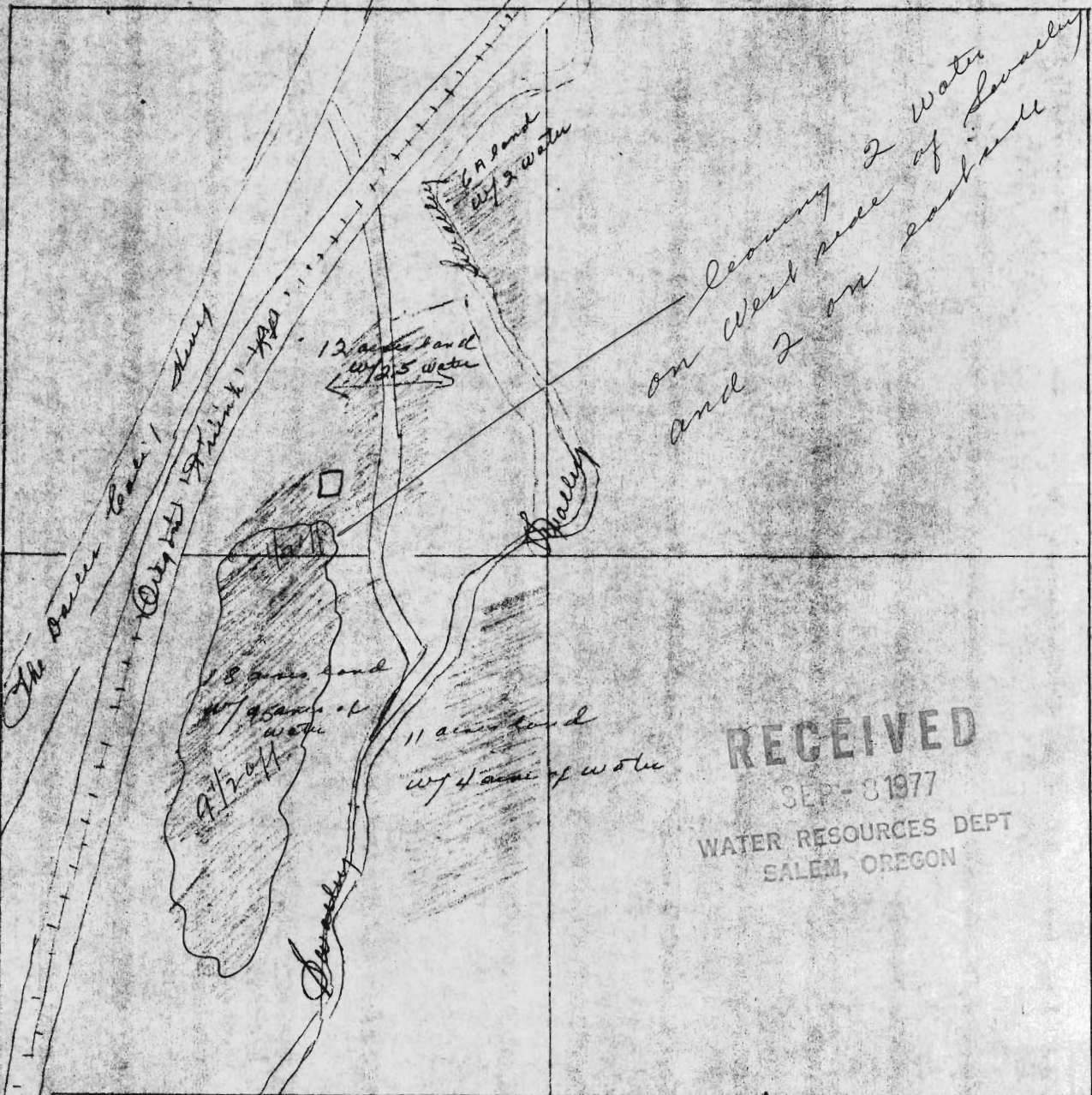

RECEIVED
SEP - 8 1977
WATER RESOURCES DEPT
SALEM, OREGON

T-3773

SEC. 9 T.17S. R.12 E.W.M.

601
614
615

17 12

DESCHUTES COUNTY

SCALE: 1" = 400'

See Map 17 12 4

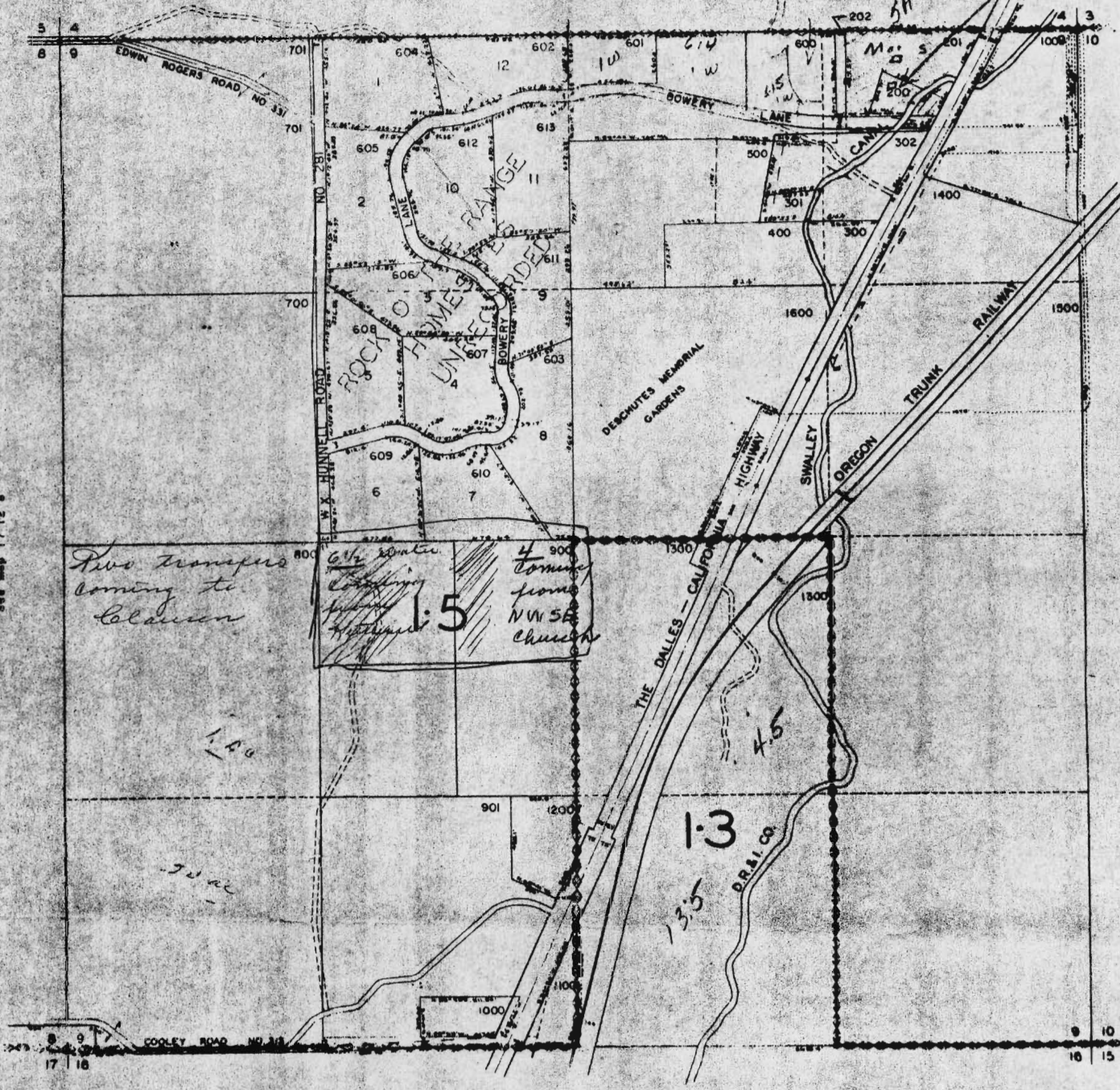

See Map 17-12-8

See Map 17 12 14

17 12

RECEIVED

SEP-8-1977

WATER RESOURCES DEPT
SALEM, OREGON