

T. 6N., R. 35E., W. M.

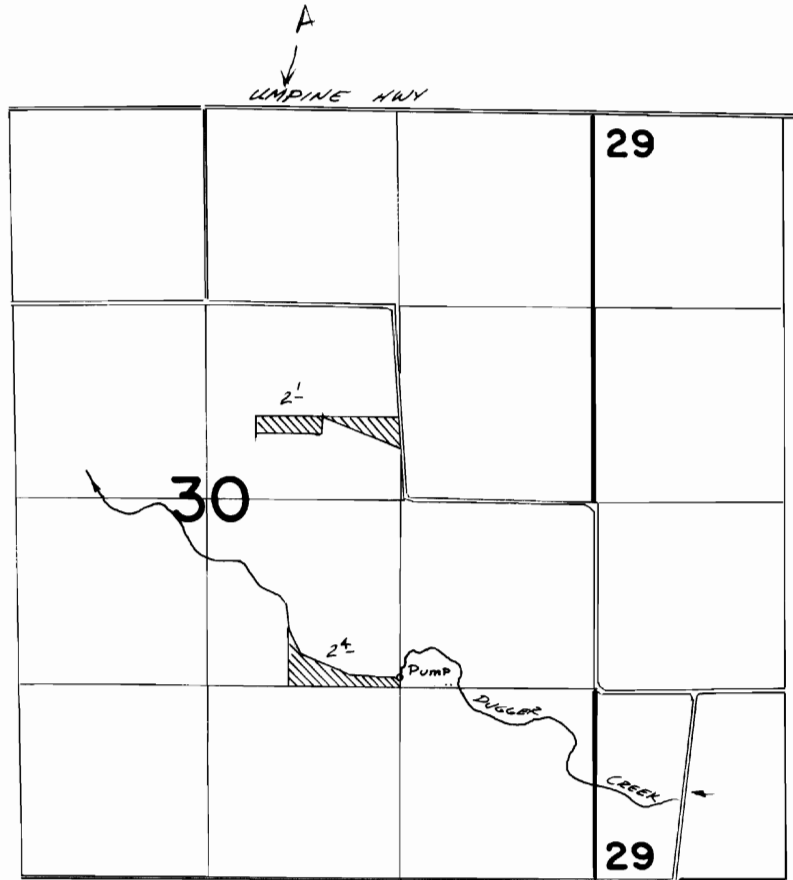

Pump Loc: 1390' N. + 1320' W. FROM SE COR. SEC. 30

FINAL PROOF SURVEY
UNDER

TRANSFER 3838

IN NAME OF

BURLINGAME... LAND... LIVESTOCK...

Surveyed *April 5* 19*82*, by *V.L. Church*