

# T3S. R1E. W1M.

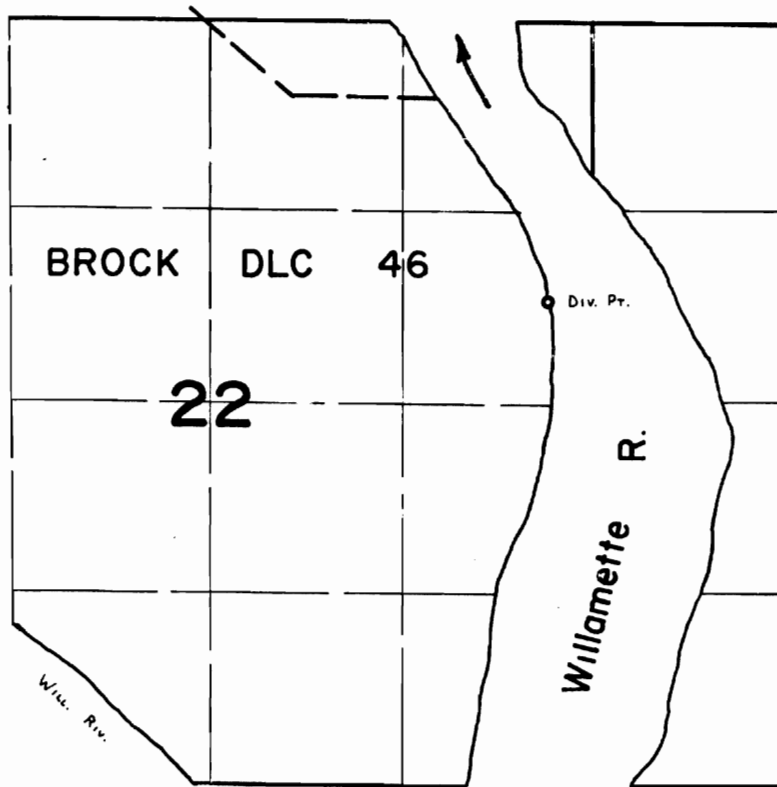

Div. Pt. Loc: 3340'N. & 2325'E. fr. S. 1/4 Cor. Sec. 22.

## FINAL PROOF SURVEY UNDER

TRANSFER NO. 3384

IN NAME OF

**R. G. & MARY ANNA BENNETT**

SURVEYED AUG. 3, 1981, BY *Alb...*