

# T.2S. R.12&13E. W.M.

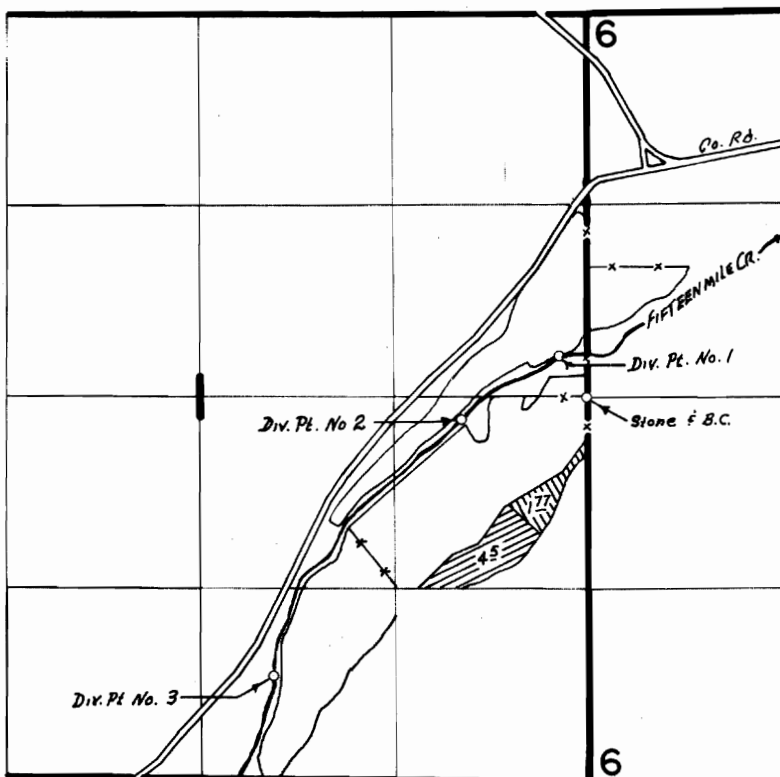

Div. Pts. Loc. No. 1 290' N. & 200' W., No. 2 150' S. & 870' W.,  
 No. 3 1910 S. & 2170' W. All From The E1/4 Cor.  
 Sec. 1

	TRANSFER	3892
	TRANSFER	3893

## FINAL PROOF SURVEY UNDER

Application No. \_\_\_\_\_ Transfer Nos. 3892, 3893, 3894, & 3895  
 Permit No. \_\_\_\_\_  
 IN NAME OF

..... LILLIAN LINDHORST .....

Surveyed May, 6 1983, by T. J. Paul .....