

T.7S., R.38E., W.M.

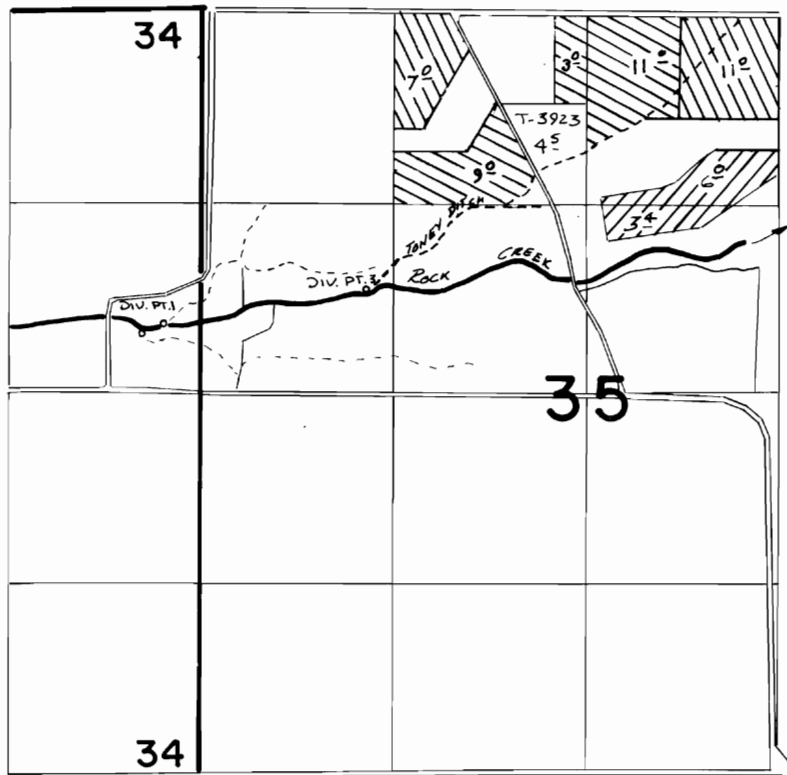

Div. Pt. 1 loc: 460' N. & 250' W. FROM E 1/4 COR. SEC. 34 - TONEY-BLIZE DITCH

Div. Pt. 3 loc: 710' N. & 1130' E FROM W 1/4 COR. SEC. 35 - TONEY DITCH

FINAL PROOF SURVEY
UNDER

TRANSFER 3924

IN NAME OF

DONALD STEPHENS

Surveyed April 13, 1982, by V.L. Church

-  1883
-  1894
-  1897