

T. 4N., R. 29E., W.M.

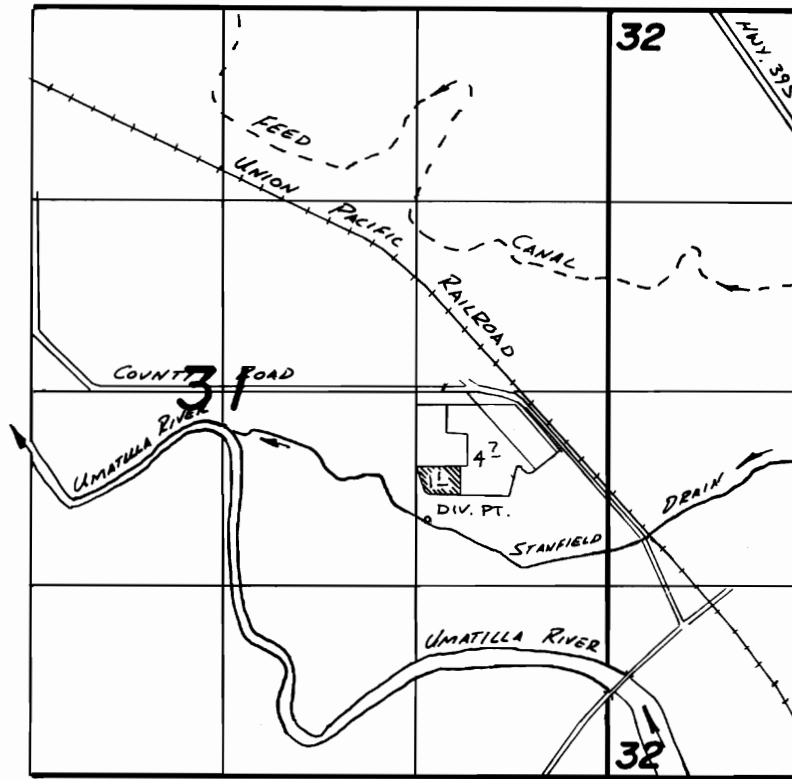

Div. Pt. Loc: 1770' N. & 1230' W. FROM SE COR. SEC 31

FINAL PROOF SURVEY
UNDER

TRANSFER 3944

IN NAME OF

BOISE CASCADE CORP. / CHEM. OP. DIV.

Surveyed FEB. 24, 1982, by *V. L. Church*