

# T.1 & 2S., R. 25E., W. M.

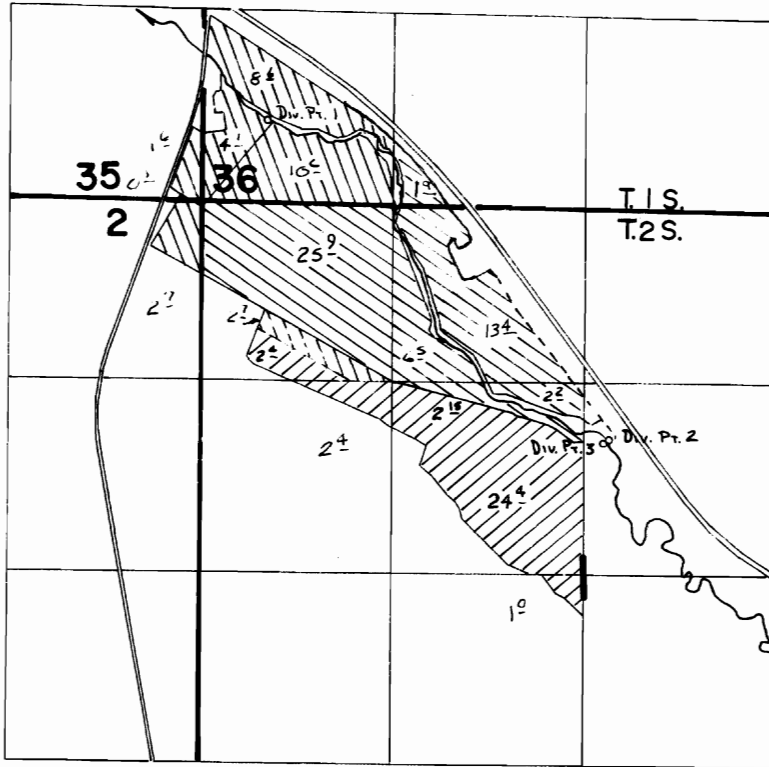

Div. Pt. 1 Loc: 560' N. & 450' E. FROM SW COR. SEC 36

Div. Pt. 2 Loc: 920' N & 160' E FROM CENTER SEC. 1

Div. Pt. 3 Loc: 910' N & 140' E FROM CENTER SEC 1



## FINAL PROOF SURVEY UNDER

### TRANSFER 4141, 3945

IN NAME OF

**HAROLD S. HUBER & JAMES S. BLOODSWORTH**

Surveyed July 14, 1983, by *E.L. Church*

-  1883 (T-4141)
-  1890 (T-3945)
-  1902 (T-4141)