

BUSSARD, LYCHE, et. al.

PROPOSED
WATER RIGHT TRANSFER

C-302



PROPOSED IRRIGATED AREA



AUTHORIZED IRRIGATED AREA

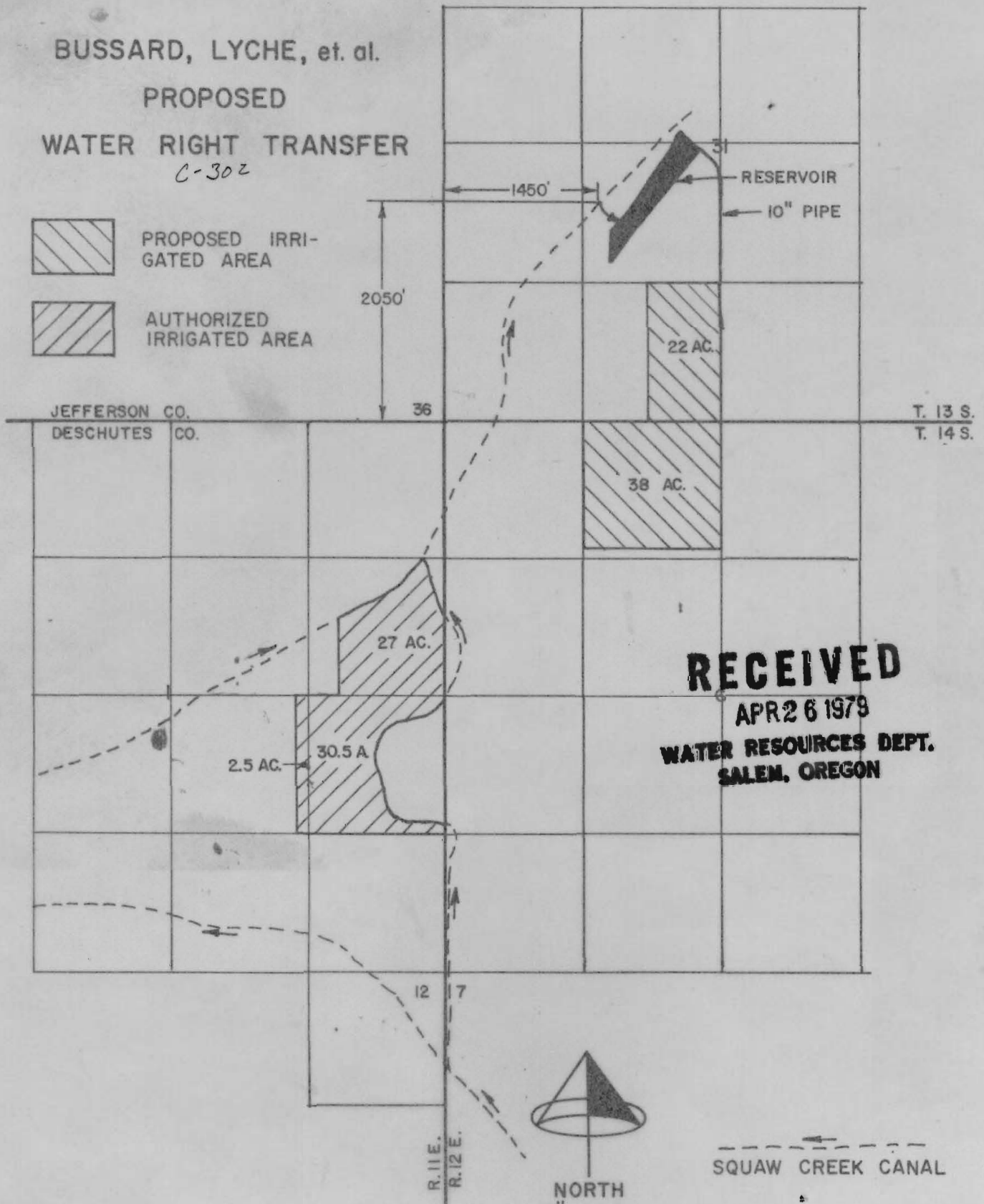

RECEIVED
APR 26 1979
WATER RESOURCES DEPT.
SALEM, OREGON

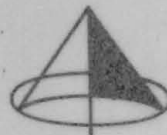

NORTH
4" = 1 mile

SQUAW CREEK CANAL

Design By	Drawn By N.O.	Checked By G.H.	Approv By	Survey By	Date 8-24-78	Scale 4" = 1 mi	Drawing No. 413-001 A9
-----------	------------------	--------------------	-----------	-----------	-----------------	--------------------	---------------------------

CENTURY WEST ENGINEERING CORPORATION

BEND,
OREGON