

T. 29 S., R. 5 W., W.M.

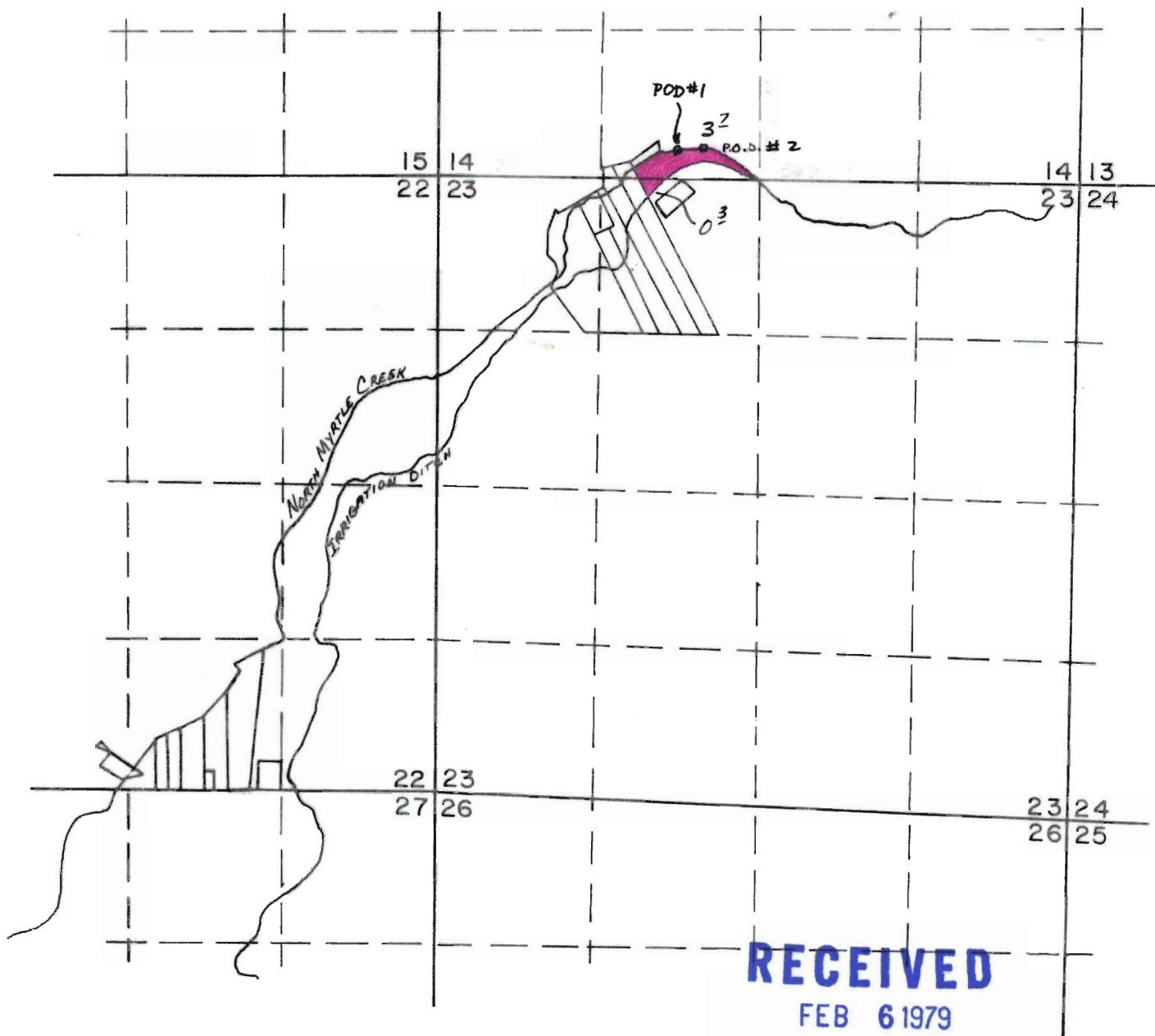

4<sup>0</sup> Acres

**RECEIVED**  
 FEB 6 1979  
 WATER RESOURCES DEPT.  
 SALEM, OREGON

Application No. .... Permit No. **4803**  
 IN NAME OF

Hubert J. or Ellen Johnson

North Myrtle Route Box 143  
 Myrtle Creek, Oregon 97457

#1 250' N and 2000' E From SW cor. Sec 14.

#2: 250' N and 2200' E FROM SW COR. SEC 14 IN SE 1/4 SW 1/4 SEC 14

COMMON COR  $\frac{15}{22}$   $\frac{14}{23}$