

T. 30 S., R. 5 W., W.M.

Sec. 27

NE 1/4 SW 1/4

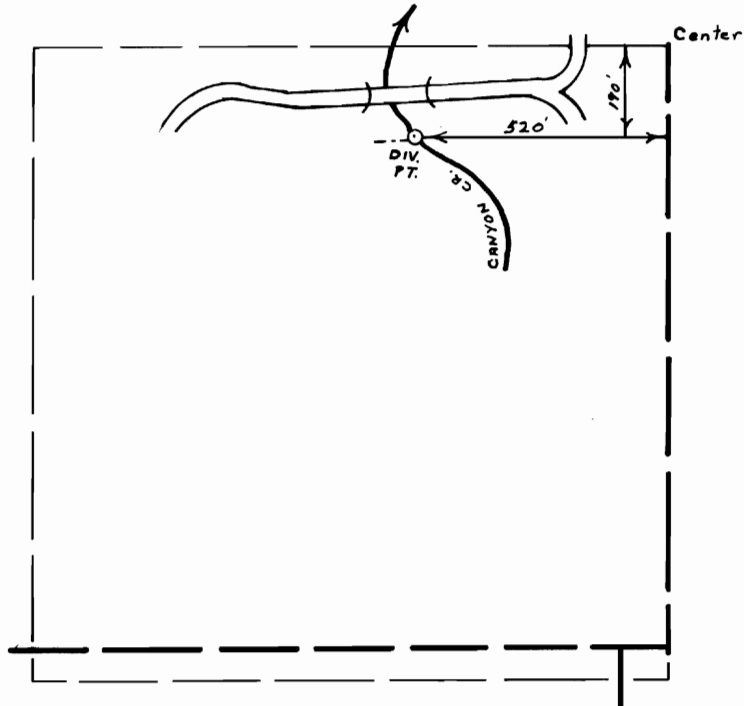

SCALE 1" = 400'

FINAL PROOF SURVEY
UNDER

Transfer no. 4162

Application No. Permit No.
IN NAME OF

..... JERRE & RUTH DEWALD

Surveyed Oct. 25, 1979, by S. Donaldson..