

T. 9S., R. 40E., W. M.

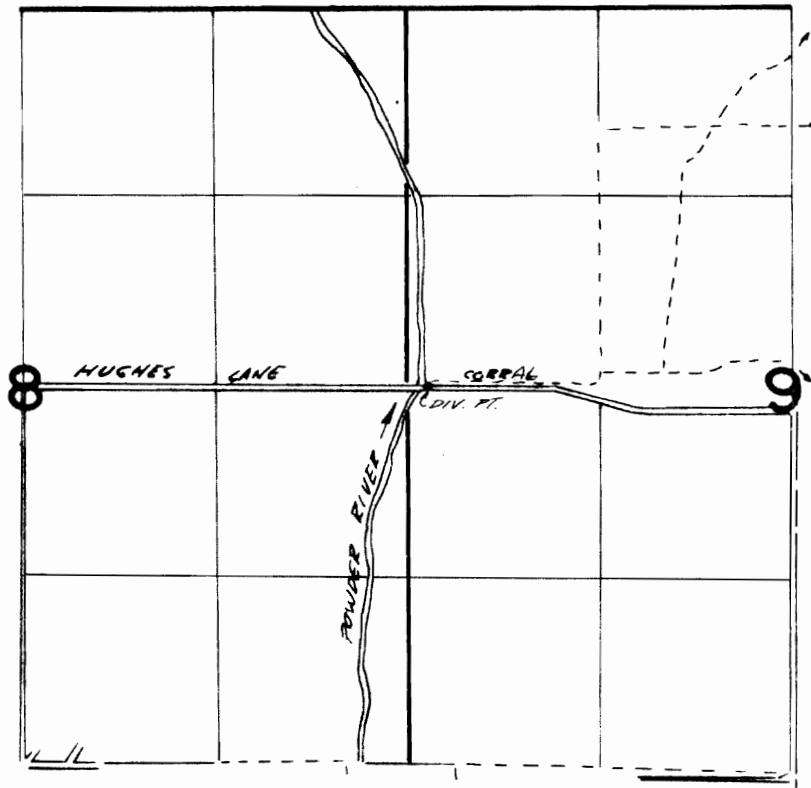

DIV. FT. LOCATED 50' N & 2720' E FROM CENTER SEC 8

FINAL PROOF SURVEY

UNDER

TRANSFER 4170

Application No. Permit No.

IN NAME OF

VERA ERWIN

Surveyed Aug. 5, 1981, by Vernon L. Church