

T. 30 S. R. 5 W. W.M.

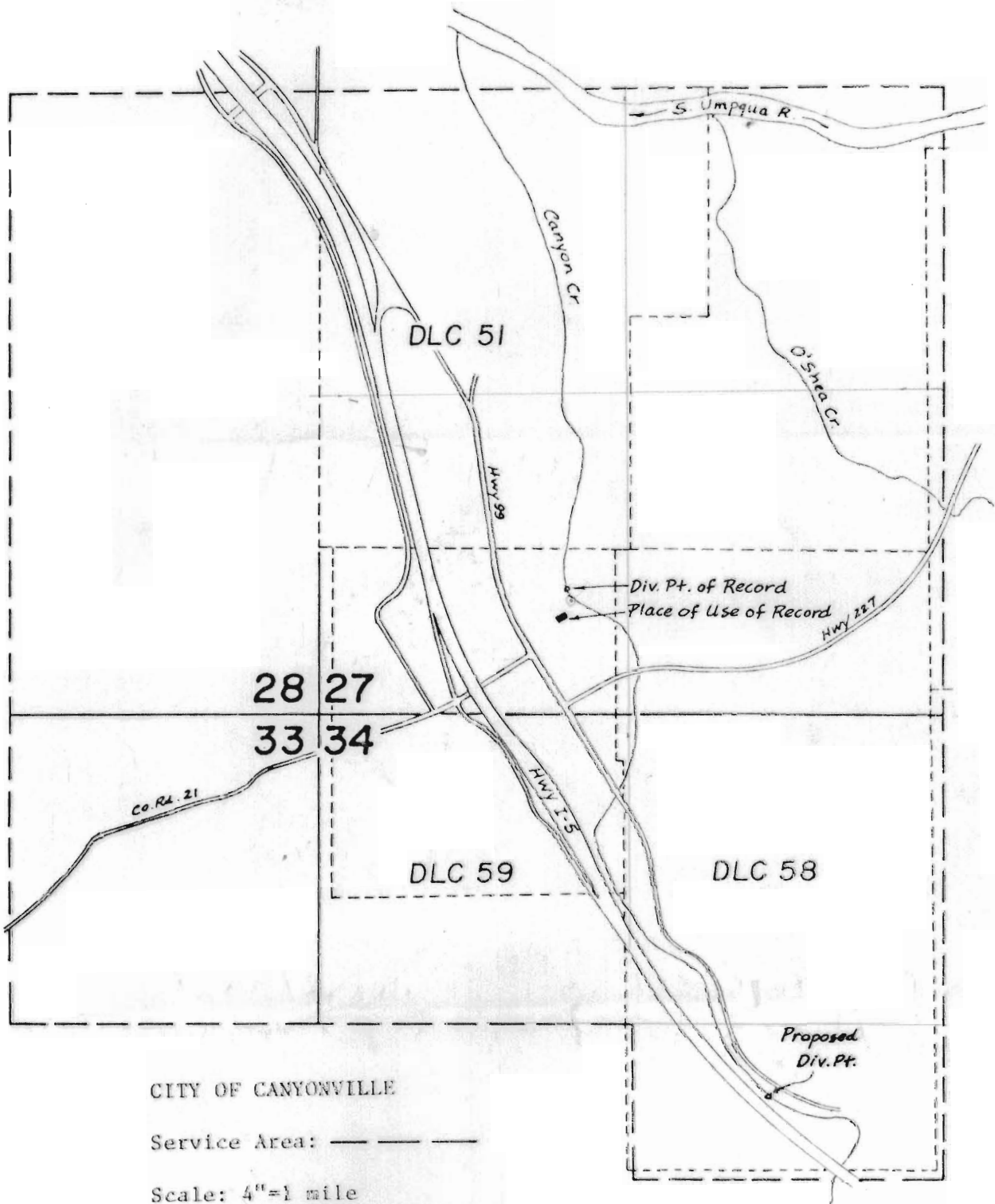

CITY OF CANYONVILLE

Service Area: ————

Scale: 4" = 1 mile

Proposed Div. Pt: 1754' S. and 1197' E. from the S.E. corner of D.L.C. No. 59

RECEIVED

APR 30 1979

WATER RESOURCES DEPT.
SALEM, OREGON

12160