

T.25S. R.6W. W.M.



RECEIVED

JAN 3 1980

WATER RESOURCES DEPT
SALEM, OREGON

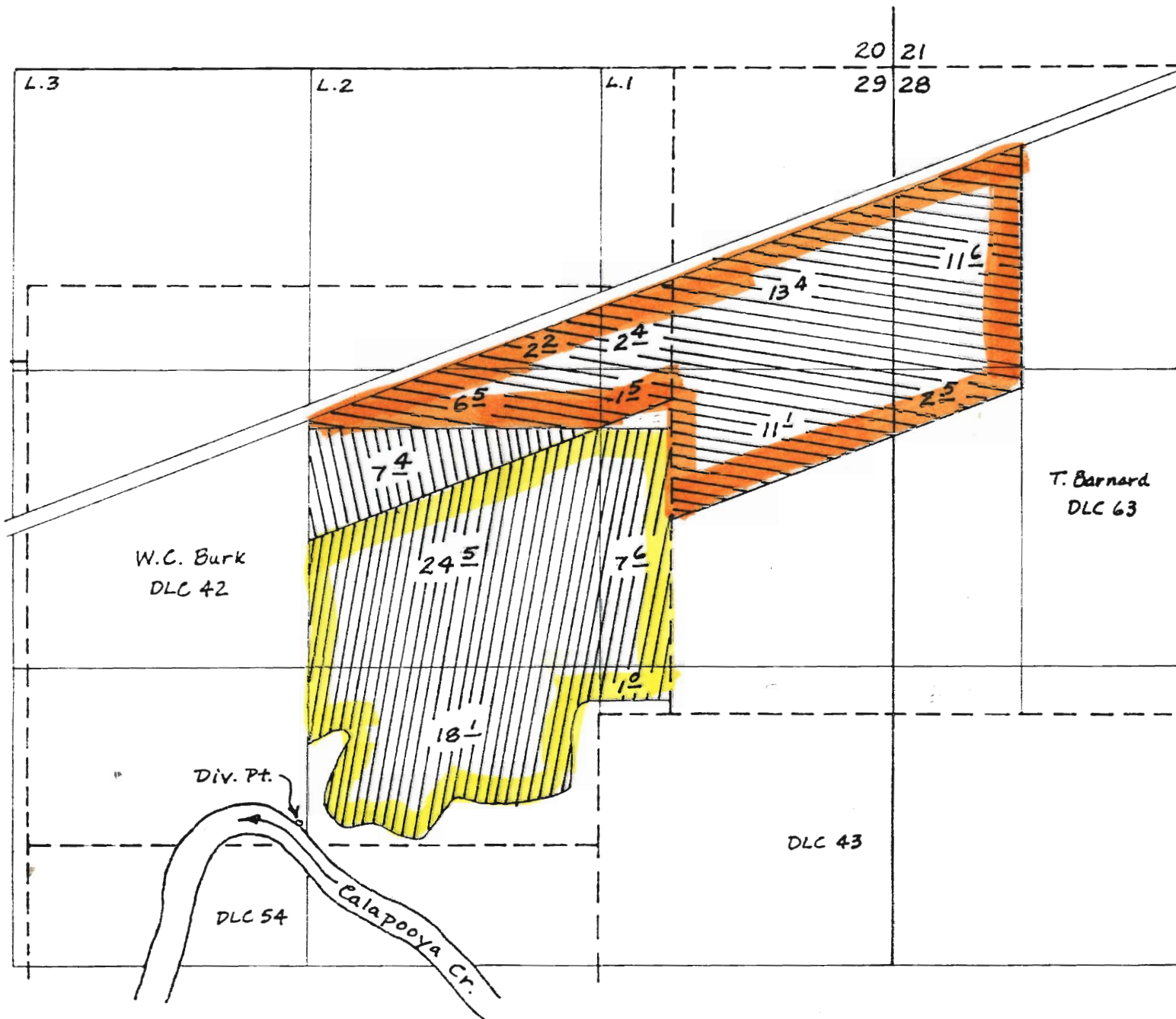
N



-  Transfer from
-  Transfer to
-  Unchanged

T. Barnard
DLC 63

W.C. Burk
DLC 42

DLC 43

Div. Pt.

DLC 54

Calapooya Cr.

Scale: 8" = 1 mile

Div. Pt. 110' N and
1220' E from SW cor.
DLC 42