

T-4530

RECEIVED

JUN 21 1980

WATER RESOURCES DEPT
SALEM, OREGON

T 9S R 45E W.M.
SECTION 3

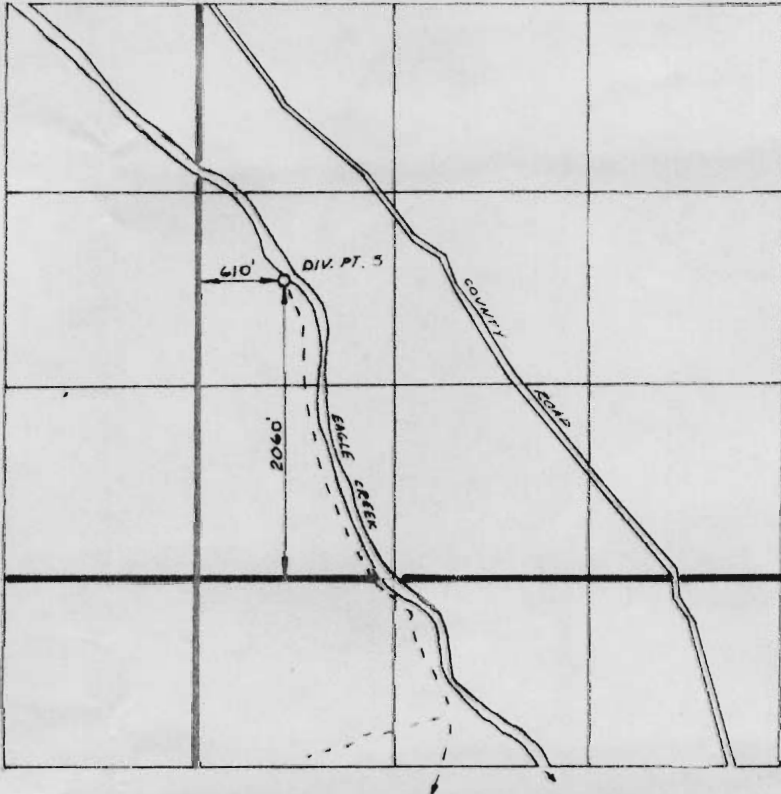

HOSTINE DITCH

T-4530

RECEIVED
JUN 21 1980
WATER RESOURCES DEPT
SALEM, OREGON

T 9S R 45E W.M.

