



10.28 AC. OFF
4" = 1 MILE APPROX

T-4572

RECEIVED
JUL 23 1980

WATER RESOURCES DEPT
SALEM, OREGON



45

378

356

378

365

332

343

388

394

379

342

388

326

300

238

288

207

390

328

16.72 ACRES OR
4 1/2 MILE APPROX

263

175

125

305

347

363

357

355

128

01

T-4572

317

320

388

292

RED M

325

380

340

362

248

MCKENZIE

17 HIGHWAY

14

16

245

349

327

221

272

253

373

95

345

344

323

280

284

132

380

24

338

357

332

247

204

282

209

22

209

302

350

324

330

239

26501 2/188059

WATER RESOURCES DEPT
OREGON

21

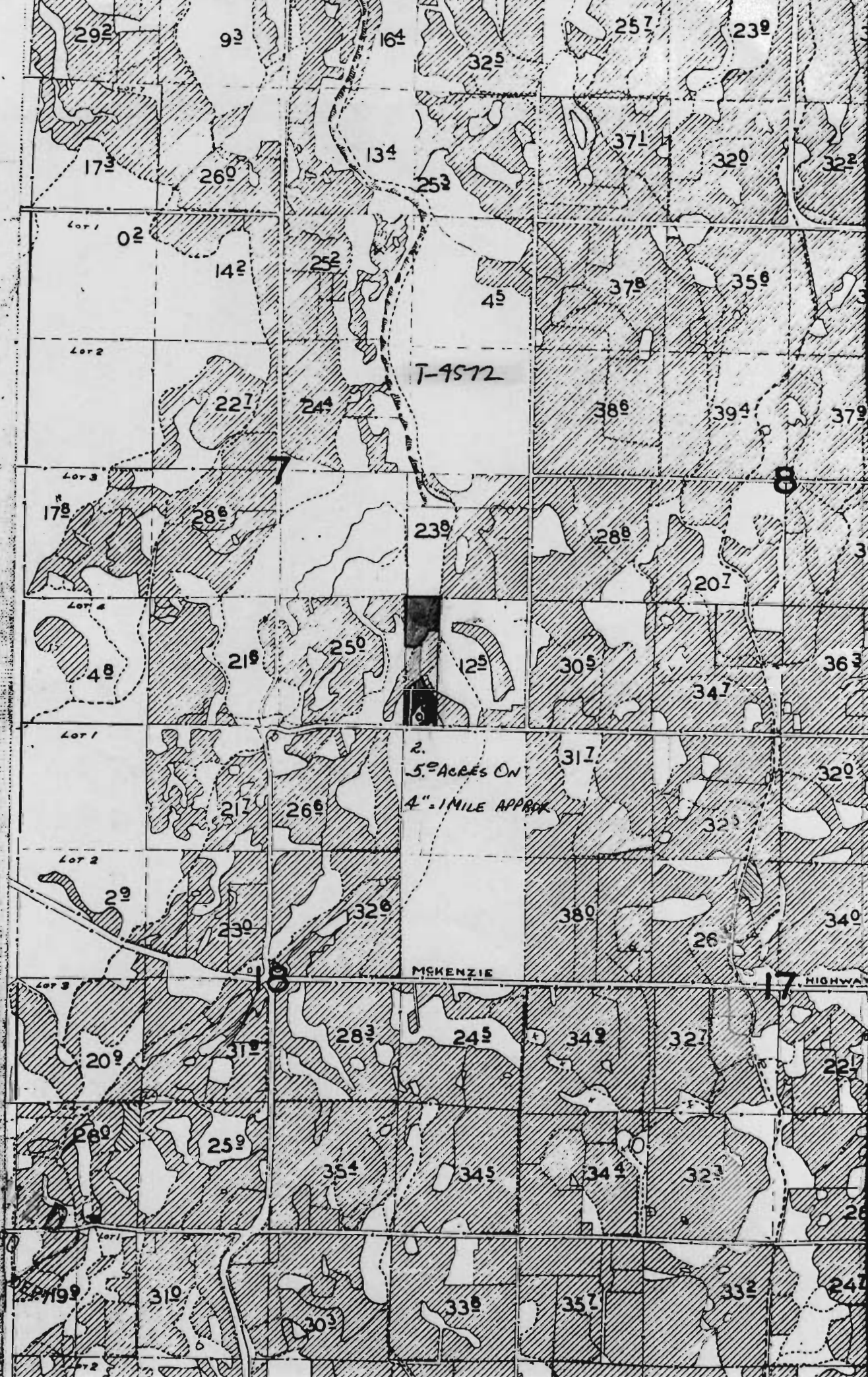

T-4572

2. 5. ACRES ON
4\"/>MILE APPROX

MCKENZIE

17 HIGHWAY

REC
JUL 1980
WATER RESOURCES
SALEM, O

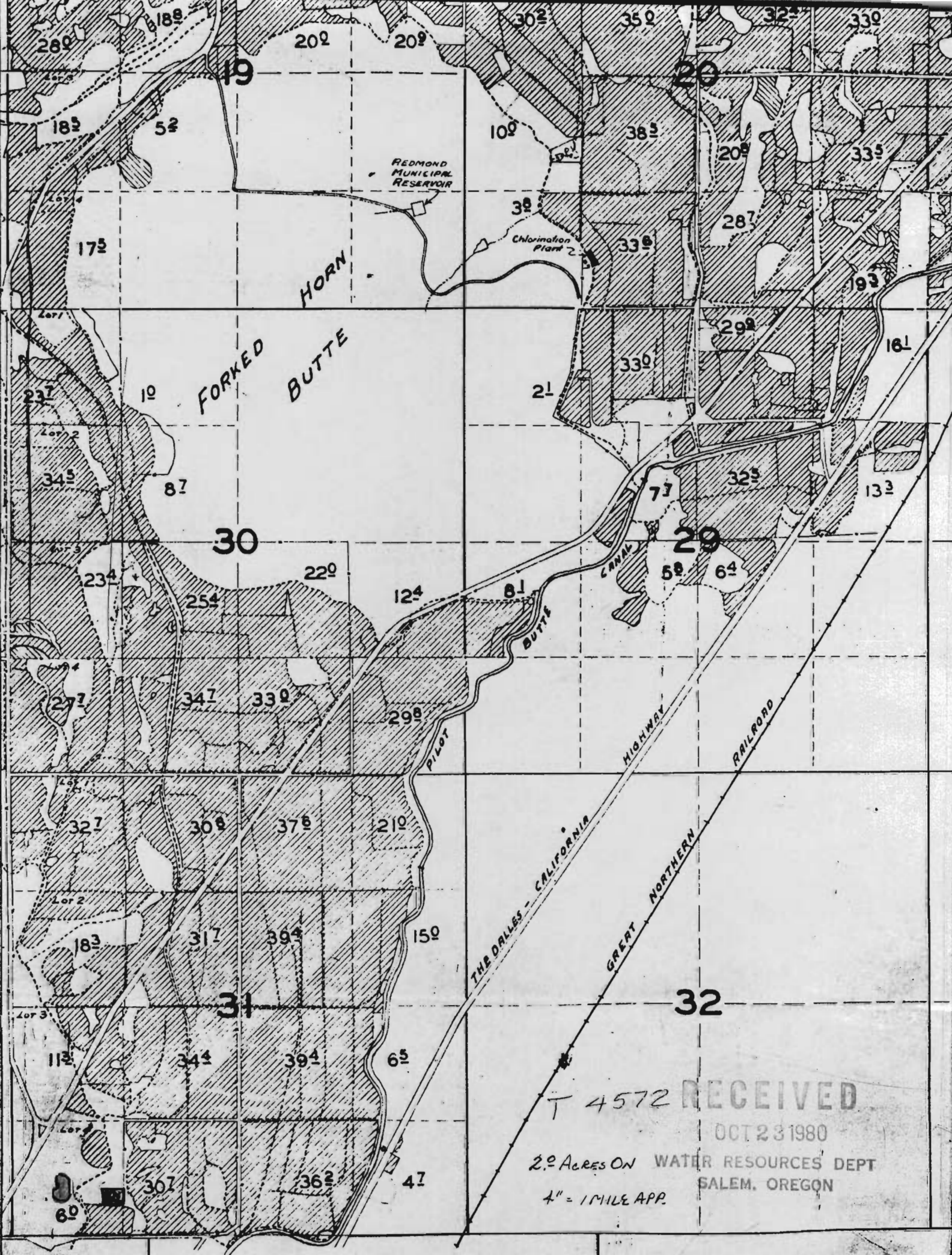

REDMOND MUNICIPAL RESERVOIR

Chlorination Plant 2

HORN
FORKED BUTTE

CANAL

PILLOT BUTTE

THE DAILES - COLUMBIA HIGHWAY
GREAT NORTHERN RAILROAD

T 4572 RECEIVED
OCT 23 1980
2.0 ACRES ON WATER RESOURCES DEPT
SALEM, OREGON
1" = 1 MILE APP.

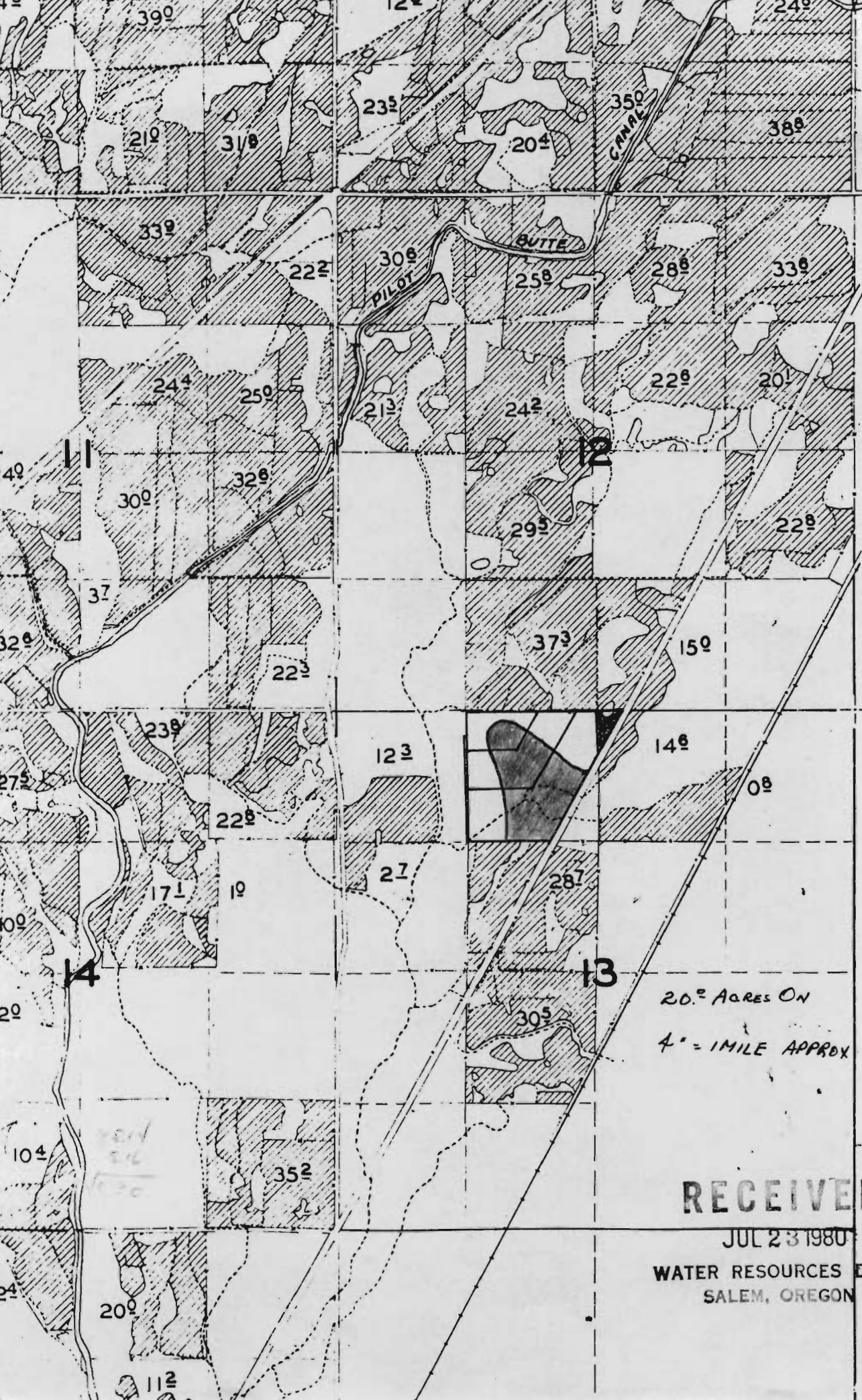

F4572

cloud

20" = ACRES ON
4" = 1 MILE APPROX

RECEIVED

JUL 23 1980

WATER RESOURCES DEPT
SALEM, OREGON